

Place "Road Closed to Thru Traffic" sign in winged position on each side of Yale Blvd, Harvard, Roosevelt and Gentry.

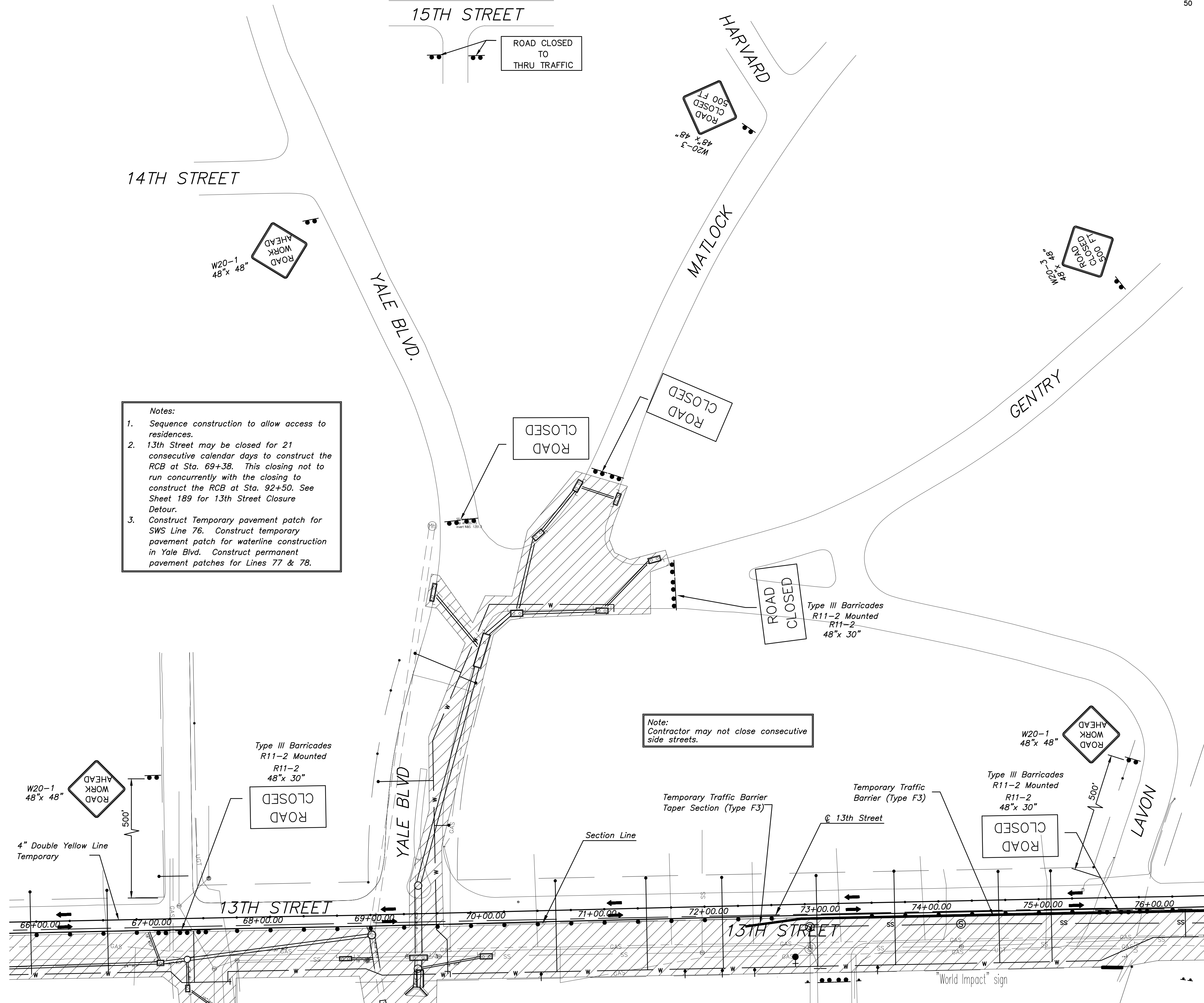
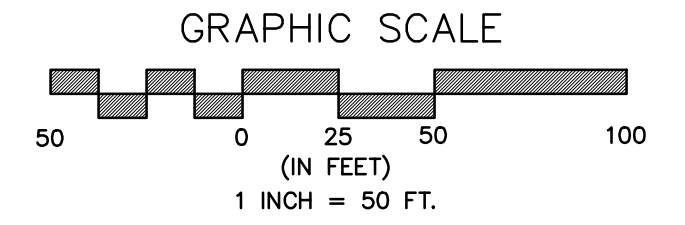

- Notes:**
1. Sequence construction to allow access to residences.
 2. 13th Street may be closed for 21 consecutive calendar days to construct the RCB at Sta. 69+38. This closing not to run concurrently with the closing to construct the RCB at Sta. 92+50. See Sheet 189 for 13th Street Closure Detour.
 3. Construct Temporary pavement patch for SWS Line 76. Construct temporary pavement patch for waterline construction in Yale Blvd. Construct permanent pavement patches for Lines 77 & 78.

Note: Contractor may not close consecutive side streets.

PHASE 1 - YALE BLVD./MATLOCK

Engineer:	P. FERGUSON
Designer:	P. FERGUSON
CITY Job No.:	472-84320
Date:	March, 2012

No.	Date	By	Approved	Revision

13TH STREET NORTH FROM KANSAS TO OLIVER
 TRAFFIC CONTROL - PHASE I
 CITY OF WICHITA, KANSAS

POE & ASSOCIATES, INC.
 CONSULTING ENGINEERS
 5940 E. Central, Suite 200 • Wichita, KS 67208-4242
 Phone 316/685-4114 • FAX 316/685-4444

Sheet 195 of 374