

13th Street at MacDonald Golf Course  
Landscape Plan — East

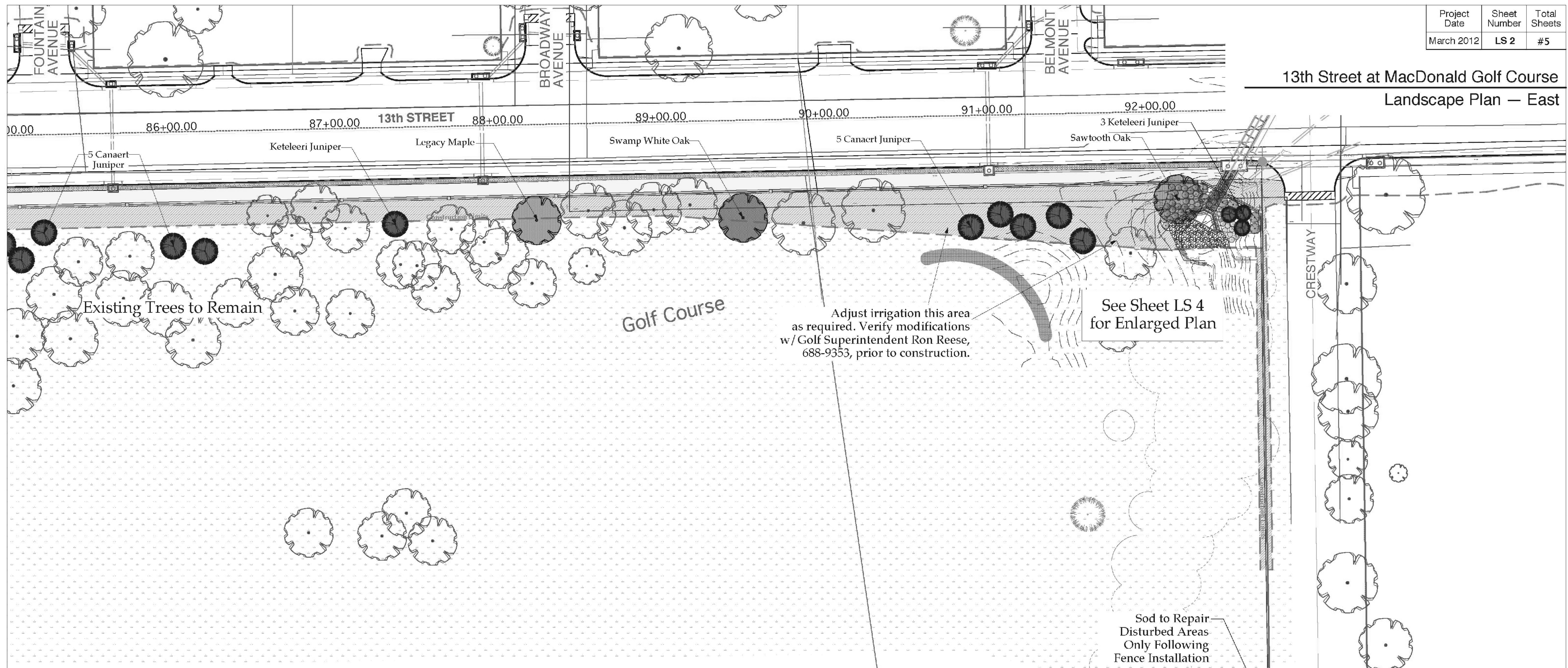

Plant Schedule				
Quantity	Common Name	Botanical Name	Size	Specification
<b>TREES</b>				
1	Legacy Sugar Maple	<i>Acer saccharum</i> 'Legacy'	2 1/2"-3" Cal	B&B
4	Keteleeri Juniper	<i>Juniperus chinensis</i> 'Keteleeri'	7'-8' height	B&B
10	Canaert Juniper	<i>Juniperus virginiana</i> 'Canaertii'	7'-8' height	B&B
2	Sawtooth Oak	<i>Quercus acutissima</i>	2 1/2"-3" Cal	B&B
3	Swamp White Oak	<i>Quercus bicolor</i>	2 1/2"-3" Cal	B&B
20	<b>Total Trees</b>			
<b>SHRUBS</b>				
2	Compact Andorra Juniper	<i>Juniperus horizontalis</i> 'Compact Andorra'	5 gallon	Container
7	Sea Green Juniper	<i>Juniperus chinensis</i> 'Sea Green'	5 gallon	Container
20	Gro-low Sumac	<i>Rhus aromatica</i> 'Gro-low'	2 gallon	Container
21	Hancock Coralberry	<i>Symphoricarpos orbiculatus</i> 'Hancock'	2 gallon	Container
50	<b>Total Shrubs</b>			
6	Karl Foerster Feather Reed Grass	<i>Calamagrostis acutiflora stricta</i> 'Karl Foerster'	1 gallon	Container
6	<b>Total Ornamental Grasses</b>			

Note: In case of a discrepancy between the Plant Schedule and the Plans, the Plans shall govern.

**KEY**

- approximate mature crown diameter of existing deciduous tree
- approximate mature crown diameter of existing coniferous tree
- Existing Deciduous Tree
- Existing Evergreen Tree
- right-of-way
- construction limits
- Sidewalk
- Bermudagrass Sod
- Existing Turf to Remain

Sod to Repair Disturbed Areas Only Following Fence Installation

Approximate End of Iron Fencing (400 LF) S. of R.O.W. Terminate w/ post adjacent to post of existing fence as approved by Owner.

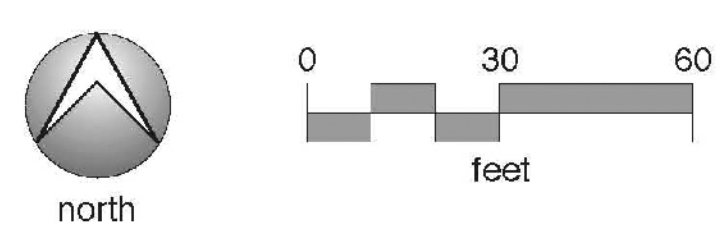

**POE & ASSOCIATES OF KANSAS, INC.**  
CONSULTING ENGINEERS  
5940 E. Central, Suite 200 ■ Wichita, KS 67208-4242  
Phone 316/685-4114 ■ FAX 316/685-4444

**LANDSCAPE ARCHITECTS PLANNERS**  
**rice-foster associates**  
1415 East 2nd Street  
Wichita, KS 67214  
phone 316-262-4525  
fax 316-262-7316

File Created: Mar. 30th, 2012  
Project: 0808