

2012 Sanitary Sewer Rehabilitation
Phase A

OCA 620598 / 468-84832

Central Ave.

Douglas Ave.

Broadway

Hydraulic

Project
Location

I-135 Hwy.

N

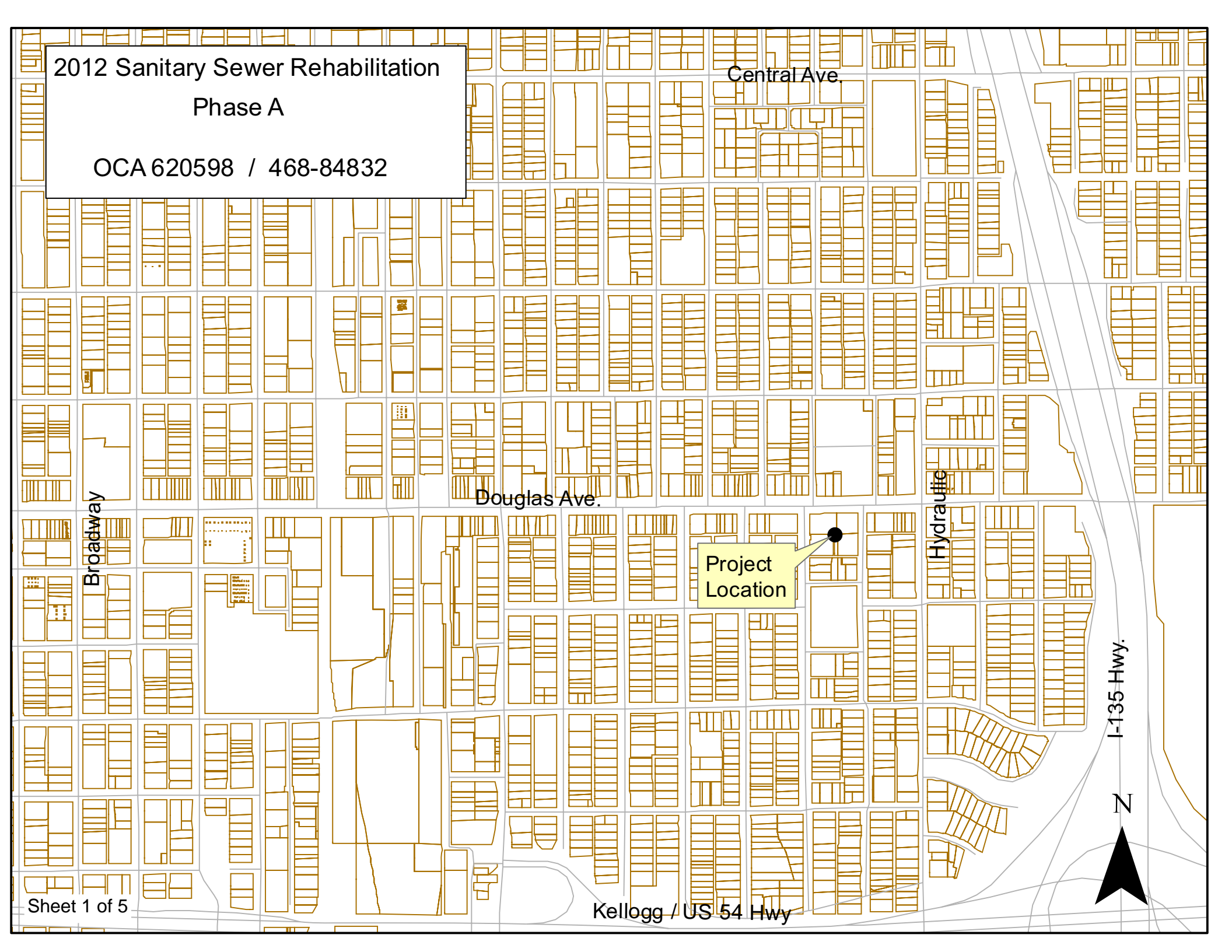

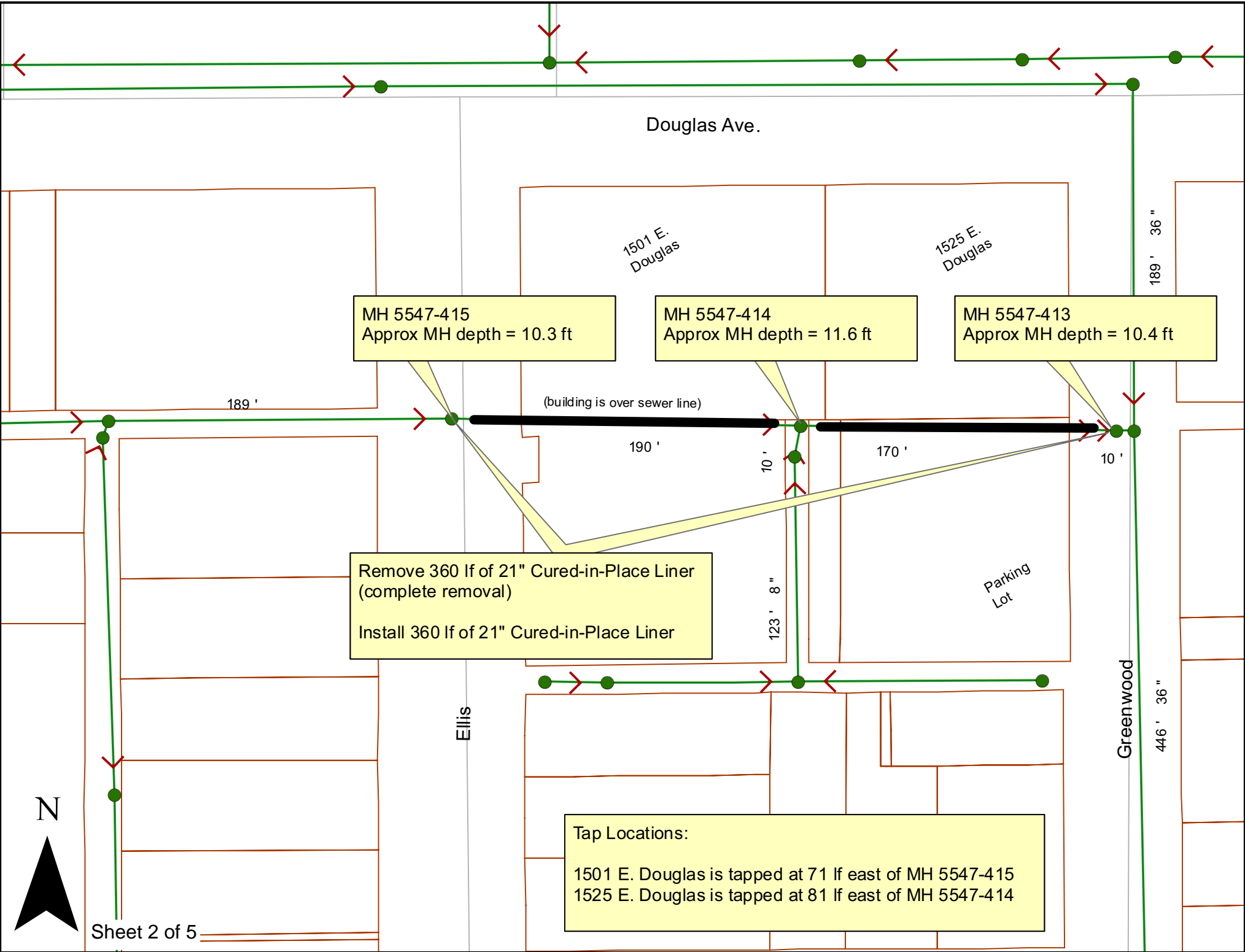

MH 5547-415
Approx MH depth = 10.3 ft

MH 5547-414
Approx MH depth = 11.6 ft

MH 5547-413
Approx MH depth = 10.4 ft

Remove 360 lf of 21" Cured-in-Place Liner
(complete removal)
Install 360 lf of 21" Cured-in-Place Liner

Tap Locations:
1501 E. Douglas is tapped at 71 lf east of MH 5547-415
1525 E. Douglas is tapped at 81 lf east of MH 5547-414

E DOUGLAS AVE

1501 E.
Douglas

1525 E.
Douglas

S ELLIS AVE

S GREENWOOD AVE

E HYDE PARK

N



GENERAL NOTES

McCormick-Anderson at 1501 E. Douglas discharges a high volume of cold water into the sanitary sewer and their tap on the main is located under the building. During CIPP installation, it will be imperative to coordinate with the company to control cold water discharge. Contact Doug Tomkins, Vice President of Operations:

Main Office: 316-264-1363

Direct Line: 316-206-1206

Cell Phone: 316-308-6752

McCormick-Anderson operational hours are 24 hrs a day, Monday through Friday. They also work some weekends when necessary. Mr. Tomkins said given 2-3 weeks of advanced notice, they can shut off all cold water cooling discharge for the entire weekend and if their current workload will allow, they can maybe do a Friday prior or Monday after a given weekend of no cooling discharge.

The existing CIPP installation left large material folds/bumps in the flow line, at various places throughout the pipe. The contractor that installed the CIPP made an attempt to cut out the material in the flow line but did not finish the job. Videos of the pipe are available on the City of Wichita's FTP site. See instructions on the next page to access the videos.

Video for 5547-415 to 5547-414: The camera goes through once without a cleaner and you cannot see below the water level. Then the camera goes through a second time using a cleaner, and you can see that the crease has been removed from the flow line within the upstream 70 lf, but the cleaner hung up on the void in the flow line and could not be used beyond that point.

Video for 5547-414 to 5547-413: Again the camera starts through without a cleaner, but there is video using cleaner from 119 feet, to the downstream manhole. The material crease is the largest just outside of MH 5547-413.

The flow on the 21" pipe is not a large volume, as shown on the video.

All existing CIPP shall be removed from the pipe. Disposal of the existing CIPP shall be the responsibility of the contractor and shall be subsidiary to the CIPP pipe removal bid item. An inspection video shall be submitted to the Field Engineer for proof of existing liner removal before payment of liner removal can be made, and before new CIPP liner can be installed.

To access the videos from the City's FTP site:

End User FTP Server Instructions

Below are 3 ways to access your the FTP server that has been created for you.

1.) You can connect using Internet Explorer via the link below:

[ftp://ssbid7:ss747\\$@Files3.cyberlynk.net](ftp://ssbid7:ss747$@Files3.cyberlynk.net)

This will allow for dragging/dropping capabilities on any windows machine.

2.) You can also connect to the FTP server using any standard FTP Client such as FTPVoyager, WSFTP, or CuteFTP. To connect using your FTP Client use the settings below.

FTP Host: Files3.cyberlynk.net
Username: ssbid7
Password: ss747\$

If you do not have an FTP client you can purchase or download a FREE trial copy via the link below:

<http://www.ftpcientlisting.com>

3.) You can also use the Web Based JAVA FTP Client from any Windows computer:

<http://Files3.cyberlynk.net/client>

Username: ssbid7
Password: ss747\$

If you have any questions or problems, please feel free to contact Andrew Smith, asmith@wichita.gov.