

- Notes:**
- Refer to note 10 under "General Notes" on cover sheet for any cuts made to pavement inside of city right-of-way.
 - Northing coordinates have a 170xxxx.xx prefix, and Easting have a 167xxxx.xx prefix. Project is oriented using coordinates gathered from the city's broadcasting system on 07/02/2012.

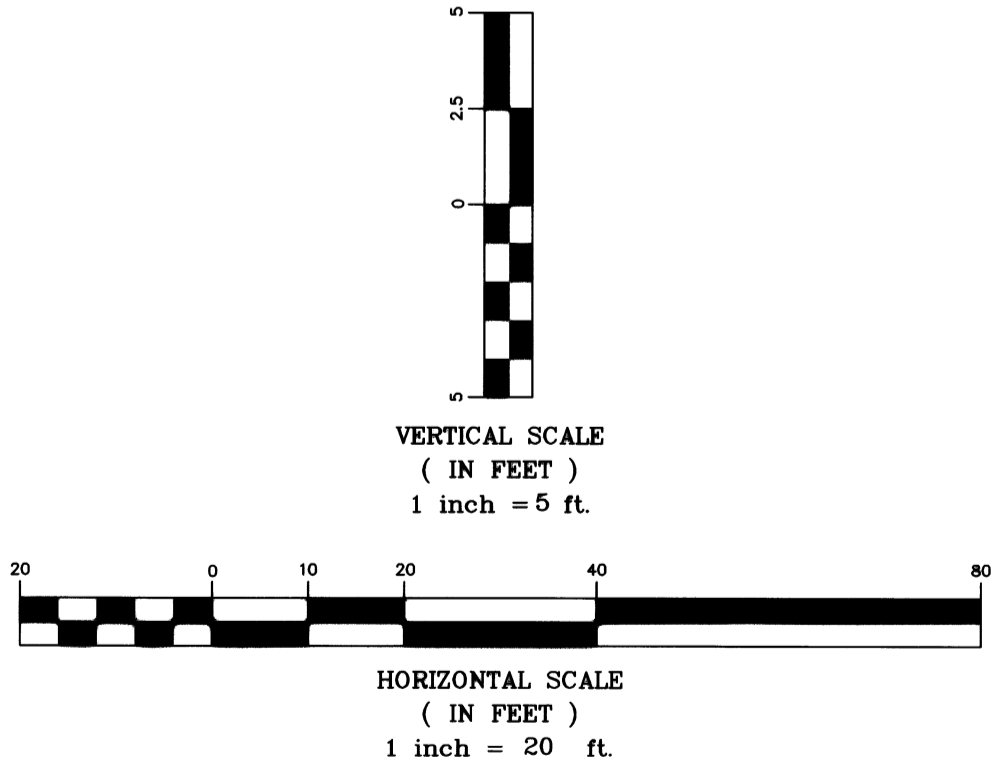

Lot 1, Block 2, Killarny West Residential Addition
Water Line
Wichita, Kansas

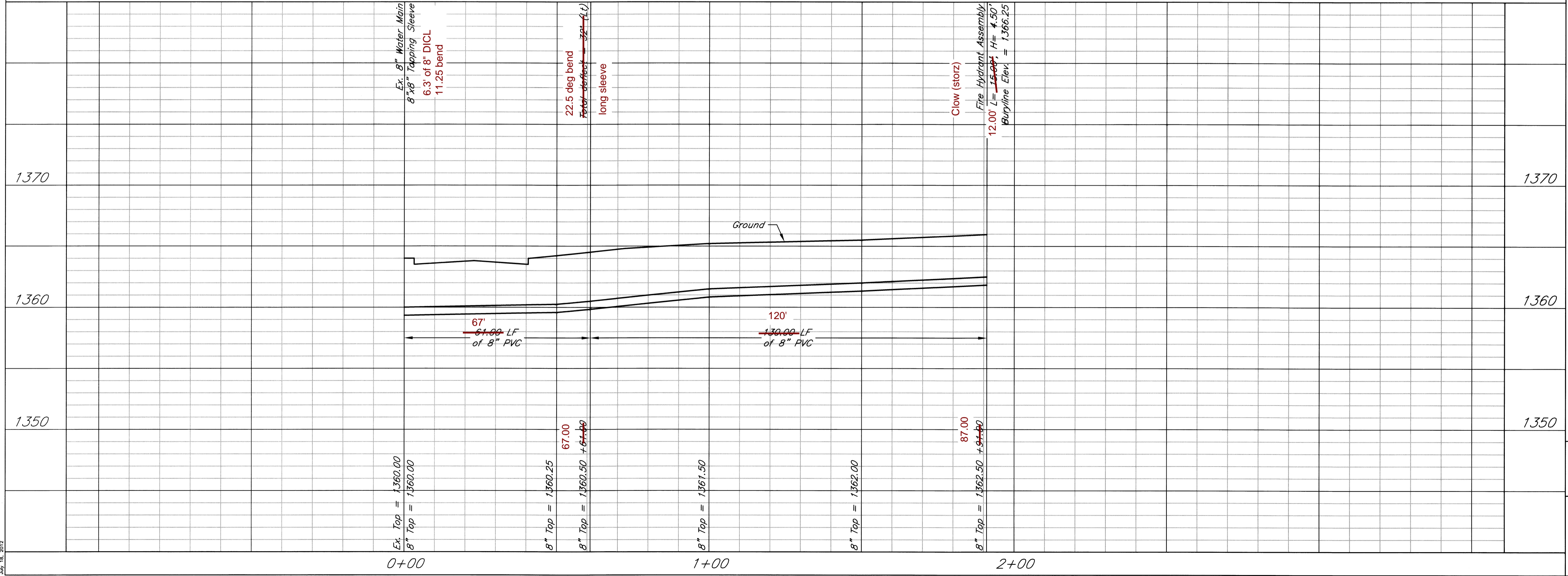

PROJECT NUMBER			
KEM NO. 12089	FILE	DATE 07/18/12	SHEET 2.0
DESIGN KM	DRAWN NS	REVISED	

04.18.2012