

FHWA REGION NO.	STATE	PROJECT NUMBER	FISCAL YEAR	SHEET NUMBER	TOTAL SHEETS
7	KANSAS	87N-0493-01	2012	23	59

HSPJ Proj. No. N049 (301)

# BENCOR 3RD ADDITION

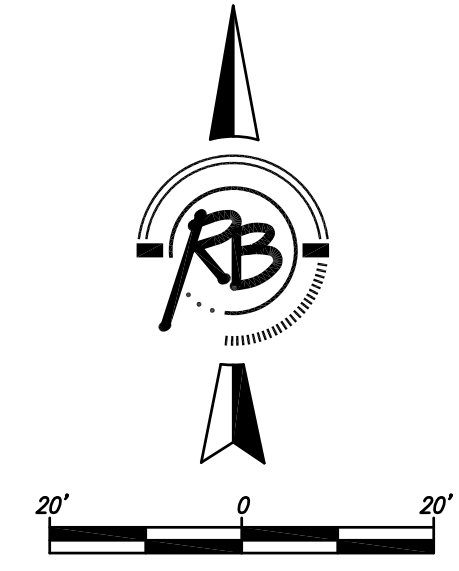
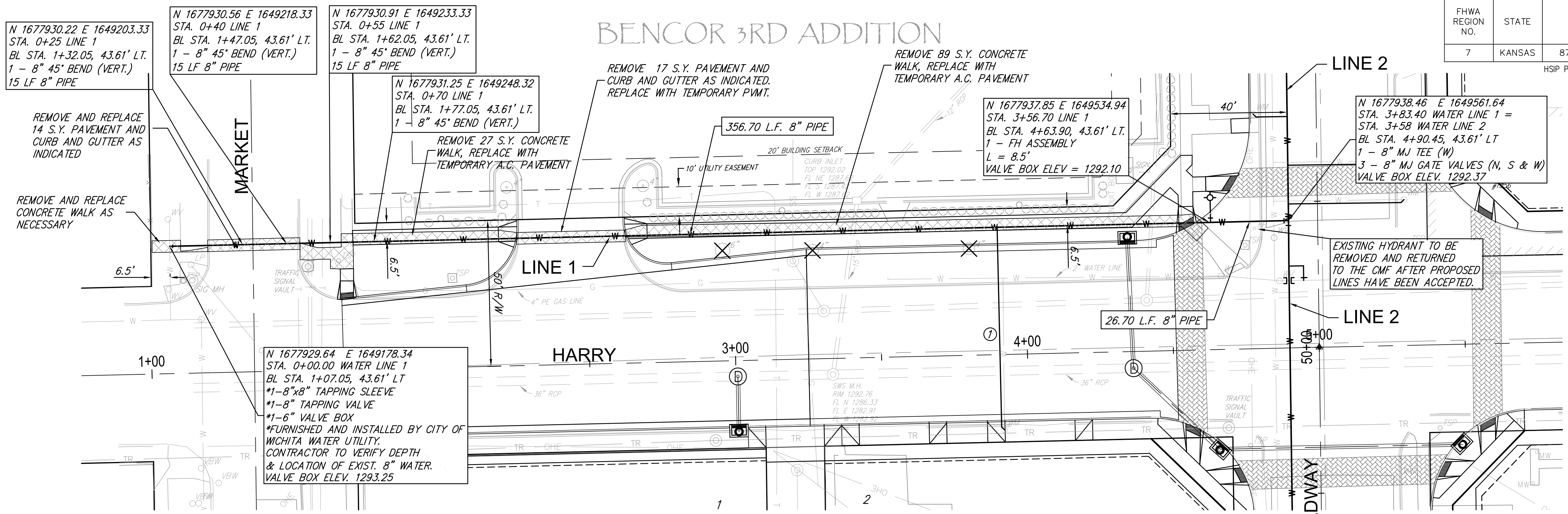

**WATER SERVICE TABLE**

SERVICE #	LINE #	STATION	APPROXIMATE LENGTH
①	LINE 1	2+83.54	70 LF

Concrete to be removed and replaced with Temporary A.C.

NOTES:  
\* THESE ITEMS TO BE FURNISHED AND INSTALLED BY THE DEPT. OF WATER AND SEWER.

NOTE:  
REPLACE ALL SERVICE LINES COMPLETELY.

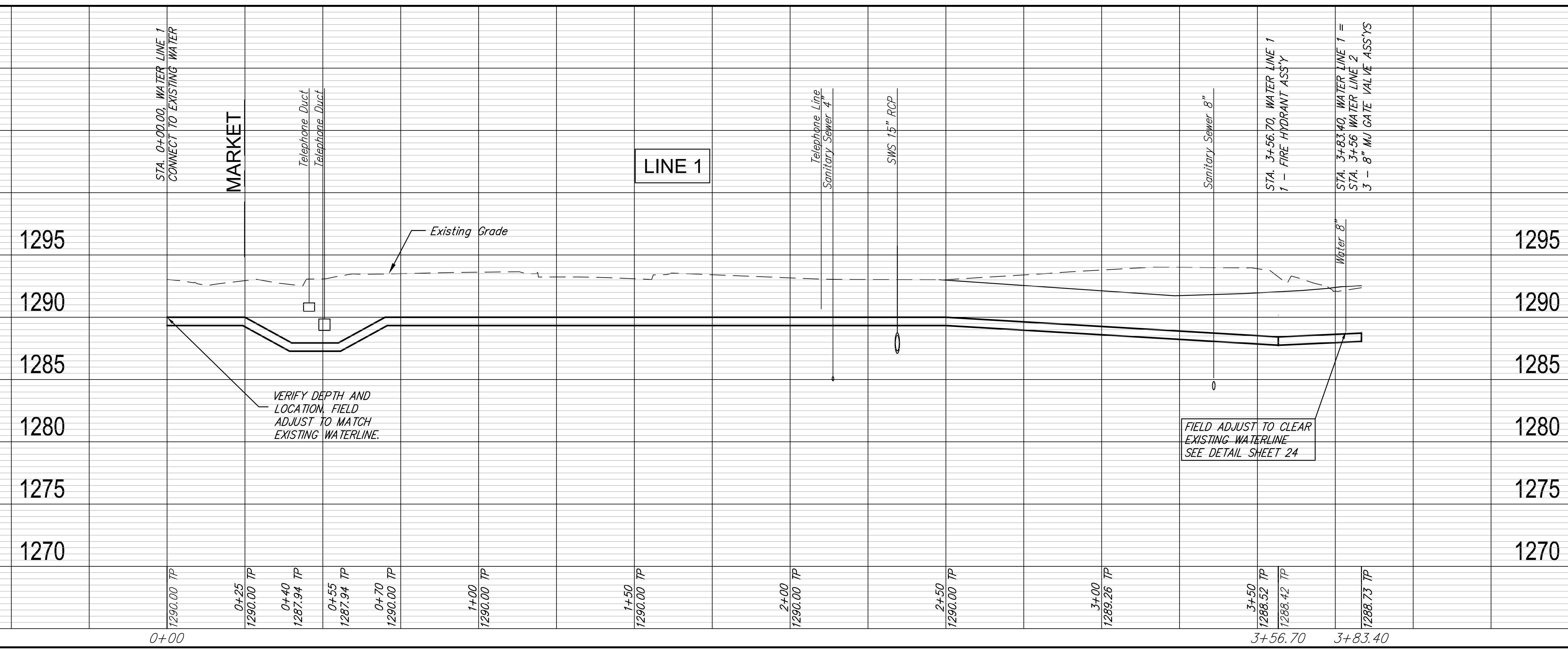

FIELD ADJUST TO CLEAR EXISTING WATERLINE SEE DETAIL SHEET 24

Ruggles & Dohm, P.A.  
Engineering, Surveying, Land Planning  
222 North Main  
Wichita, Kansas 67203  
www.ruggles.com



DESIGN ..  
DRAWN ..  
DATE ..  
UTILITY ..  
May 23, 2012

PROJECT NUMBER ..  
DRAWING FILE ..

PAVING IMPROVEMENTS  
WATER LINE 1  
WICHITA, KANSAS

RB JOB  
3576T  
SHEET  
23  
OF  
59