

FHWA REGION NO.	STATE	PROJECT NUMBER	FISCAL YEAR	SHEET NUMBER	TOTAL SHEETS
7	KANSAS	87N-0493-01	2012	53	59

HSP Proj. No. N049 (301)

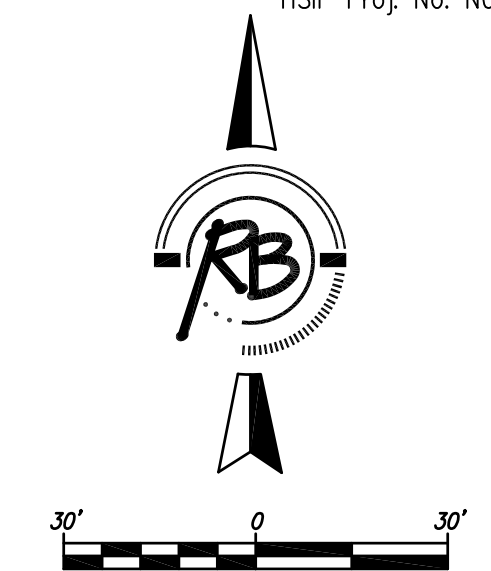
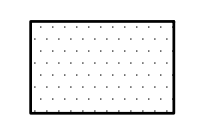

LEGEND

 AREAS TO BE SODDED
Per Notes on Sheet 126 and
City of Wichita Specifications Section 900

TOTAL AREA= 580 SY
(FOR INFORMATION ONLY)

PLANT SCHEDULE

Qty.	Scientific Name	Common Name	Size	Condition	Spacing	Remarks
SHADE TREES						
1	<i>Ulmus parvifolia</i> 'Allee'	Allee Lacebark Elm	2"	B&B	As shown	Full & Healthy
6	<i>Zelkova serrata</i> 'Musashino'	Musashino Zelkova	2"	B&B	As shown	Full & Healthy
ORNAMENTAL TREES						
10	<i>Pyrus calleryana</i> 'Cleveland Select'	Chanticleer Pear	1"	B&B	As shown	Full & Healthy

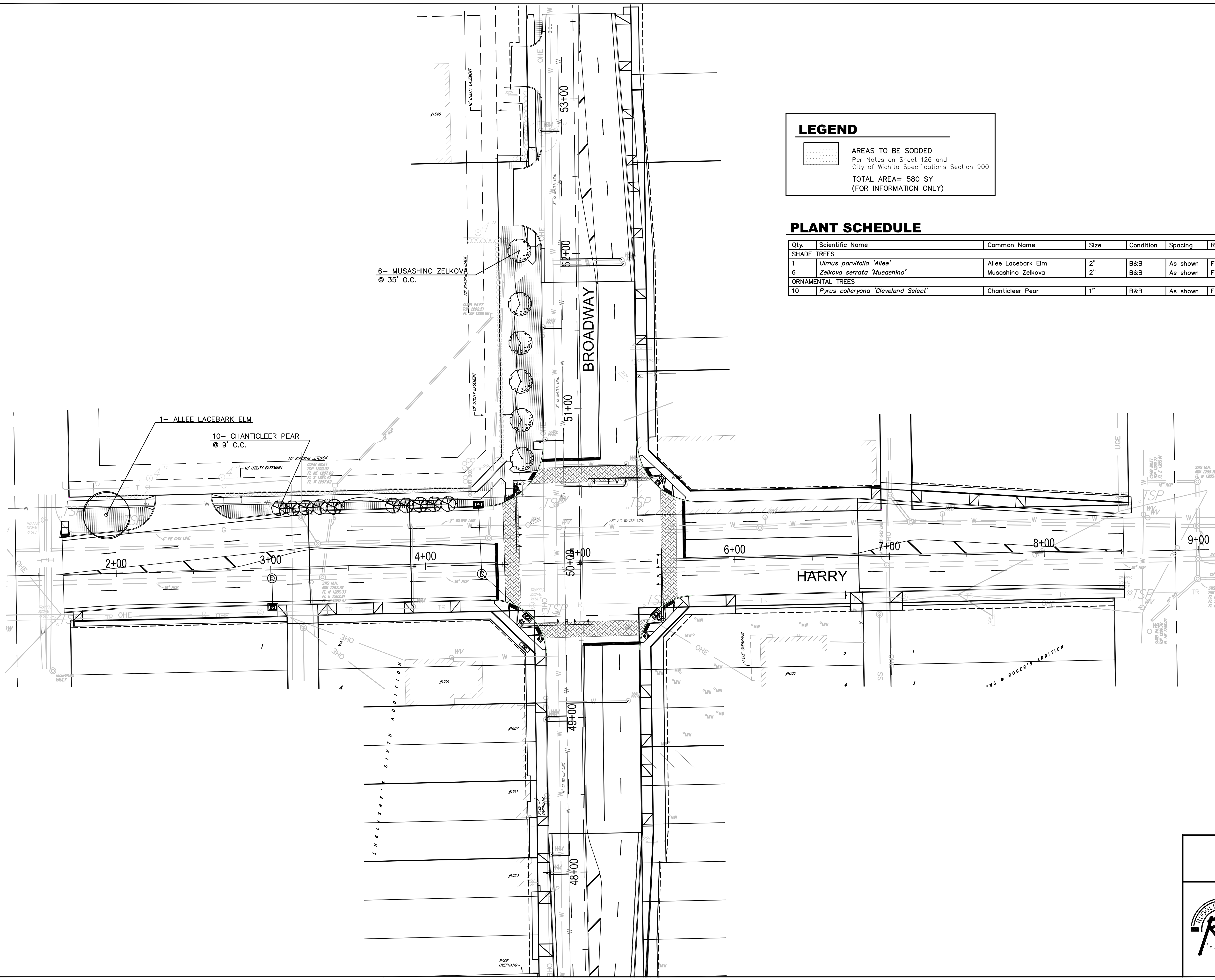

**HARRY AND BROADWAY IMPROVEMENTS
LANDSCAPE AND SOD PLAN
WICHITA, KANSAS**



Ruggles & Bohm, P.A.
Engineering, Surveying, Land Planning

924 North Main
Wichita, Kansas 67203
www.rbkansas.com

(316) 264-8008
(316) 264-4621 fax
E-mail: info@rbkansas.com

DESIGN BDT
DRAWN
REVIEW
UTILITY

PROJECT NUMBER
DATE
Apr. 16, 2012

SHEET
53
OF
59

DRAWING FILE: LANDSCAPE BASE (LSCAPE)