

**CARGILL PREP EXPANSION
PRIVATE PROJECT 1531PPW
OCA NO. 607853**

**APPROVED AS NOTED
BY CITY ENGINEER OF WICHITA,
BY WICHITA WATER & SEWER DEPARTMENT
& BY WICHITA FIRE DEPARTMENT**

Water Mains
(Public Works)

Water Mains
(Water & Sewer Dept.)

Fire Prot. Line
(Fire Dept.)

NOTE TO CONTRACTORS

Public Property:

Inspection and testing for the waterline is to be provided by a Licensed Consulting Engineering Firm under contract with the Owner/Developer. Said inspection to be in accordance with the City of Wichita Standard Construction Engineering Practices and certified by a Professional Engineer licensed in the state of Kansas. No work shall be performed in dedicated easements or public rights-of-way by the Contractor without such inspection, nor shall any work be commenced without written authorization by the City Engineer. All construction and materials shall comply with the City of Wichita Specifications and Standards (on file and available in the City Engineer's Office).

Private Property:

Installation and testing for the fire protection line is to be performed by a City of Wichita Licensed Fire Protection Contractor in accordance with the fire codes as adopted by the City of Wichita. All materials and construction practices for the fire protection line shall comply with the fire codes as adopted by the City of Wichita (available from the City of Wichita Fire Department). The Contractor shall not commence work without notification to and approval of the Wichita Fire Department. Inspection of the fire protection line is to be provided by a licensed engineering firm under contract with the Owner/Developer and the Fire Department. The contractor shall not start work until the project inspector is assigned to the project and present on the site. Any work done without inspection will be required to be uncovered for inspection.

NOTES

- CONTRACTOR TO VERIFY DEPTH & LOCATION OF EXISTING UTILITIES AND 8" WATER LINE PRIOR TO CONSTRUCTION.
- ALL LINES TO BE INSTALLED BY OTHERS ARE SUBJECT TO O.C.I. REVIEW.
- PAVEMENT REMOVAL MAY BE REQUIRED TO ACCOMMODATE WATERLINE OR FIRE HYDRANT INSTALLATION. PAVEMENT TO BE SAWCUT ITS ENTIRE DEPTH PRIOR TO REMOVAL. PAVEMENT AND ANY SUBGRADE REMOVAL SHALL BE REPLACED IN KIND SO AS TO MATCH EXISTING INSTALLATION.
- IN THE CASE OF CONCRETE PAVEMENT REMOVAL, MATCH JOINT PATTERN OF EXISTING PAVEMENT. JOINTS SHALL BE SEALED AS PER DETAILS ON THIS SHEET. ALSO, NEW TO EXISTING CONCRETE JOINTS ARE TO BE AS PER DETAILS THIS SHEET.

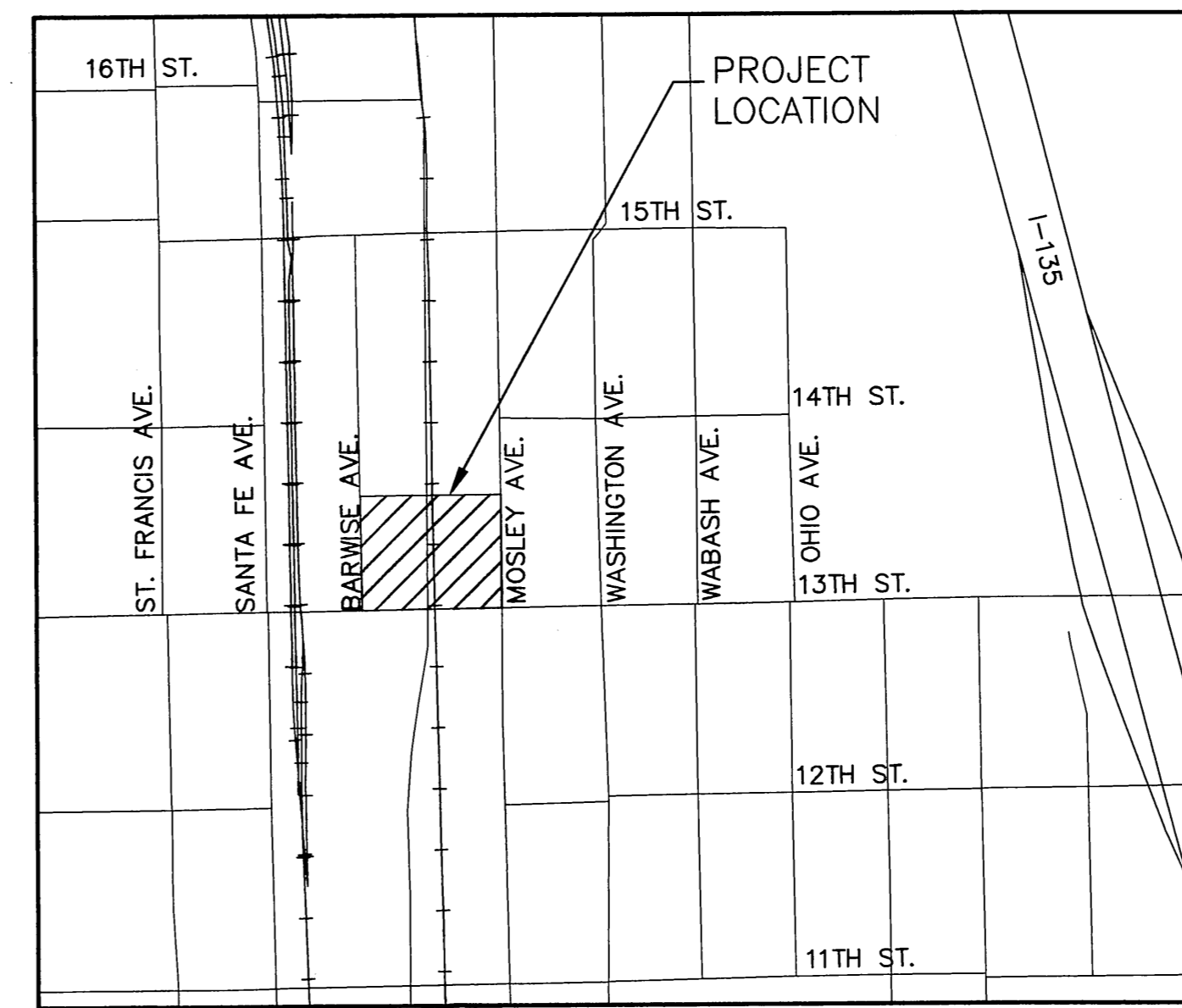

VICINITY MAP

LEGEND

- = CONCRETE REMOVAL & REPLACEMENT
- = PROPOSED WATER
- = EXISTING WATER
- = EXISTING SANITARY SEWER
- = EXISTING GAS

BENCHMARKS

BM#1
CHISELED SQUARE ON EAST EDGE OF CONC. PAVING OF BARWISE, 246' S OF CL OF 15TH ST. N & 15' E OF CL OF BARWISE. ELEV.=116.78

THRUST AT VALVES

VALVE	THRUST AT 150 #/in ²
4"	1809 lbs.
6"	4245 lbs.
8"	7540 lbs.
12"	16965 lbs.

MATERIALS LIST

- 1-8"x8" TAPPING SLEEVE & VALVE (AS PER PLAN)
- 1-CIMJ CAP WHEN NECESSARY
- 3-45° BENDS
- 108.55' OF PIPE (BID WITH PIPE)

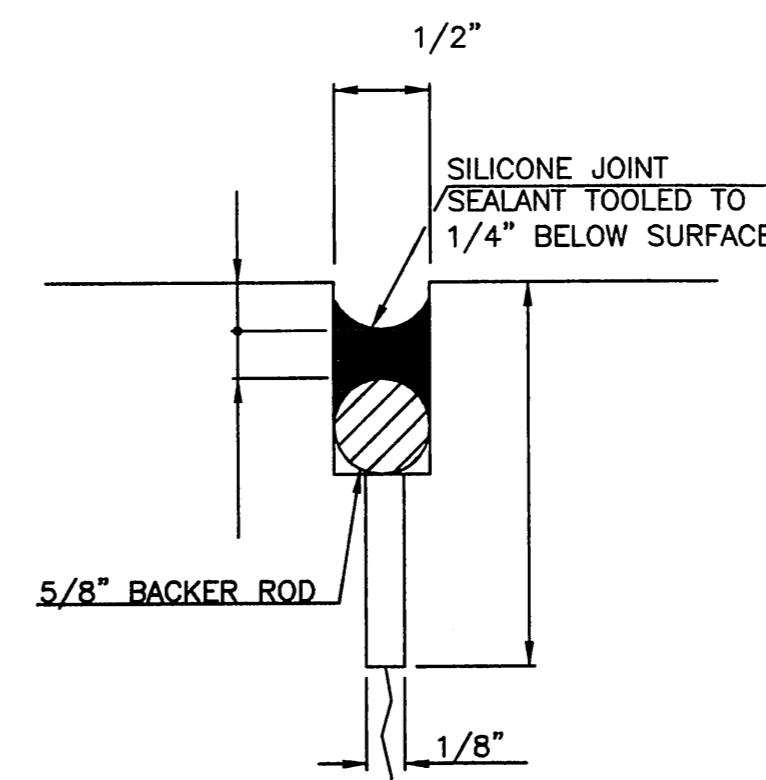
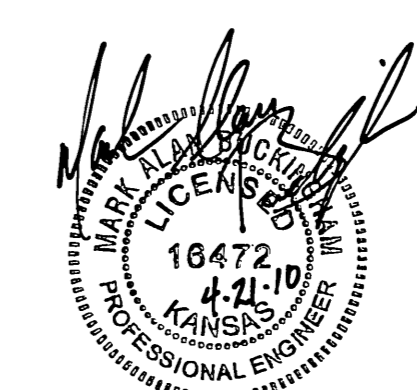

**DETAIL 2
DOUBLE SAWCUT METHOD**
SCALE: NONE

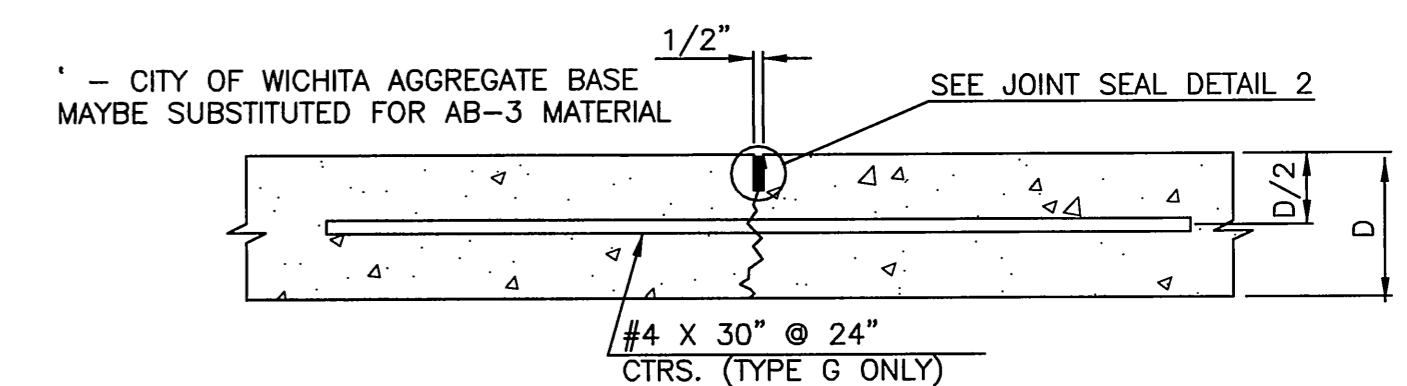

**TYPE G (TIED)
TYPE GU (UNTIED)**
SCALE: NONE

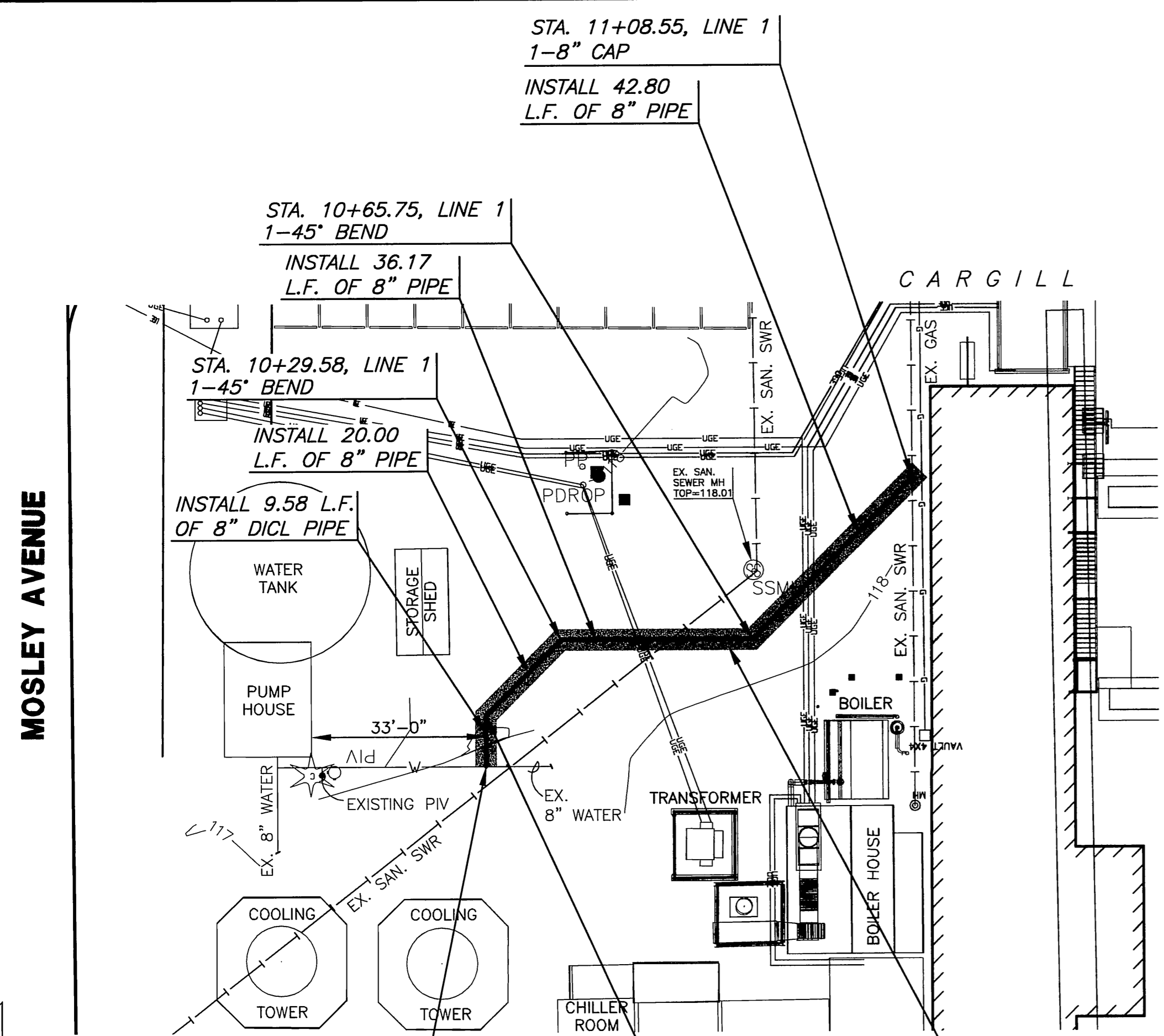

PLAN LINE 1

WATER LINE VALVES TO BE OPERATED BY CONTRACTOR ONLY IF WATER INSPECTOR IS ON SITE

APPROX. DEPTH OF BURY TO BE 4'-6" TO BOTTOM OF TRENCH

PROFILE LINE 1

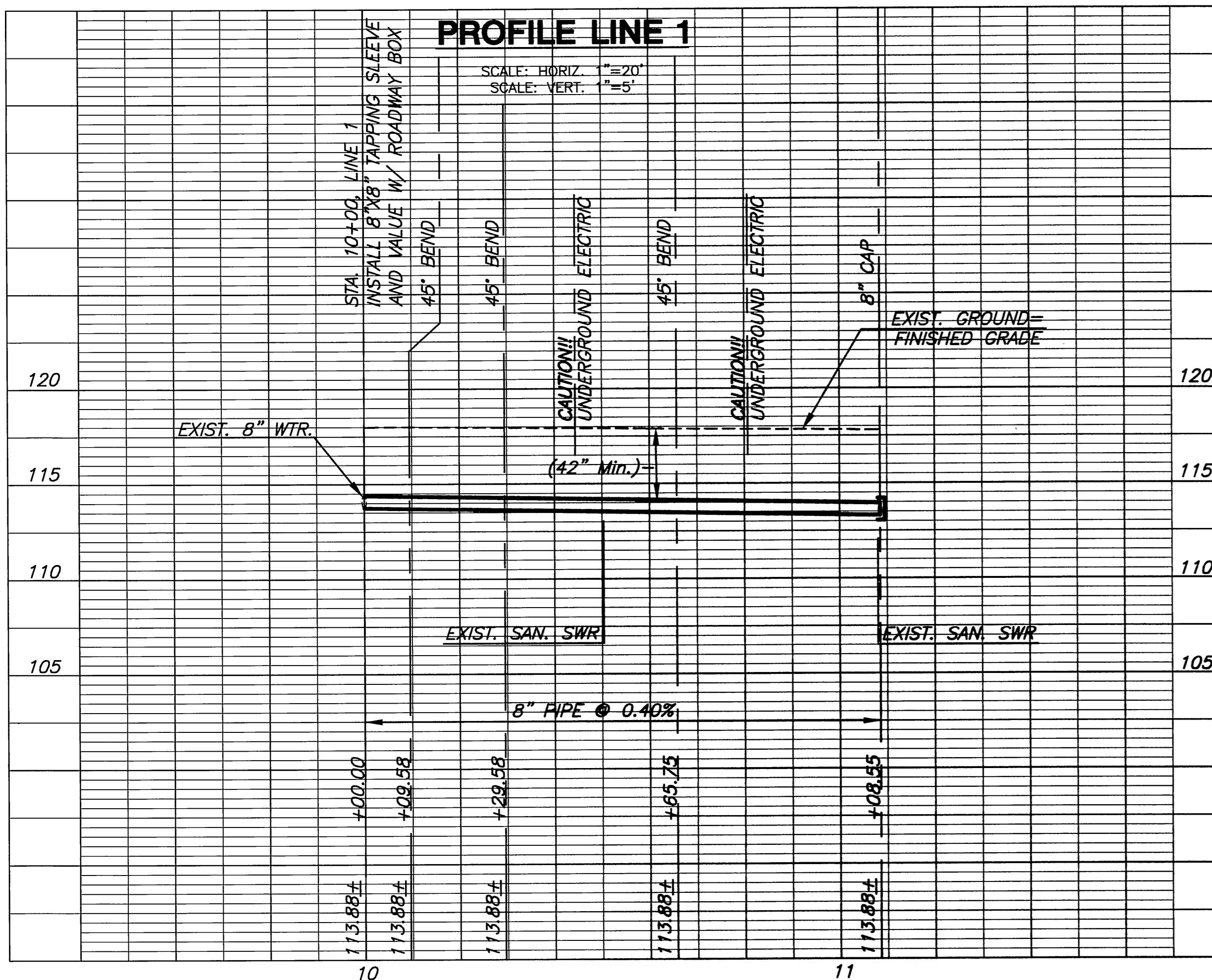

CONSTRUCTION JOINT (C.J.)
SCALE: NONE

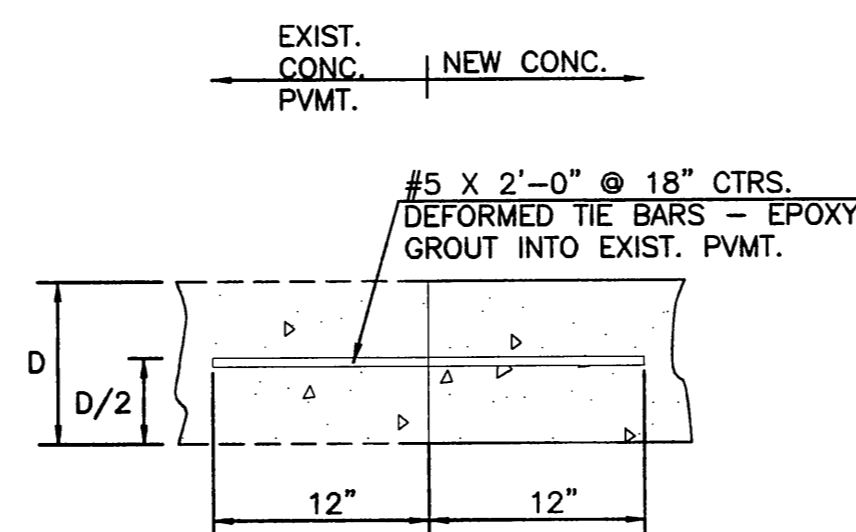

MKEC
ENGINEERING
CONSULTANTS
411 N. WEBB ROAD
WICHITA, KS. 67206
316-684-9600

THIS DRAWING IS THE PROPERTY OF CARGILL INCORPORATED AND IS SUBJECT TO RETURN ON DEMAND. NO PART OF THE INFORMATION CONTAINED WITHIN THIS DRAWING MAY BE REPRODUCED, STORED IN A RETRIEVAL SYSTEM OR TRANSMITTED IN ANY FORM, (ELECTRONIC, MECHANICAL, PHOTOCOPYING OR OTHERWISE), WITHOUT WRITTEN CONSENT OF:



REV.	DATE	DESCRIPTION	BY	CHECKED	DATE	SCALE	PROJECT NO.	CARGILL JOB NO.	DATE PRINTED
DESIGNED									4/21/10
CHECKED									
DRAWN									
PROJECT NO.	0901060010								
REV. DATE	REV. DATE								
PLANT	WICHITA, KS								
DEPARTMENT	CIVIL								
DWG. NO.	C069_031004								

K:\PETRO\cargill\2009\0901060010 - Prep Expansion\civ\c069_031004