

For Reference Only
See City Approved
Plans for Const.

GRADING NOTES

- Contractor shall be required to provide notice to Kansas One Call at 867-2470 a minimum of two (2) working days prior to any excavation or work adjacent to utilities.
- The Contractor must notify the following in case of an emergency:
 Kansas Gas Service (Gas) 1-888-482-4600
 Black Hills Energy (Gas) 1-800-303-0307
 Water Energy (Electric) 913-8650
 Cox Communications (Telecommunication) 913-4270
 AT&T (Telecommunication) 288-2759
 City of Wichita Water Dept. (Water) 288-4063
 City of Wichita Sewer Mgmt. (San. Sewer) or 288-4058
 City of Wichita Storm Sewer Mgmt. (Storm Sewer) 288-4050
 City of Wichita Traffic Mgmt. (Traffic Control) 288-4034
 Conoco Pipeline Co. (Petroleum) 1-800-231-2551
 Williams Pipeline Co. (Petroleum) 1-800-769-8230
 Phillips Pipeline Co. (Petroleum) or 1-800-324-8686
- Existing utilities and their locations, as shown on the plans, represent the best information obtainable for design. Location information has been obtained from the various utility companies and is either from company record drawings or company provided field locations. The Contractor will be required to work around existing utilities which do not conflict with proposed construction.
- Traffic affected by the construction on this project shall be handled in accordance with the latest edition of the Local Manual on Uniform Traffic Control Devices.
- The Contractor shall verify all utility locations prior to construction of this project.
- Refer to Landscaping Plan for treatment of disturbed areas.
- Mow strip to be constructed 4" below finished floor elevation unless otherwise noted on plan. Sidewalk located adjacent to proposed building is to be constructed at finished floor elevation unless noted otherwise.

LEGAL DESCRIPTION

Lot 1, Block A, Dodge Elementary Addition, Wichita, Sedgewick County, Kansas.

SITE INFORMATION

Total Area: 3,312.68sq. ft. (77.18 acres)
 Disturbed Area: 2,211.64sq. ft. (50.90 acres)
 Ex. Impervious Area: 2,001.15sq. ft. (45.90 acres)
 Impervious area removed: 2,702.2sq. ft. (61.07 acres)
 New Impervious Area: 1,116.77sq. ft. (25.36 acres)
 Net Impervious Area: 2,215.78sq. ft. (50.95 acres)
 New Building Area: 4,376 sq. ft.
 25 Spaces, including 2 Accessible Stalls

BENCHMARK

Benchmark - "X" Cut in top of curb SW return.
 Elevation=1305.47 (NAVD 88)

LEGEND

- Existing Utilities:**
- Underground Electric Service
 - Overhead Electric
 - Water Line
 - Gas Line
 - Storm Water Sewer Pipe
 - Sanitary Sewer Line
 - Telecommunication Line
 - Cable TV Line
- Proposed Utilities:**
- Electric Underground
 - Electric Overhead
 - Water Line
 - Gas Line
 - Storm Water Sewer Pipe (Not Profiled)
 - Storm Water Sewer Pipe (Profiled)
 - Road Drain
 - Sanitary Sewer Line
 - Telecommunication (AT&T)
 - Telecommunication (Cox)

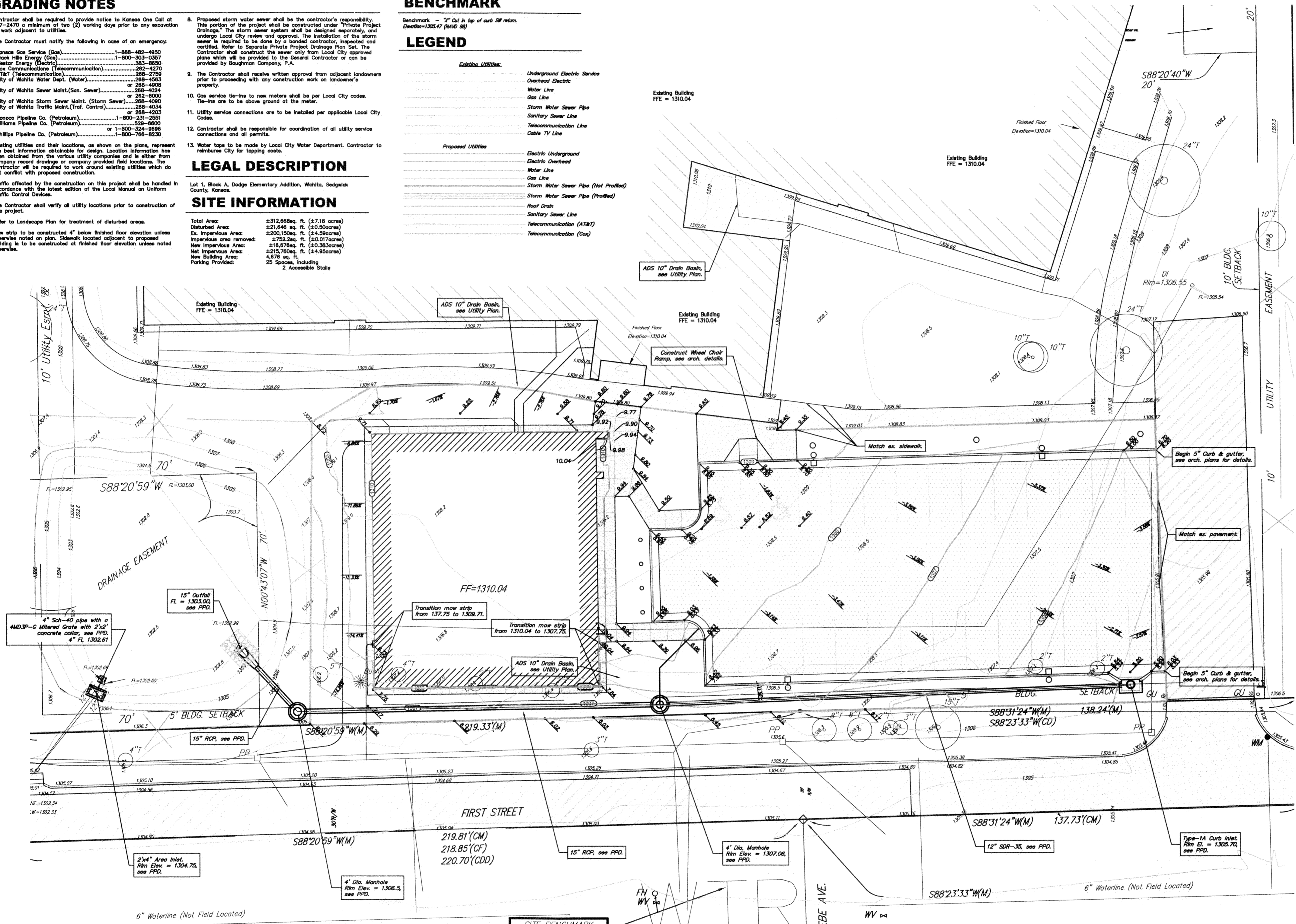

GRADING PLAN

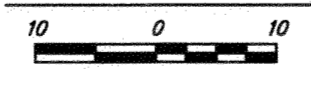

Baughman Company, P.A.
 315 Ellis St. Wichita, KS 67211
 316-262-7271 | 316-262-0149

GRACE MED ADDITION
 DODGE ELEMENTARY - USD 259

Project Number
 SJCF 3030.30

Date
 29 MARCH 2012

CONCEPT
 GRADING PLAN

Scale
 1" = 10'-0"

C22.0

Revisions

Revisions table with columns for description and date.

Project Number
 SJCF 3030.30

Date
 29 MARCH 2012

CONCEPT
 GRADING PLAN

Scale
 1" = 10'-0"

C22.0

	Grading Plan (Reference Only)	
	Dodge Elementary Addition Lot 1, Block A	
Baughman Company, P.A. 315 Ellis St. Wichita, KS 67211 P 316-262-7271 F 316-262-0149 ENGINEERING SURVEYING PLANNING LANDSCAPE ARCHITECTURE		
PROJECT NUMBER 92 PPD (607861)	DESIGN DRAWN	APPROVED DATE 05/12
REVISIONS:	SCALE None	SHEET 3 OF 9
Grace Med at Dodge Elem (12-01-E714) Engineering/PPD 12-01-E714		

SCHAEFER JOHNSON COX FREY ARCHITECTURE, INC.
 287 N. Broadway
 Wichita, KS 67202
 316-262-7271
 316-262-0149
 www.sjcf.com

DUDLEY WILLIAMS & ASSOCIATES, P.A.
 STRUCTURAL ENGINEERS
 1001 S. W. 10th St.
 Wichita, KS 67202
 316-262-7271
 316-262-0149
 www.dudleywilliams.com

JOHNSON ENGINEERING, INC.
 MECHANICAL ENGINEERS
 ELECTRICAL ENGINEERS
 CIVIL ENGINEERS
 4801 WEST 2ND STREET
 WICHITA, KS 67212