

**STATE OF KANSAS**  
**DEPARTMENT OF TRANSPORTATION**  
**PLAN AND PROFILE OF PROPOSED**

**BROADWAY BRIDGE**  
**AT 34TH STREET SOUTH**

**FEDERAL AID PROJECT**

CITY OF WICHITA PAVING PROJECT NO. 472-84830 (OCA#715727)  
 CITY OF WICHITA WATER PROJECT NO. 448-90570 (OCA#636266)

WICHITA, SEDGWICK COUNTY, KANSAS  
 POPULATION = 361,420

STATE	PROJECT NO.	YEAR	SHEET NO.	TOTAL SHEETS
KANSAS	87 N-0519-01	2012	1	212

KTOT PROJ. NO. 87-N-0519-01  
 F.A. NO. STP N051(901)

- GRADING
- SURFACING
- SANITARY SEWER
- STORM SEWER
- WATER
- BRIDGE
- PAVEMENT MARKING
- SEEDING



**BROADWAY BRIDGE**  
**AT 34TH STREET SOUTH**

<b>TITLE SHEET</b>	
SHEET TITLE	472-84830
PROJECT NUMBER	
DESIGN BY	MKEC
DRAWN BY	MKEC
CHECKED BY	MKEC
ISSUED	October 9, 2012
REVISION	
SHEET NO.	1 of 212

**INDEX OF SHEETS**

SHEET NO	DESCRIPTION
1	TITLE SHEET
2	GENERAL NOTES
3-4	TYPICAL SECTIONS
5	RIGHT-OF-WAY PLAN
6-17	PAVING PLANS
18-20	PAVING BUBBLE MAP
21-22	PROJECT GRADING PLANS
23	STORM SEWER AND OPEN CHANNEL KEY MAP
24	STORM SEWER SUMMARY OF QUANTITIES
25-39	STORM SEWER PLAN AND PROFILES
40-42	STORM SEWER BUBBLE MAP
43-52	PAVING DETAILS
53-65	STORM SEWER DETAILS
66-70	WALL PLANS AND DETAILS
71	MISCELLANEOUS DETAILS
72	EXCAVATION DETAILS
73	BRIDGE DEMOLITION
74-101	BR. NO. 530400870R10P11
102-103	SANITARY SEWER IMPROVEMENT PLANS
104-112	WATER IMPROVEMENT PLANS
113-114	WATER AND SANITARY SEWER BUBBLE MAP
115-116	SUMMARY OF QUANTITIES
117-125	SOIL EROSION BMP'S
126-131	ROADSIDE IMPROVEMENT PLANS
132-139	PAVEMENT MARKING AND SIGNING
140-145	SHOOFLY DETOUR PLAN, PROFILE AND DETAILS
146-147	CONSTRUCTION SEQUENCE SUMMARY
148-168	TRAFFIC CONTROL PLANS
169	DRAINAGE MAP
170-212	CROSS SECTIONS

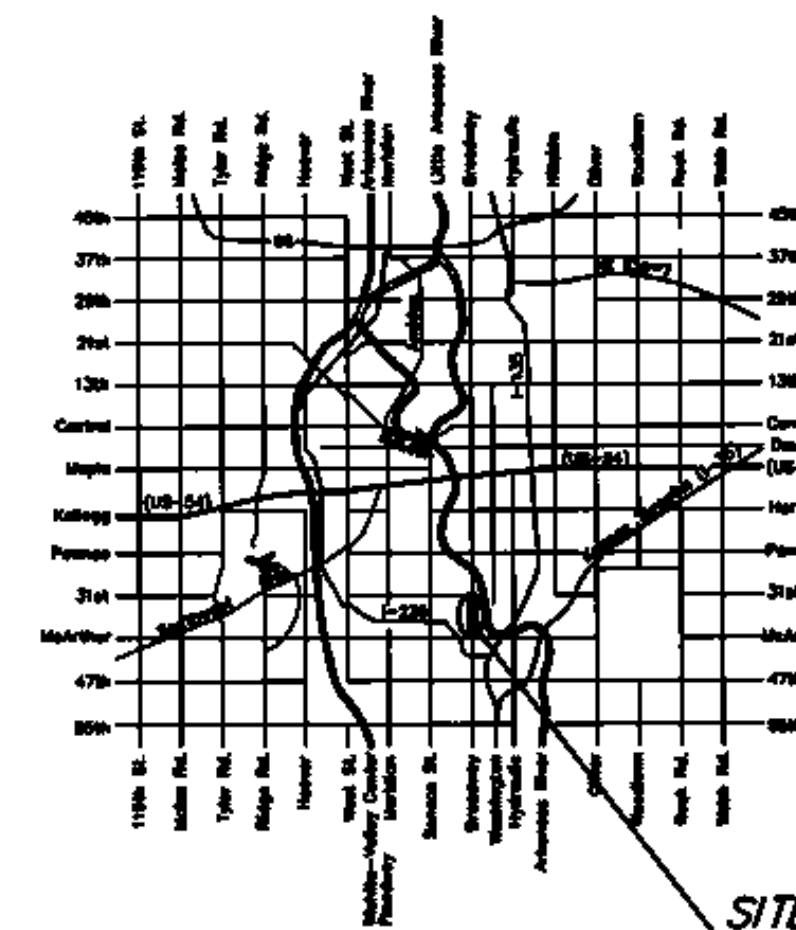

**LOCATION MAP**

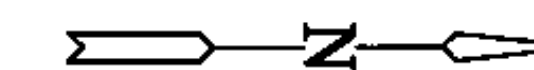

SCALE: 1"=200'

Sta. 34+93.90 BEGIN  
 Proj. No. 472-84830

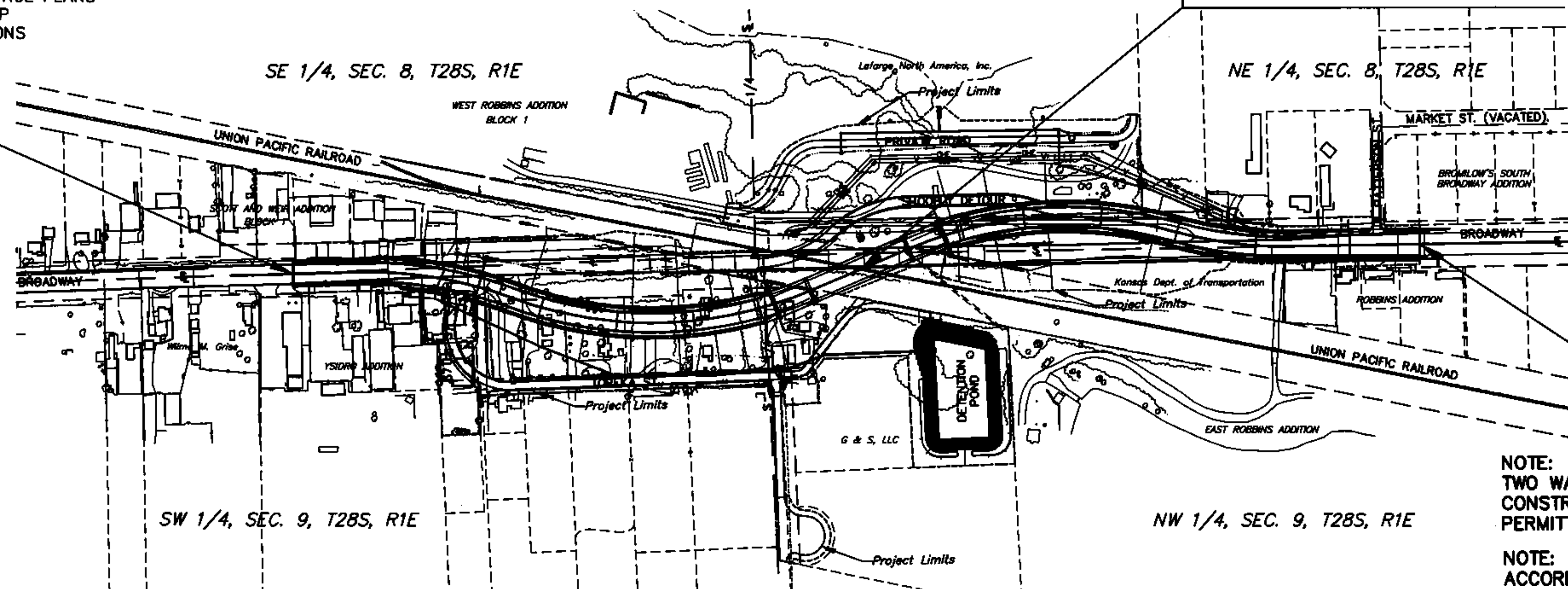

Sta. 50+00.00 Construct  
 Br. No. 530400870R10P11  
 100'-276'-100' Weathering Steel Welded  
 Plate Girder Composite Span  
 52'-0" Roadway  
 6'-0" Sidewalk Lt. & Rt.

Sta. 64+81.64 END  
 Proj. No. 472-84830

**DESIGN DESIGNATION**

AADT (2010)	=	10,826
AADT (2020)	=	13,210
DHV	=	10%
D	=	60%
T	=	3%
V	=	40 M.P.H.
C of A	=	NONE
Clear Zone	=	6 FT.

GROSS LENGTH OF PROJECT	2,987.74 FT.
EXCEPTIONS	0.00 FT.
ADDITIONS	0.00 FT.

NET LENGTH OF PROJECT	2,987.74 FT.	0.56 MILES
NET LENGTH OF BRIDGES	479.00 FT.	0.09 MILES
NET LENGTH OF ROAD	2,508.74 FT.	0.47 MILES

NOTE: TWO WAY TRAFFIC TO BE CARRIED THROUGH CONSTRUCTION. LOCAL TRAFFIC WILL BE PERMITTED TO ADJACENT PROPERTIES.

NOTE: THE PIPES ON THIS PROJECT ARE IN ACCORDANCE WITH THE CURRENT KDOT PIPE POLICY.

PREPARED & SUBMITTED BY

MKEC ENGINEERING CONSULTANTS, INC.  
 WICHITA, KANSAS

APPROVED - DATE

*Gary Janzen* 10/11/12  
 GARY JANZEN, P.E.  
 INTERIM CITY ENGINEER

COUNTY LINE	-----	CENTER LINE OF PROJECT	-----
CITY LIMITS	-----	TERRACE	-----
STATE OR NATIONAL LINE	-----	CULVERTS	-----
TOWNSHIP, SECTION or GRANT LINE	-----	DROP INLET & STORM SEWER	-----
PROPERTY LINE	-----	ACCESS CONTROL	-----
HIGHWAY FENCE	-----	POWER POLE	-----
EXISTING FENCE	-----	TELEPHONE POLE	-----
GUARD FENCE	-----	MARSH	-----
CONSTRUCTION LIMITS	-----	HEDGE	-----
RIGHT OF WAY LINE	-----	TREES	-----
TRAVELED WAY	-----	PROFILE ELEVATION	-----
RAILROADS	-----	STREAM OR CREEK	-----

PLOTTED: Thursday, October 11, 2012 @ 03:15PM

J:\Civ\09081\dwg\Title\_090811T