

| | | | | |
|--------|--------------|------|-----------|--------------|
| STATE | PROJECT NO. | YEAR | SHEET NO. | TOTAL SHEETS |
| KANSAS | 87 N-0519-01 | 2012 | 80 | 212 |

MKEC
ENGINEERING
CONSULTANTS, INC.

411 N. WEBB ROAD
WICHITA, K.S. 67206
316-684-9600

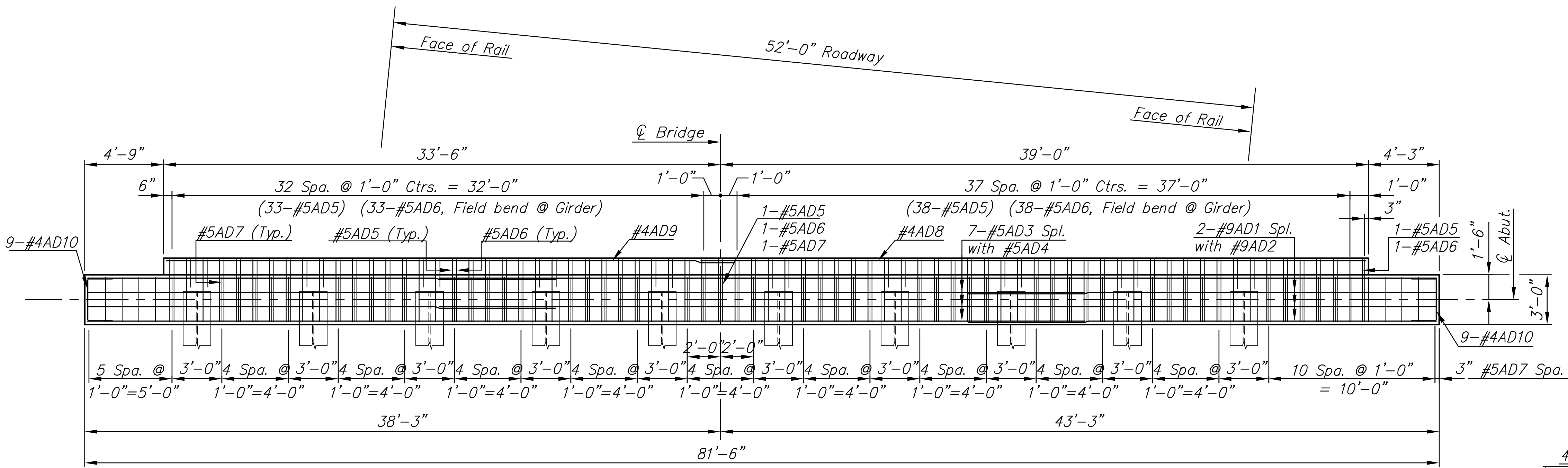
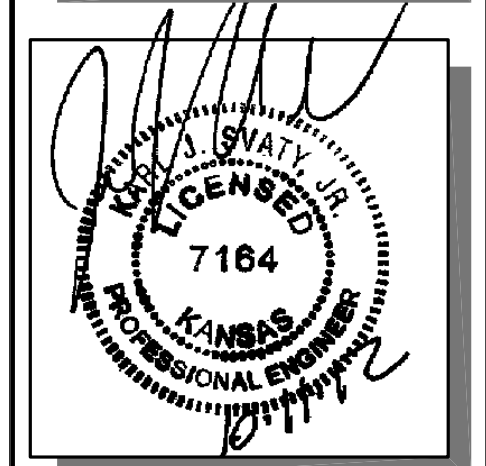

PLAN
(Showing Reinforcing Steel in Abutment Diaphragm)

Abutment No. 1 Looking Back Station
Abutment No. 2 Looking Forward Station

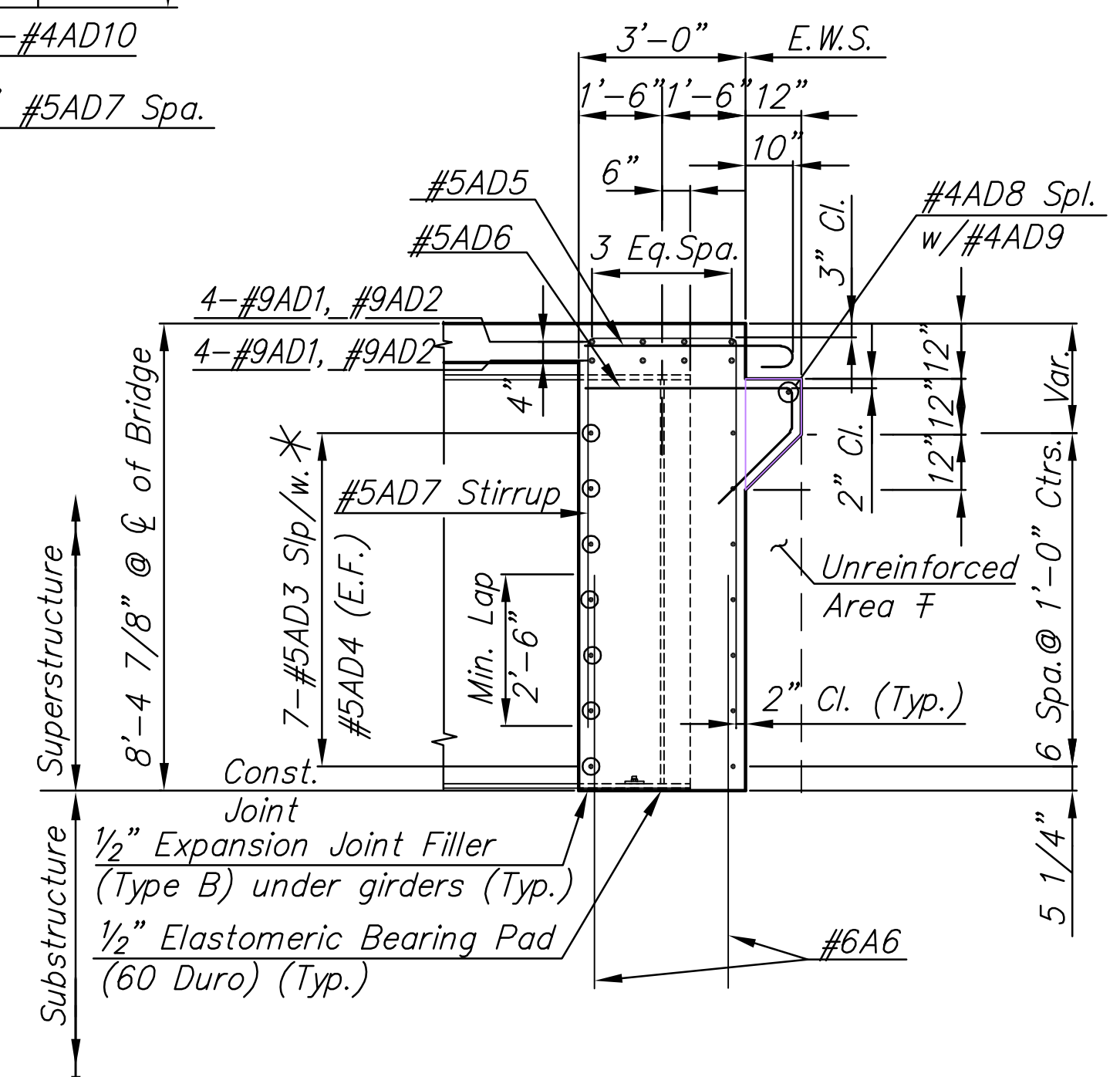

TYPICAL SECTION

* Reinforcing bars (#5AD3, #5AD4) pass through holes in web of beam. Place black mastic or expansion joint material around bars through beams to prevent concrete intrusion. (See Girder Detail Sheet for hole locations.)

† At the Contractor's option and expense, the backwall may be formed vertically as shown.

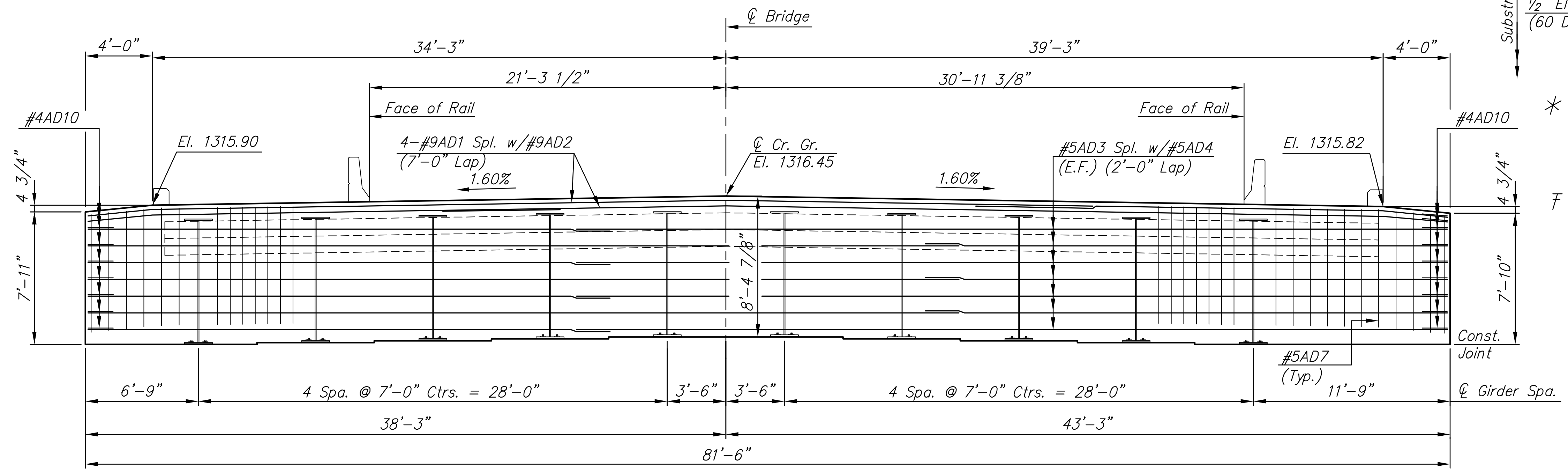

ELEVATION

(Showing Reinforcing Steel in Abutment Diaphragm)

Abutment No. 1 Looking Back Station
Abutment No. 2 Looking Forward Station

PLOTED: Thursday, October 11, 2012 @ 10:47AM

J:\Civil\09081.dwg\BRIDGE\09081_AB2

**BROADWAY BRIDGE
AT 34TH STREET SOUTH**

BRIDGE ABUTMENT DIAPHRAGM DETAILS

SHEET TITLE
472-84830
PROJECT NUMBER

DESIGN BY: JAG
DRAWN BY: DPG
CHECKED BY: KJS

ISSUED
October 9, 2012
REVISED

SHEET NO.
80 of 212