

STATE	PROJECT NO.	YEAR	SHEET NO.	TOTAL SHEETS
KANSAS	87 N-0519-01	2012	135	212

**MKEC**  
ENGINEERING  
CONSULTANTS, INC.

411 N. WEBB ROAD  
WICHITA, K.S. 67206  
316-684-9600

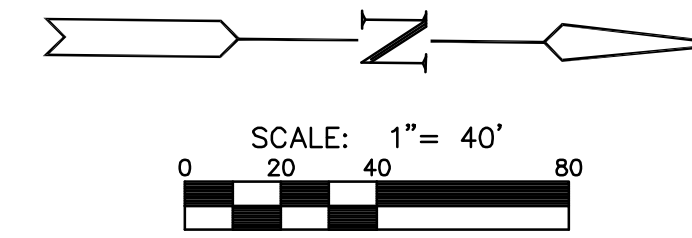
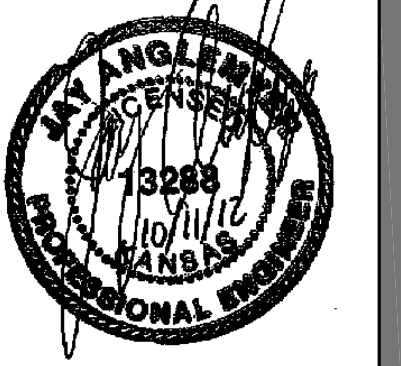

Locations on Bridge to be Field Verified. Foundations and Base for Light Poles affixed to Bridge shall be compatible with the Bridge design and Construction. Contractor shall submit Plan to affix Light Poles to Bridge prior to Construction.

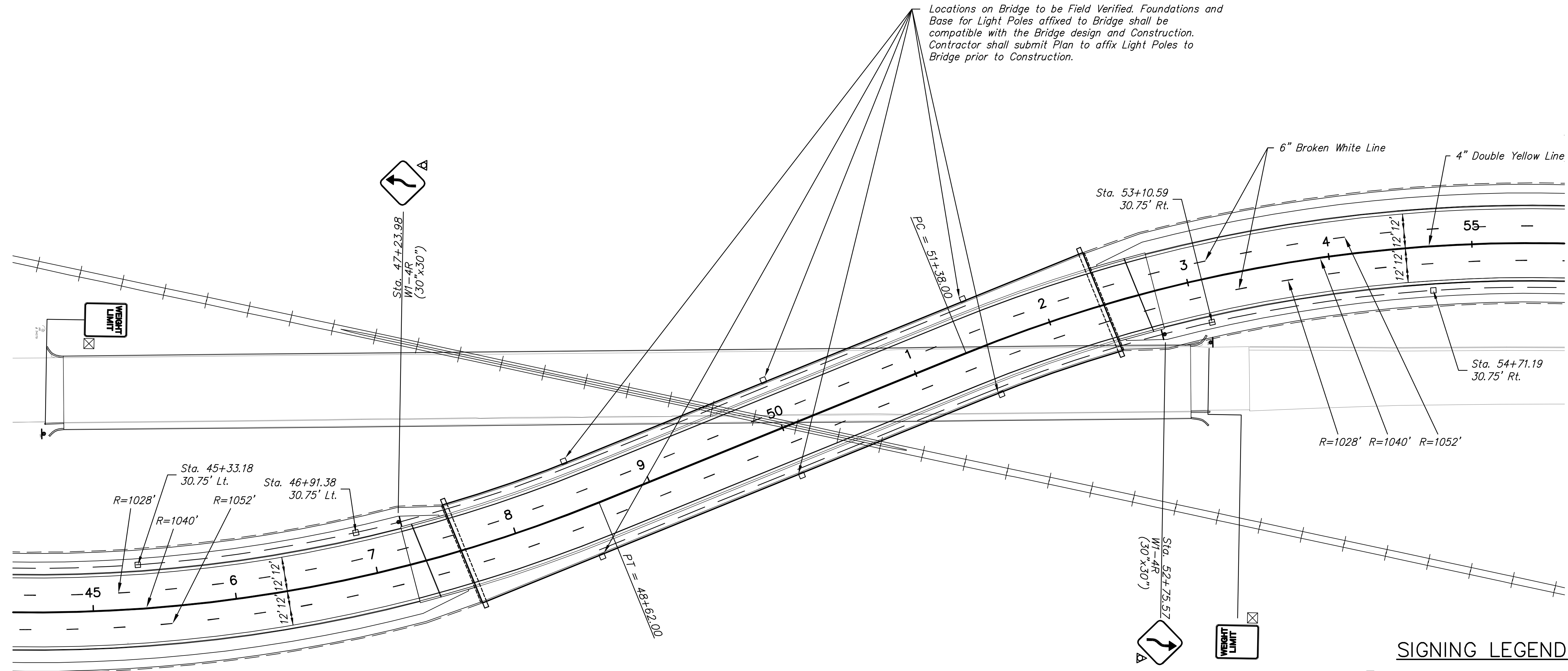

**SIGNING LEGEND**

- Sign not part of project
- ◊ New sign and post
- ⊗ Remove existing sign and post and return to sign owner
- Street Sign
- Traffic Sign
- 2" SCH 40 PVC Conduit w/ Pull Wire
- Light Pole Foundation w/ Pole Base

**BROADWAY BRIDGE  
AT 34TH STREET SOUTH**

**PAVEMENT  
MARKING &  
SIGNING  
PLAN**

SHEET TITLE  
472-84830  
PROJECT NUMBER

DESIGN BY: JRA  
DRAWN BY: TBK  
CHECKED BY: JRA

ISSUED  
October 9, 2012  
REVISED

SHEET NO.  
135 of 212