

**Emerald Bay Estates
Second Addition**

21 ①

N 21567.06 E 21405.04
STA. 0+00.00 SWS LINE 1
BL STA. 24+30.06, 218.69' RT
PLACE 15" RCP END SECTION &
17 SY LIGHT STONE RIP RAP
FL ELEV.=1309.00

CONTRACTOR TO RESTRAIN LAST THREE
SECTIONS OF PIPE AND END SECTION AND
FIELD ADJUST END SECTION TO MATCH SLOPE

N 21369.11 E 21407.55
STA. 1+97.97 SWS LINE 1
BL STA. 24+27.55, 20.74' RT
CONSTRUCT TYPE 1A 10'x3' INLET
W/ 24F SNOUT & STAINLESS
TRASHSCREEN FILTER

N 21327.71 E 21410.06
STA. 2+39.45 SWS LINE 1
BL STA. 24+25.05, 20.67' LT.
CONSTRUCT TYPE 1A 5'x3' INLET

REMOVE EXISTING TREES AS NECESSARY
FOR CONSTRUCTION. SUBSIDIARY TO
BID ITEM FOR "SITE CLEARING".

NOTE: 4" PERFORATED PVC STUB FOR
PAVEMENT UNDERDRAIN SHALL BE
SUBSIDIARY TO LINE ITEM FOR ALL
CURB INLETS.

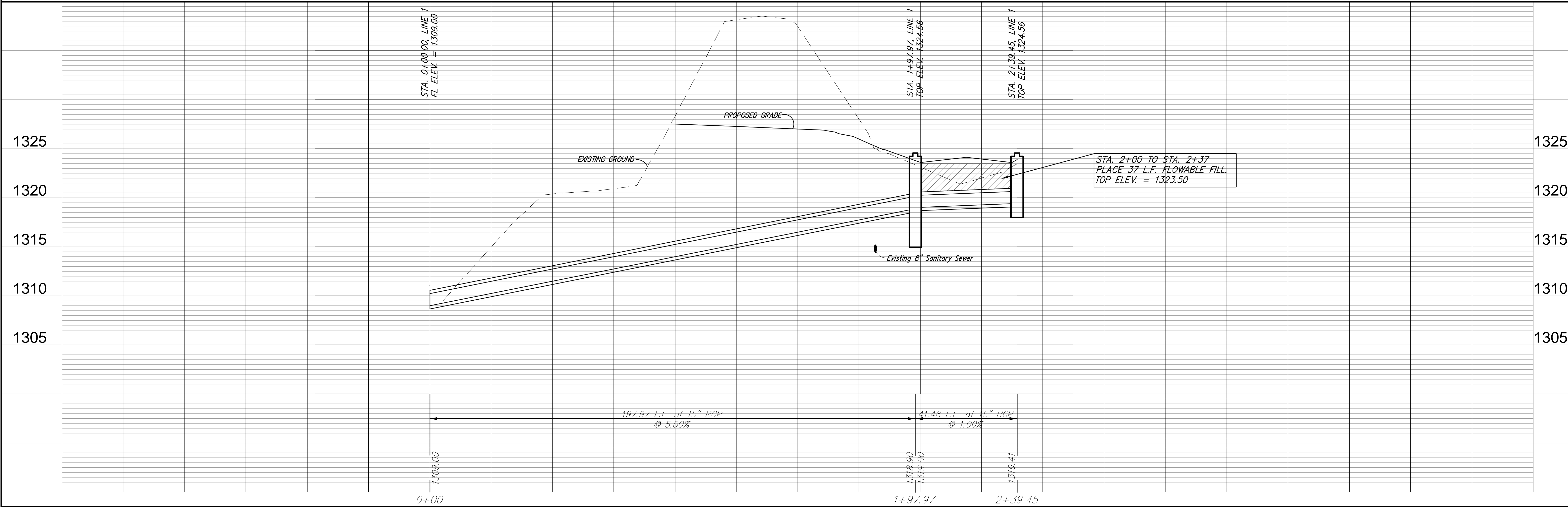
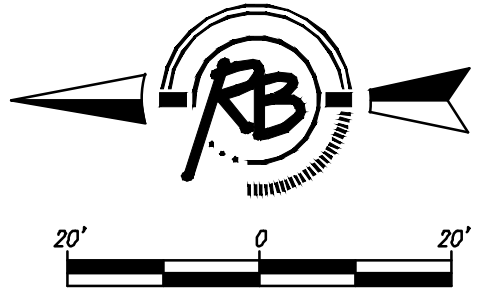

Ruggles & Bolin, P.A. Engineering & Surveying, Land Planning 624 North Main Wichita, Kansas 67203 (316) 264-4667 www.rugbol.com	
DESIGN	AML
DRAWN	RA
DATE	October 8, 2012
REVIEW	REVIEW
PROJECT NUMBER	468-84845
DRAWING FILE	ENGINEERING BASE (SWS Line 1)
STORM SEWER IMPROVEMENTS LINE 1 WICHITA, KANSAS	
REVISION	4005R
SHEET	2
OF	13