

Install 650 If of 8" Cured-in-Place Liner:
196 lf from MH 5747-504 to MH 5747-454
454 lf from MH 5747-455 to MH 5747-452

MH 5747-455
140 S. Dellrose
Approx depth = 11.7 ft

MH 5747-454
168 S. Dellrose
Approx depth = 12.9 ft

MH 5747-504
178 S. Dellrose
Approx depth = 11.6 ft

MH 5747-453
4726 E. English
Approx depth = 10.0 ft

MH 5747-452
4701 E. English
Approx depth = 11.2 ft

SITE 1

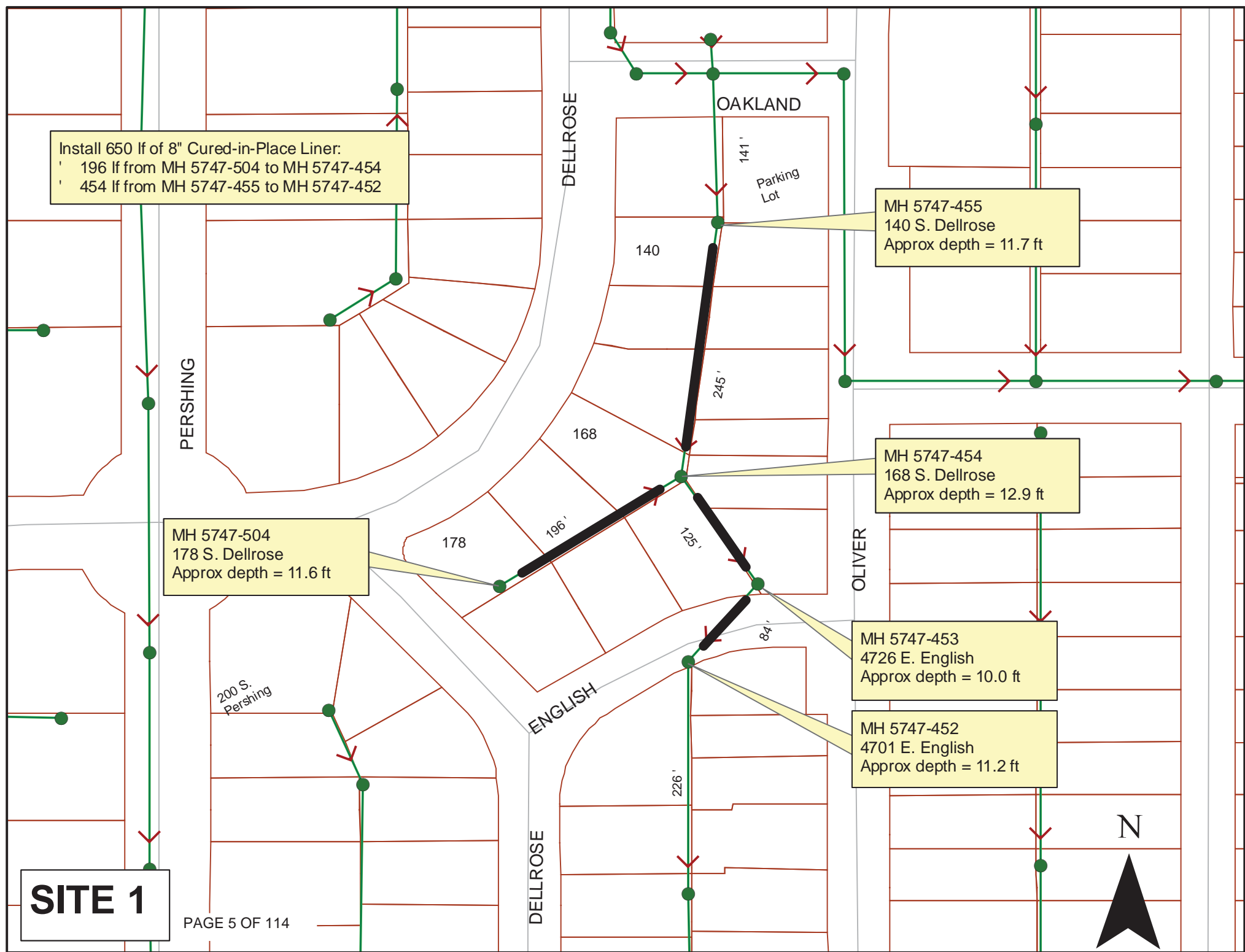



Television Inspection Master Report

5/8/2009
11:24 AM

US Structure: 5747-504 178 S DELROSE ST Date Insp: 12/7/2007 Basin: E04C
 DS Structure: 5747-454 168 S DELROSE ST Dir Televised: Upstream To Downstream

Pipe Information
 Project No.: C-038 Dia: 8 Material: VCP Length: 196.0 Slope: 0.400 DVD #0348

Obs. #	VTR Counter	Distance	Location	Description	Rating	Ratings				
						Obsrvd (gpm)	Est. (gpm)	Struct	Clean	Remain (gpm)
1		7.0	US Manhole 5747-504 (in concrete driveway)		1					
2		7.8	North	178 S DELROSE	Break-In Conn	1		4" Predco Saddle		
3		10.5	South		SEALED Wye Service	1	0.000		0	0.000
4		12.0	Joint		Offset	3	0.010		20	0.010
5		17.0	Upper Right	MINERAL DEPOSITS	Scaling	2	0.000		2	0.000
6		19.5	Lower Left		PR Starts - Mat. Chngs to PVC	1	0.000		0	0.000
7		23.5	Invert		PR Ends - Mat. Chngs to VCP	1	0.000		0	0.000
8		25.6	North	178 S DELROSE	Break-In Conn	1		4" Predco Saddle		
9		28.4	North		SEALED Wye Service	1	0.000		0	0.000
10		29.6	Lower Left	MINERAL DEPOSITS	Scaling	2	0.000		2	0.000
11		30.9	South		SEALED Wye Service	1	0.000		0	0.000
12		32.5	Upper Right	MINERAL DEPOSITS	Scaling	2	0.000		2	0.000
13		34.9	Upper Right	MINERAL DEPOSITS	Scaling	2	0.000		2	0.000
14		37.4	Lower Left	MINERAL DEPOSITS	Scaling	2	0.000		2	0.000
15		42.2	Upper Right	MINERAL DEPOSITS	Scaling	3	0.000		10	0.000
16		45.0	Upper Right	MINERAL DEPOSITS	Scaling	3	0.000		10	0.000
17		47.5	Joint		Gapped Joint	3	0.010		20	0.010
18		50.1	Joint		Gapped Joint	3	0.010		20	0.010
19		50.1	Upper Right	MINERAL DEPOSITS	Scaling	3	0.000		10	0.000
20		52.5	Upper Right	MINERAL DEPOSITS	Scaling	2	0.000		2	0.000
21		53.9	North		SEALED Wye Service	1	0.000		0	0.000
22		56.5	South		SEALED Wye Service	1	0.000		0	0.000
23		57.8	Upper Right	MINERAL DEPOSITS	Scaling	3	0.000		10	0.000
24		62.7	Upper Right	MINERAL DEPOSITS	Scaling	3	0.000		10	0.000
25		65.5	Upper Right	MINERAL DEPOSITS	Scaling	2	0.000		2	0.000
26		68.1	Upper Right	MINERAL DEPOSITS	Scaling	3	0.000		10	0.000
27		73.0	Upper Right	MINERAL DEPOSITS	Scaling	3	0.000		10	0.000
28		76.5	North	172 S DELROSE	Break-In Conn	3		4" Connection		
29		79.2	South	4700 E ENGLISH	Break-In Conn	1		4" Predco Saddle		
30		96.1	Lower Left	MINERAL DEPOSITS	Scaling	2	0.000		2	0.000
31		98.6	Upper Right	MINERAL DEPOSITS	Scaling	2	0.000		2	0.000



Television Inspection Master Report

5/8/2009
11:24 AM

US Structure: 5747-504 178 S DELLROSE ST Date Insp: 12/7/2007 Basin: E04C
 DS Structure: 5747-454 168 S DELLROSE ST Dir Televised: Upstream To Downstream

32	101.1	Upper Right / MINERAL DEPOSITS	Scaling	2	0.000	2	0	0.000
33	102.3	North SEALED Wye Service	Scaling	1	0.000	0	0	0.000
34	103.8	Upper Right / MINERAL DEPOSITS	Scaling	3	0.000	10	0	0.000
35	105.0	South SEALED Wye Service	Scaling	1	0.000	0	0	0.000
36	108.8	Upper Right / MINERAL DEPOSITS	Scaling	2	0.000	2	0	0.000
37	111.3	Joint Gapped Joint	Scaling	3	0.010	20	0	0.010
38	111.3	Upper Right / MINERAL DEPOSITS	Scaling	3	0.000	10	0	0.000
39	116.5	Upper Right / MINERAL DEPOSITS	Scaling	2	0.000	2	0	0.000
40	121.6	Lower Left / MINERAL DEPOSITS	Scaling	3	0.000	10	0	0.000
41	124.1	Lower Left / MINERAL DEPOSITS	Scaling	2	0.000	2	0	0.000
42	127.8	North SEALED Wye Service	Scaling	1	0.000	0	0	0.000
43	129.0	Lower Left / MINERAL DEPOSITS	Scaling	3	0.000	10	0	0.000
44	130.3	South SEALED Wye Service	Scaling	1	0.000	0	0	0.000
45	131.8	Joint Gapped Joint	Scaling	4	0.030	60	0	0.030
46	134.5	Joint Gapped Joint	Offset	2	0.000	0	0	0.000
47	136.8	Joint	Offset	2	0.000	0	0	0.000
48	136.8	Upper Right / MINERAL DEPOSITS	Scaling	3	0.000	10	0	0.000
49	139.5	Upper Right / MINERAL DEPOSITS	Scaling	3	0.000	10	0	0.000
50	141.9	Lower Left / MINERAL DEPOSITS	Scaling	2	0.000	2	0	0.000
51	144.4	Lower Left / MINERAL DEPOSITS	Scaling	3	0.000	10	0	0.000
52	146.9	Upper Right / MINERAL DEPOSITS	Scaling	3	0.000	10	0	0.000
53	149.5	Lower Left / MINERAL DEPOSITS	Scaling	4	0.000	25	0	0.000
54	151.9	Lower Left / MINERAL DEPOSITS	Scaling	4	0.000	25	0	0.000
55	153.3	North SEALED Wye Service	Scaling	1	0.000	0	0	0.000
56	154.9	Lower Left / MINERAL DEPOSITS	Scaling	3	0.000	10	0	0.000
57	155.9	South SEALED Wye Service	Offset	1	0.000	0	0	0.000
58	156.9	Joint	Offset	3	0.010	20	0	0.010
59	159.7	Joint Gapped Joint	Scaling	3	0.010	20	0	0.010
60	159.7	Upper Right / MINERAL DEPOSITS	Scaling	3	0.000	10	0	0.000
61	162.7	Upper Right / MINERAL DEPOSITS	Scaling	3	0.000	10	0	0.000
62	167.4	Lower Left / MINERAL DEPOSITS	Scaling	3	0.000	10	0	0.000
63	168.4	North 168 S DELLROSE 4" Break-In Conn	Roots	3	0.000	10	0	0.000
64	169.7	Lower Left / MINERAL DEPOSITS	Scaling	3	0.000	10	0	0.000
65	172.3	Lower Left / MINERAL DEPOSITS	Scaling	3	0.000	10	0	0.000
66	175.9	South SEALED Wye Service	Scaling	1	0.000	0	0	0.000
67	177.3	Lower Left / MINERAL DEPOSITS	Scaling	3	0.000	10	0	0.000
68	178.5	North SEALED Wye Service	Scaling	1	0.000	0	0	0.000
69	180.0	Lower Left / MINERAL DEPOSITS	Scaling	3	0.000	10	0	0.000
70	182.6	Lower Left / MINERAL DEPOSITS	Scaling	3	0.000	10	0	0.000
71	185.1	Lower Left / MINERAL DEPOSITS	Scaling	3	0.000	10	0	0.000
72	192.9	Lower Left / MINERAL DEPOSITS	Scaling	4	0.000	25	0	0.000
73	194.7	DS Manhole 5747-454		4				



Television Inspection Master Report

5/8/2009
11:20 AM

US Structure: 5747-455 140 S DELLROSE ST Date Insp: 12/7/2007 Basin: E04C
 DS Structure: 5747-454 168 S DELLROSE ST Dir Televised: Upstream To Downstream

Pipe Information

Shape: Round Length Status: VCP Project No. : C-037
 Dia/Ht: 8 Material: Index:
 Length: 244.0 Slope: 0.400

Obs. #	VTR	Counter	Distance	Location	Description	Rating	Obsrvd (gpm)	Est. (gpm)	Ratings Struct	Clean	Remain (gpm)
1			0.0	US Manhole	5747-455	1	0.000	0.000	0	0	0.000
2			21.7	West	Wye Service / sealed off	1	0.000	0.000	0	0	0.000
3			24.5	East	Wye Service / sealed off	1	0.000	0.000	0	0	0.000
4			36.0	Joint	Offset	3	0.010	0.010	20	0	0.010
5			38.5	Upper Right	Scaling	3	0.000	0.000	10	0	0.000

Comment: On this log "Scaling" means there are MINERAL DEPOSITS IN JOINT

6			41.1	Upper Right	Scaling	3	0.000	0.000	10	0	0.000
7			43.5	Upper Right	Scaling	3	0.000	0.000	10	0	0.000
8			46.0	Crown	Scaling	3	0.000	0.000	10	0	0.000
9			47.0	West	140 S DELLROSE 4" Break-In Conn	3		Protruding Tap			
10			48.6	Upper Right	Scaling	3	0.000	0.000	10	0	0.000
11			49.7	West	Wye Service / sealed off	1	0.000	0.000	0	0	0.000
12			51.2	Invert	Scaling	3	0.000	0.000	10	0	0.000
13			52.5	East	Wye Service / sealed off	1	0.000	0.000	0	0	0.000
14			53.8	Upper Right	Scaling	3	0.000	0.000	10	0	0.000
15			56.2	Lower Left	Scaling	4	0.000	0.000	25	0	0.000
16			58.8	Upper Right	Scaling	3	0.000	0.000	10	0	0.000
17			63.9	Lower Left	Scaling	3	0.000	0.000	10	0	0.000
18			69.1	Invert	Scaling	3	0.000	0.000	10	0	0.000
19			71.7	Lower Left	Scaling	3	0.000	0.000	10	0	0.000
20			74.1	Lower Left	Scaling	3	0.000	0.000	10	0	0.000
21			75.5	West	Wye Service / sealed off	1	0.000	0.000	0	0	0.000
22			76.7	Lower Left	Scaling	3	0.000	0.000	10	0	0.000
23			77.9	East	Wye Service / sealed off	1	0.000	0.000	0	0	0.000
24			79.4	Lower Left	Scaling	3	0.000	0.000	10	0	0.000
25			81.9	Lower Left	Scaling	3	0.000	0.000	10	0	0.000
26			84.4	Lower Left	Scaling	2	0.000	0.000	2	0	0.000
27			87.1	Lower Left	Scaling	3	0.000	0.000	10	0	0.000
28			92.2	Invert	Scaling	2	0.000	0.000	2	0	0.000
29			93.9	East	155 S OLIVER 4" Break-In Conn	2	0.002	0.002	0	0	0.002
30			95.0	Upper Left / scaling	Crack-Horizontal	3	0.004	0.004	5	0	0.004
31			97.3	Joint	Offset	3	0.010	0.010	20	0	0.010



Television Inspection Master Report

5/8/2009
11:20 AM

US Structure: 5747-455 140 S DELLROSE ST Date Insp: 12/7/2007 Basin: E04C
 DS Structure: 5747-454 168 S DELLROSE ST Dir Televised: Upstream To Downstream

32	99.9	Joint	Offset	2	0.000	0	0	0.000
33	103.2	West	150 S DELROSE	PVC Break-In Conn	1	4" Predco Saddle		
34	105.7	West		Wye Service	3	0.000	2	0.000
				4" Clay Wye Connection / mineral deposits in connection				
35	106.6	Upper Left		Broken Pipe	5	0.060	100	0.060
				CONNECTION BROKEN (could this be abandoned?)				
36	107.5	Lower Left		Scaling	3	0.000	10	0.000
37	108.8	East		Wye Service / sealed off	1	0.000	0	0.000
38	110.2	Lower Right		Scaling	3	0.000	10	0.000
39	112.5	Lower Left		Scaling	3	0.000	10	0.000
40	115.1	Lower Left		Scaling	3	0.000	10	0.000
41	117.6	Lower Left		Scaling	3	0.000	10	0.000
42	122.7	Lower Left		Scaling	4	0.000	25	0.000
43	125.5	Lower Left		Scaling	4	0.000	25	0.000
44	127.9	Lower Left		Scaling	4	0.000	25	0.000
45	130.5	Lower Left		Scaling	4	0.000	25	0.000
46	131.4	West		4" Wye Service Sealed off	2	MINERAL DEPOSITS		
47	133.1	Lower Left		Scaling	4	0.000	25	0.000
48	134.2	East		Wye Service / sealed off	1	0.000	0	0.000
49	135.6			Scaling	4	0.000	25	0.000
50	138.0	Lower Left		Scaling	3	0.000	10	0.000
51	143.2	Lower Left		Scaling	4	0.000	25	0.000
52	145.8	Lower Left		Scaling	3	0.000	10	0.000
53	148.5	Lower Left		Scaling	3	0.000	10	0.000
54	153.5	Lower Left		Scaling	4	0.000	25	0.000
55	154.6	West		Wye Service / sealed off	1	0.000	0	0.000
56	156.1	Lower Left / joint		Scaling	3	0.000	10	0.000
57	157.2	East		Wye Service / sealed off	1	0.000	0	0.000
58	158.6	Lower Left		Scaling	3	0.000	10	0.000
59	160.5	East	161 S OLIVER	4" Break-In Conn	3	CONNECTION NEEDS REPAIR		
60	161.3	Lower Left		Scaling	4	0.000	25	0.000
61	166.3	Lower Left		Scaling	2	0.000	2	0.000
62	171.4	Lower Left		Scaling	2	0.000	2	0.000
63	174.1	Lower Left		Scaling	2	0.000	2	0.000
64	176.7	Upper Left		Scaling	2	0.000	2	0.000
65	179.0	Lower Left		Scaling	3	0.000	10	0.000
66	181.7	Lower Left		Scaling	4	0.000	25	0.000
67	182.8	West	160 S DELROSE	4" Wye Service	3	MINERAL DEPOSITS IN CONN.		
68	184.3	Lower Left		Scaling	4	0.000	25	0.000
69	185.5	East		Wye Service / sealed off	1	0.000	0	0.000
70	187.0	Lower Left		Scaling	3	0.000	10	0.000



Television Inspection Master Report

5/8/2009
11:20 AM

US Structure: 5747-455 140 S DELLROSE ST Date Insp: 12/7/2007 Basin: E04C
 DS Structure: 5747-454 168 S DELLROSE ST Dir Televised: Upstream To Downstream

71	189.5	Lower Left	Scaling	3	0.000	10	0	0.000
72	192.0	Lower Left	Scaling	3	0.000	10	0	0.000
73	194.5	Lower Left	Scaling	3	0.000	10	0	0.000
74	197.1	Lower Left	Scaling	2	0.000	2	0	0.000
75	199.7	Lower Left	Scaling	3	0.000	10	0	0.000
76	202.3	Lower Left	Scaling	3	0.000	10	0	0.000
77	204.8	Lower Left	Scaling	3	0.000	10	0	0.000
78	207.6	Lower Left	Scaling	3	0.000	10	0	0.000
79	208.7	West	Wye Service / sealed off	1	0.000	0	0	0.000
80	210.0	Lower Left	Scaling	4	0.000	25	0	0.000
81	211.4	East	Wye Service / sealed off	1	0.000	0	0	0.000
82	212.6	Lower Left	Scaling	2	0.000	2	0	0.000
83	215.2	Lower Left	Scaling	2	0.000	2	0	0.000
84	217.8	Joint	Offset	3	0.010	20	0	0.010
85	220.3	Lower Left	Scaling	2	0.000	2	0	0.000
86	225.3	Crown	Scaling	2	0.000	2	0	0.000
87	226.1	West	SEALED OFF Wye Service	3		MINERAL DEPOSITS		
88	228.8	East	SEALED OFF Wye Service	3		MINERAL DEPOSITS		
89	230.5	Lower Left	Scaling	3	0.000	10	0	0.000
90	233.2	Lower Left	Scaling	3	0.000	10	0	0.000
91	235.7	Upper Right	Scaling	3	0.000	10	0	0.000
92	238.3	Lower Left	Scaling	3	0.000	10	0	0.000
93	238.3	Lower Right	Debris / silt	3	0.000	0	0	0.000
94	240.9	Lower Left	Scaling	4	0.000	25	0	0.000
95	242.4	Lower Left	Scaling	3	0.000	10	0	0.000
96	245.2	DS Manhole	5747-454	5				



Television Inspection Master Report

5/8/2009
11:20 AM

US Structure: 5747-454 168 S DELLROSE ST Date Insp: 12/10/2007 Basin: E04C
 DS Structure: 5747-453 4726 E ENGLISH ST Dir Televised: Downstream To Upstream

Pipe Information
 Shape: Round Length Status: Project No. : C-037
 Dia/Ht: 8 Material: VCP Index:
 Length: 125.0 Slope: 0.400 Surface:

Inspection Information
 Crew: 690 Percent Full: Tape ID: DVD #0348
 Weather: Cloudy Purpose: TV Existing Line Counter Start:

Obs. #	VTR	Counter	Distance	Location	Description	Rating	Obsrvd (gpm)	Est. (gpm)	Ratings Struct	Clean	Remain (gpm)
1			0.0	DS Manhole	5747-453 TV AGAINST FLOW						
2			12.5	East	Wye Service / sealed off / scaling	2	0.000	0.000	0	0	0.000
3			12.7	Upper Right	Scaling	2	0.000	0.000	2	0	0.000

Comment: On this log "scaling" means MINERAL DEPOSITS IN JOINT

4			15.0	West	Wye Service / sealed off	1	0.000	0.000	0	0	0.000
5			15.3	Lower Left	Scaling	2	0.000	0.000	2	0	0.000
6			22.9	Lower Left	Scaling	3	0.000	0.000	10	0	0.000
7			28.0	Lower Left	Scaling	3	0.000	0.000	10	0	0.000
8			33.1	Lower Left	Scaling	2	0.000	0.000	2	0	0.000
9			35.5	Lower Left	Scaling	2	0.000	0.000	2	0	0.000
10			35.5	Upper Left	Infiltration	3	0.000	0.000	0	0	0.000
11			38.0	East	4726 E ENGLISH Break-In Conn	1	PVC 4" Predco Saddle				
12			38.5	Lower Left	Scaling	3	0.000	0.000	10	0	0.000
13			40.8	West	Wye Service / sealed off	3	0.000	0.000	2	0	0.000
14			40.8	Lower Left	Scaling	3	0.000	0.000	10	0	0.000
15			43.3	Lower Left	Scaling	3	0.000	0.000	10	0	0.000
16			50.9	Lower Left	Scaling	2	0.000	0.000	2	0	0.000
17			53.5	Lower Left	Scaling	3	0.000	0.000	10	0	0.000
18			56.0	Lower Left	Scaling	4	0.000	0.000	25	0	0.000
19			61.3	Crown / scaling	Crack-Horizontal	3	0.004	0.004	5	0	0.004
20			63.4	East	Wye Service / sealed off	2	0.000	0.000	0	0	0.000
21			63.4	Lower Left	Scaling	2	0.000	0.000	2	0	0.000
22			66.1	West	Wye Service / sealed off	1	0.000	0.000	0	0	0.000
23			68.6	Lower Left	Scaling	3	0.000	0.000	10	0	0.000
24			73.6	Lower Left	Scaling	3	0.000	0.000	10	0	0.000
25			86.4	Lower Left	Scaling	3	0.000	0.000	10	0	0.000



Television Inspection Master Report

5/8/2009
11:20 AM

US Structure: 5747-454 168 S DELLROSE ST Date Insp: 12/10/2007 Basin: E04C
 DS Structure: 5747-453 4726 E ENGLISH ST Dir Televised: Downstream To Upstream

26	88.6	East	Wye Service / sealed off / scaling	3	0.000	2	0	0.000
27	91.5	West	Wye Service / sealed off / scaling	2	0.000	0	0	0.000
28	91.5	Lower Left	Scaling	3	0.000	10	0	0.000
29	96.5	Lower Left	Scaling	3	0.000	10	0	0.000
30	99.0	Lower Left	Scaling	3	0.000	10	0	0.000
31	101.5	Lower Left	Scaling	3	0.000	10	0	0.000
32	114.3	Lower Left	Scaling	3	0.000	10	0	0.000
33	116.9	Lower Left	Scaling	2	0.000	2	0	0.000
34	119.4	Lower Left	Scaling	3	0.000	10	0	0.000
35	120.5	Lower Left	Scaling	3	0.000	10	0	0.000
36	122.4	US Manhole	5747-454	4	0.000	0	0	0.000



Wichita Water Utilities — Connect With Us!

Television Inspection Master Report

5/8/2009

11:20 AM

US Structure: 5747-453
DS Structure: 5747-452

4726 E ENGLISH ST
4701 E ENGLISH ST

Date Insp: 12/10/2007
Dir Televised: Upstream To Downstream

Basin: E04C

Pipe Information

Shape: Round
Dia/Ht: 8
Length: 84.0

Length Status:
Material: VCP
Slope: 0.400

Project No. : C-037
Index:
Surface:

Inspection Information

Crew: 690
Weather: Cloudy

Percent Full:
Purpose: TV Existing Line

Tape ID:
Counter Start:

DVD #0348

Obs. #	VTR	Counter	Distance	Location	Description	Rating	Ratings		
							Obsrvd (gpm)	Est. (gpm)	Struct Clean
1			0.0	US Manhole	5747-453	1			
2			37.3	Crown		2			MINERAL DEPOSITS IN JOINT
3			62.4	Upper Right		3			MINERAL DEPOSITS IN JOINT
4			67.7	Lower Left		3			Infiltration
5			78.1	Lower Left		3			Crack-Radial WATER, AND MINERAL DEPOSITS
6			83.5	DS Manhole	5747-452	3			