

**CENTRAL AVENUE  
IMPROVEMENTS FROM  
135TH ST. W. TO 119TH ST. W.**

**PAVING  
BUBBLE MAP**

SHEET TITLE  
**472-84017**  
PROJECT NUMBER

DESIGN BY  
**JRA**

DRAWN BY  
**DPG**

CHECKED BY  
**JRA**

ISSUED  
**November 9, 2012**

REVISED

SHEET NO.  
**22 of 220**

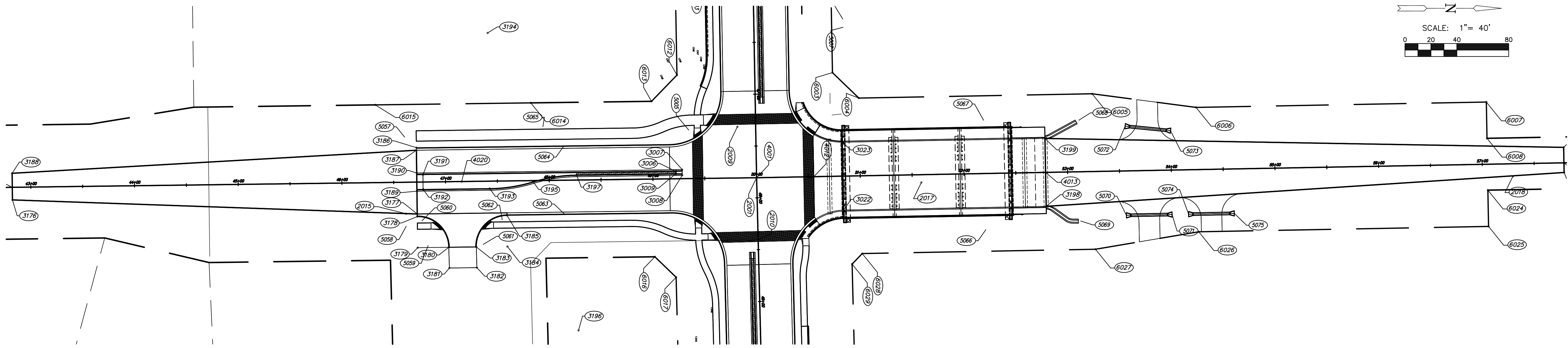

SURVEY CONTROL POINT TABLE			
POINT NUMBER	NORTHING	EASTING	DESCRIPTION
2000	1687826.7945	1599604.7539	SEC COR
2001	1687874.6913	1602240.5972	SEC COR
2002	1690506.6391	1602192.0134	SEC COR
2003	1685231.0100	1602274.6300	SEC COR
2004	1690680.4910	1607442.5085	SEC COR
2005	1688038.3719	1607457.3052	SEC COR
2006	1688114.4011	1609976.0525	SEC COR
2007	1687844.4050	1601204.1720	PKN
2008	1687855.2660	1601859.1900	PKN
2009	1687856.1600	1602191.4400	MKEC DP
2010	1687876.3960	1602300.5200	1/2" BAUGHMAN
2011	1687859.7590	1603948.1190	MKEC DP
2012	1687615.1350	1603692.6740	BM-15
2013	1687530.8850	1602999.9740	BM
2014	1687570.6300	1602643.8200	MKEC DP
2015	1687536.6100	1602275.3000	MKEC DP
2016	1687108.4790	1602223.9690	MKEC DP
2017	1688033.6010	1602245.1950	BM
2018	1688604.0600	1602239.3100	MKEC DP
2019	1687872.0860	1604059.3310	BM
2020	1687942.1780	1604260.5130	MKEC DP
2021	1687903.0380	1604806.3990	BM
2022	1687958.7319	1604821.9639	MKEC DP
2023	1687903.4375	1605151.8115	BM
2024	1687972.5596	1605255.2414	MKEC DP
2025	1687886.9738	1605901.9348	BM
2026	1687960.3150	1605926.3350	MKEC DP
2027	1687917.5680	1606359.9020	BM
2028	1687979.8310	1606392.6210	PKN
2029	1687969.4439	1606798.9811	MKEC DP
2030	1687975.4970	1607392.9820	MKEC DP
2031	1687995.5040	1607497.5530	BM

PAVING POINT TABLE			
POINT NUMBER	NORTHING	EASTING	DESCRIPTION
3006	1687796.9301	1602234.5977	BC-ISLAND
3007	1687802.9071	1602232.7706	HE-ISLAND
3008	1687802.9779	1602238.2701	HE-ISLAND
3009	1687796.9558	1602236.5975	BC-ISLAND
3022	1687958.5315	1602271.8052	RAIL
3023	1687957.3226	1602206.3163	RAIL
3176	1687157.0068	1602261.9835	PV EDGE
3177	1687547.3867	1602275.5632	PV EDGE
3178	1687547.4189	1602278.0630	PC
3179	1687547.8050	1602308.0605	RP
3180	1687577.8025	1602307.6744	PT
3181	1687578.4109	1602327.6682	PV EDGE
3182	1687604.9397	1602327.3267	PV EDGE
3183	1687604.3616	1602307.3325	PC
3184	1687634.3591	1602306.9463	RP
3185	1687633.9730	1602276.9488	PT
3186	1687546.5629	1602211.5685	BC
3187	1687546.5950	1602214.0683	PV EDGE
3188	1687156.6763	1602236.3130	PV EDGE
3189	1687547.1035	1602253.5650	HE-ISLAND
3190	1687546.8782	1602236.0665	HE-ISLAND
3191	1687552.9003	1602237.7391	BC-ISLAND
3192	1687553.0805	1602251.7380	BC-ISLAND
3193	1687617.2201	1602250.9123	PC-ISLAND
3194	1687615.2893	1602100.9247	RP-ISLAND
3195	1687659.1394	1602244.3721	PCC-ISLAND
3196	1687702.9895	1602387.8196	RP-ISLAND
3197	1687701.0587	1602237.8320	PT-ISLAND
3198	1688153.9982	1602268.1970	PV EDGE
3199	1688152.7893	1602202.7081	PV EDGE
3200	1688653.0573	1602211.3091	PV EDGE
3201	1688653.5044	1602235.5282	PV EDGE

PAVING BASELINE CONTROL TABLE			
POINT NUMBER	NORTHING	EASTING	DESCRIPTION
4000	1687861.7648	1601529.2314	BASELINE
4001	1687874.6913	1602240.5972	BASELINE
4002	1687899.6361	1603233.4950	BRIDGE APPROACH
4003	1687906.3556	1603500.9605	BRIDGE APPROACH
4004	1687916.1559	1603891.0484	INTERSECTION
4005	1687939.6639	1604826.7574	INTERSECTION
4006	1687940.5900	1604863.6200	BASELINE
4007	1687979.6526	1605899.7641	INTERSECTION
4008	1687982.2879	1605969.6661	INTERSECTION
4009	1688013.3527	1606793.6648	INTERSECTION
4010	1688037.7350	1607440.4104	BASELINE
4011	1687156.8504	1602249.8382	BASELINE
4012	1687929.9319	1602239.5775	BRIDGE APPROACH
4013	1688153.4178	1602235.4521	BRIDGE APPROACH
4014	1688653.3326	1602226.2241	BASELINE
4015	1687996.9327	1606358.1227	INTERSECTION
4016	1687800.2317	1603893.9608	PC BASELINE
4017	1687797.0923	1603769.0002	RP BASELINE
4018	1687708.1383	1603856.8193	PT BASELINE
4019	1687683.9549	1603832.3234	BASELINE
4020	1687590.2679	1602244.2587	INTERSECTION

RIGHT OF WAY POINT TABLE			
POINT NUMBER	NORTHING	EASTING	DESCRIPTION
6000	1687918.1116	1601327.6403	PROP RW
6001	1687926.9595	1601814.5600	PROP RW
6002	1687943.7738	1601914.2666	PROP RW
6003	1687947.8617	1602139.2295	PROP RW
6004	1687973.3116	1602163.7640	PROP RW
6005	1688198.2733	1602159.6113	PROP RW
6006	1688298.5288	1602172.7633	PROP RW
6007	1688578.4894	1602167.5954	PROP RW
6008	1688579.1370	1602202.5894	PROP RW
6009	1687799.6911	1601415.6543	PROP RW
6010	1687806.9797	1601816.7580	PROP RW
6011	1687793.7990	1601917.0150	PROP RW
6012	1687797.8796	1602141.5781	PROP RW
6013	1687773.3359	1602166.8958	PROP RW
6014	1687656.8992	1602168.3947	PROP RW
6015	1687506.9116	1602170.3255	PROP RW
6016	1687776.5777	1602316.8665	PROP RW
6017	1687797.0780	1602336.6023	PROP RW
6018	1687805.1763	1602658.9457	PROP RW
6019	1687825.1762	1602658.6893	PROP RW
6020	1687834.7476	1603039.6677	PROP RW
6021	1687836.0033	1603089.6520	PROP RW
6022	1687854.9191	1603842.5707	PROP RW
6023	1687789.0219	1603844.2262	PROP RW
6024	1688579.9898	1602252.5822	PROP RW
6025	1688580.6358	1602287.5762	PROP RW
6026	1688301.1353	1602292.7356	PROP RW
6027	1688201.5268	1602309.5768	PROP RW
6028	1687976.5602	1602313.7296	PROP RW
6029	1687966.8128	1602323.9112	PROP RW
6030	1687997.6307	1603550.5825	PROP RW
6031	1688005.7235	1603872.7051	PROP RW
6032	1687965.7361	1603873.7097	PROP RW
6033	1687990.5964	1604862.8464	PROP RW
6034	1688013.0502	1605458.4406	PROP RW