

**CENTRAL AVENUE
IMPROVEMENTS FROM
135TH ST. W. TO 19TH ST. W.**

**CENTRAL AVE
BRIDGE
CONSTRUCTION
LAYOUT**

SHEET TITLE
472-84017
PROJECT NUMBER

DESIGN BY
JRA

DRAWN BY
DMU

CHECKED BY
KJS

ISSUED
November 9, 2012

REVISED

SHEET NO.
89 of 220

DRAINAGE DATA

Drainage Area	3.1	Sq. Mi.
Design Frequency	100	Years
Design Discharge (Q ₁₀₀)	10,257	cfs
Design High Water Elevation	1346.2	Ft.
Change in Design Backwater	0.4	Ft.
Design Backwater Elevation	1345.8	Ft.
Overtopping Elevation (Sta. 63+80)	1348.3	Ft.
Overtopping Discharge	> 15,548	cfs
Overtopping Frequency	> 500	Years
Discharge at Q ₁₀₀	10,257	cfs
Change in Backwater at Q ₁₀₀	0.4	Ft.
Backwater Elevation at Q ₁₀₀	1346.2	Ft.
Historic High Water Elevation	Unknown	
Ordinary High Water Elevation	1340.8	Ft.
Total Waterway Provided	1,875	Sq. Ft.
Design Waterway Provided	1,800	Sq. Ft.
Estimated Ordinary High Water Discharge	3,427	cfs

The thermal movement at the abutment is ± 1/4"

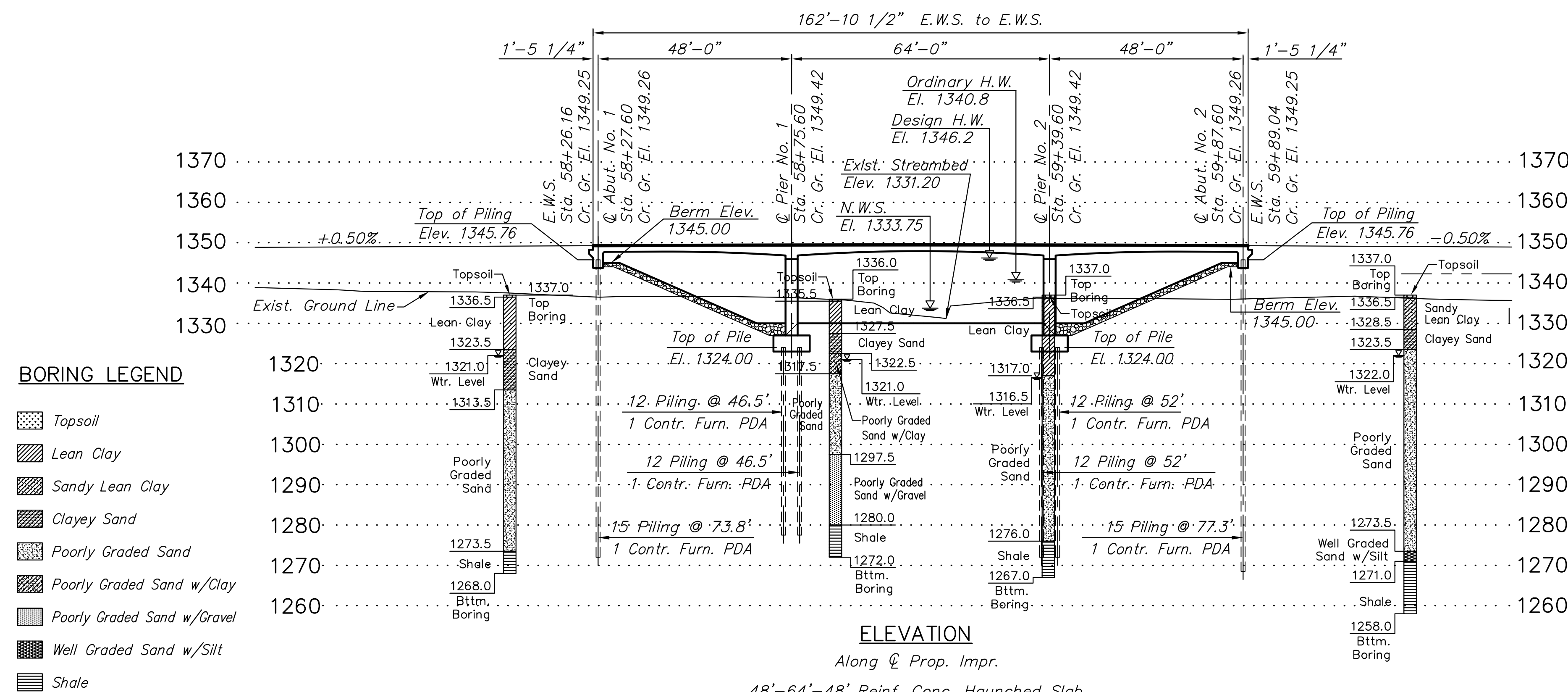

BORING LEGEND

- Topsoil
- Lean Clay
- Sandy Lean Clay
- Clayey Sand
- Poorly Graded Sand
- Poorly Graded Sand w/Clay
- Poorly Graded Sand w/Gravel
- Well Graded Sand w/Silt
- Shale

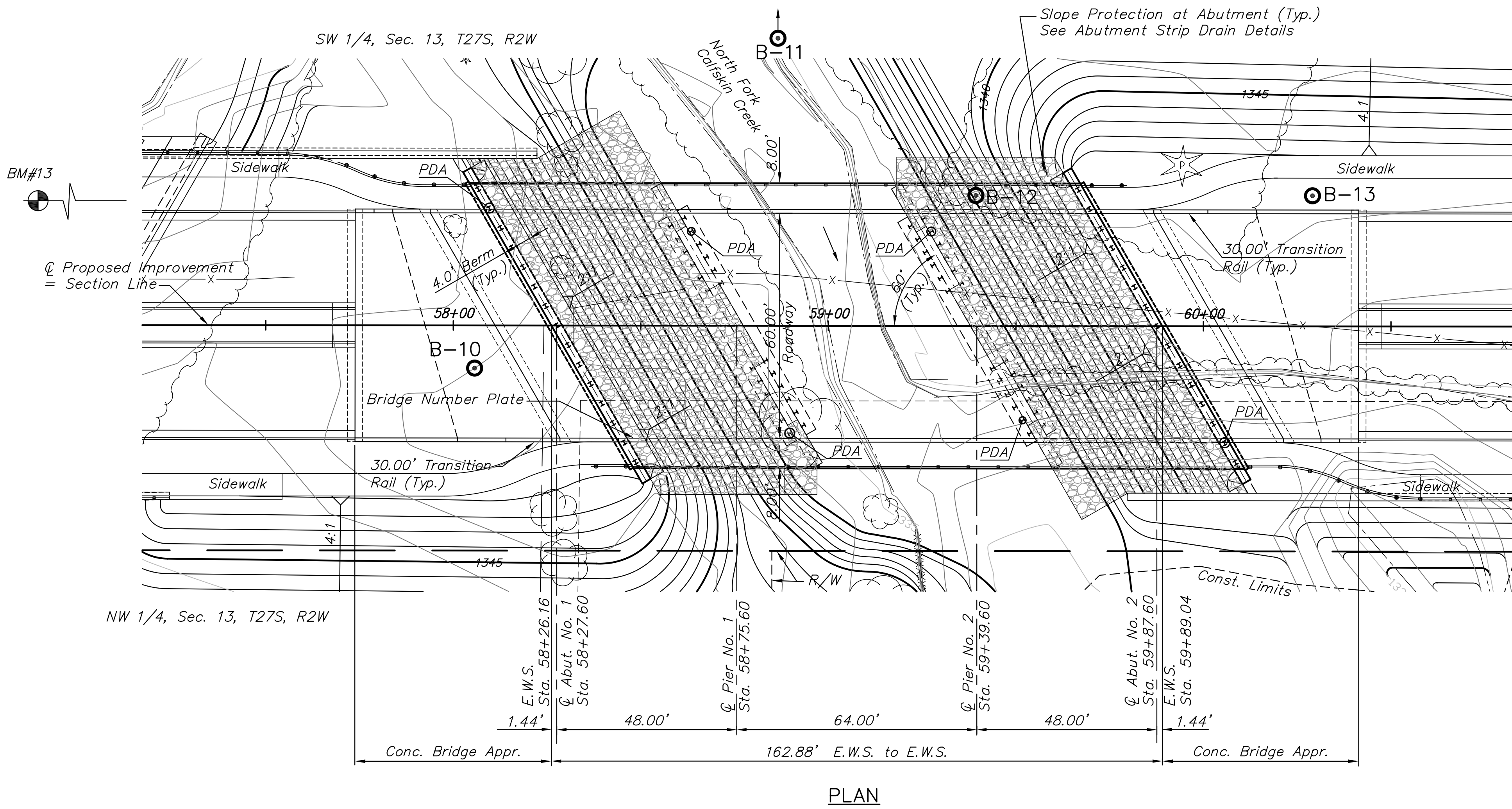

BM#13 City of Wichita benchmark disc on Northeast corner of 135th Street West and Central to the East, 33' North of centerline Central and 26' East of centerline 135th St. West. ϕ Sta. 48+06.62, 33.0' Lt. Elev. = 1347.40 (NAVD88)(159.50)

BM#15 City of Wichita benchmark disc in hub guard on Southeast corner of R.C.B. under Central, 693' East of centerline Rainbow Lake Road and 17' South of centerline Central. ϕ Sta. 62+25.71, 1377.08' Rt. Elev. = 1344.88 (NAVD88)(156.98)

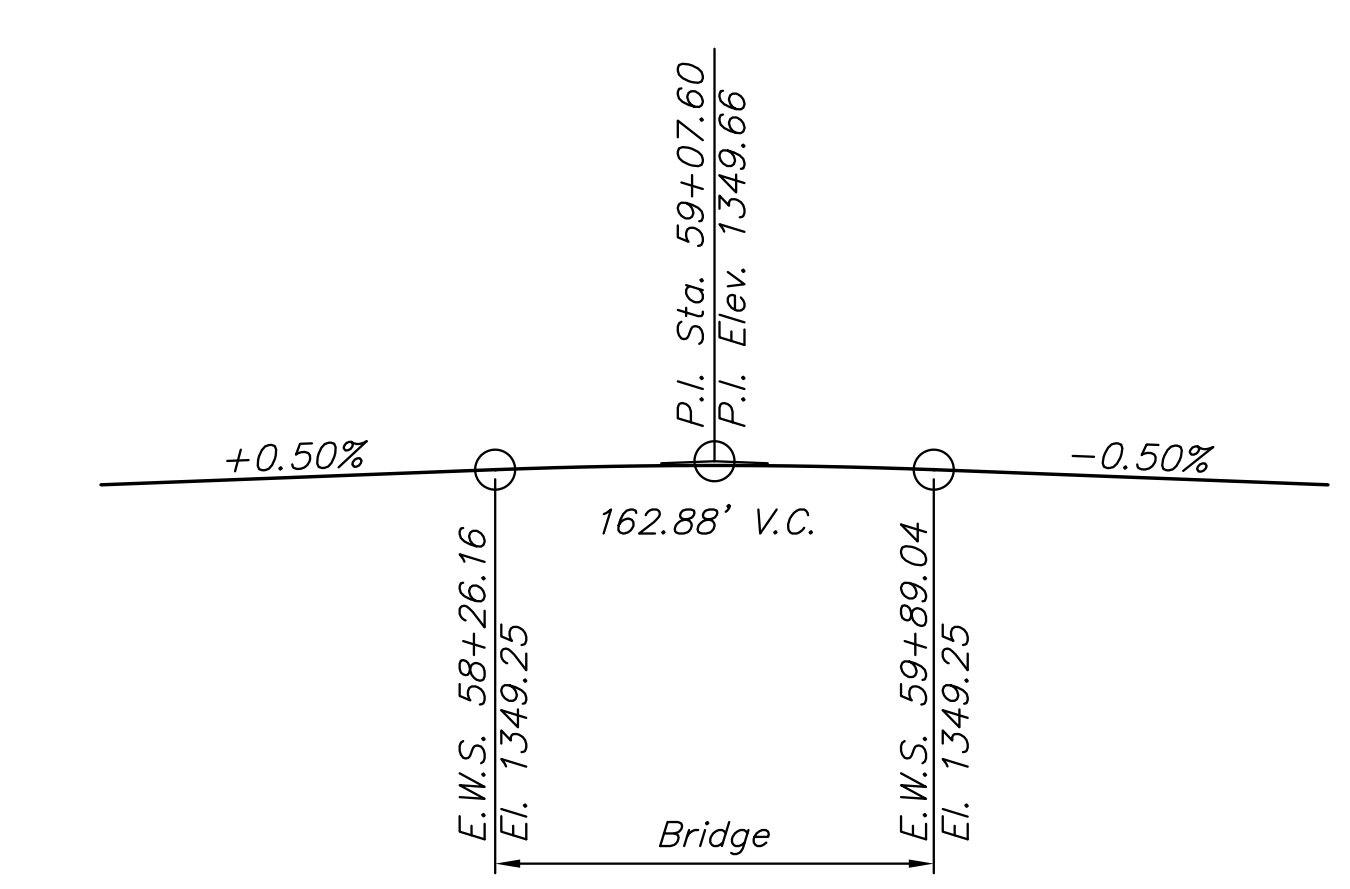

PLOTED: Wednesday, November 14, 2012 @ 02:42PM

J:\Civil\04238.dwg Bridge\04238LAY_Central.dwg