

STATE	PROJECT NO.	YEAR	SHEET NO.	SHEETS
KANSAS	87 N-0351-01	2012	94	220

MKEC
ENGINEERING
CONSULTANTS, INC.

411 N. WEBB ROAD
WICHITA, K.S. 67206
316-684-9600

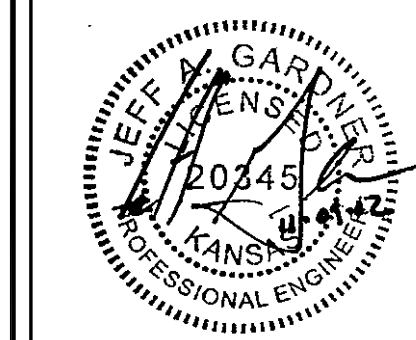

**CENTRAL AVENUE
IMPROVEMENTS FROM
135TH ST. W. TO 119TH ST. W.**

**CENTRAL AVE
BRIDGE PIER
CONC. LAYOUT
DETAIL 2**

SHEET TITLE
472-84017
PROJECT NUMBER

DESIGN BY: JAG
DRAWN BY: DMU
CHECKED BY: KJS

ISSUED
November 9, 2012

REVISED

SHEET NO.
94 of 220

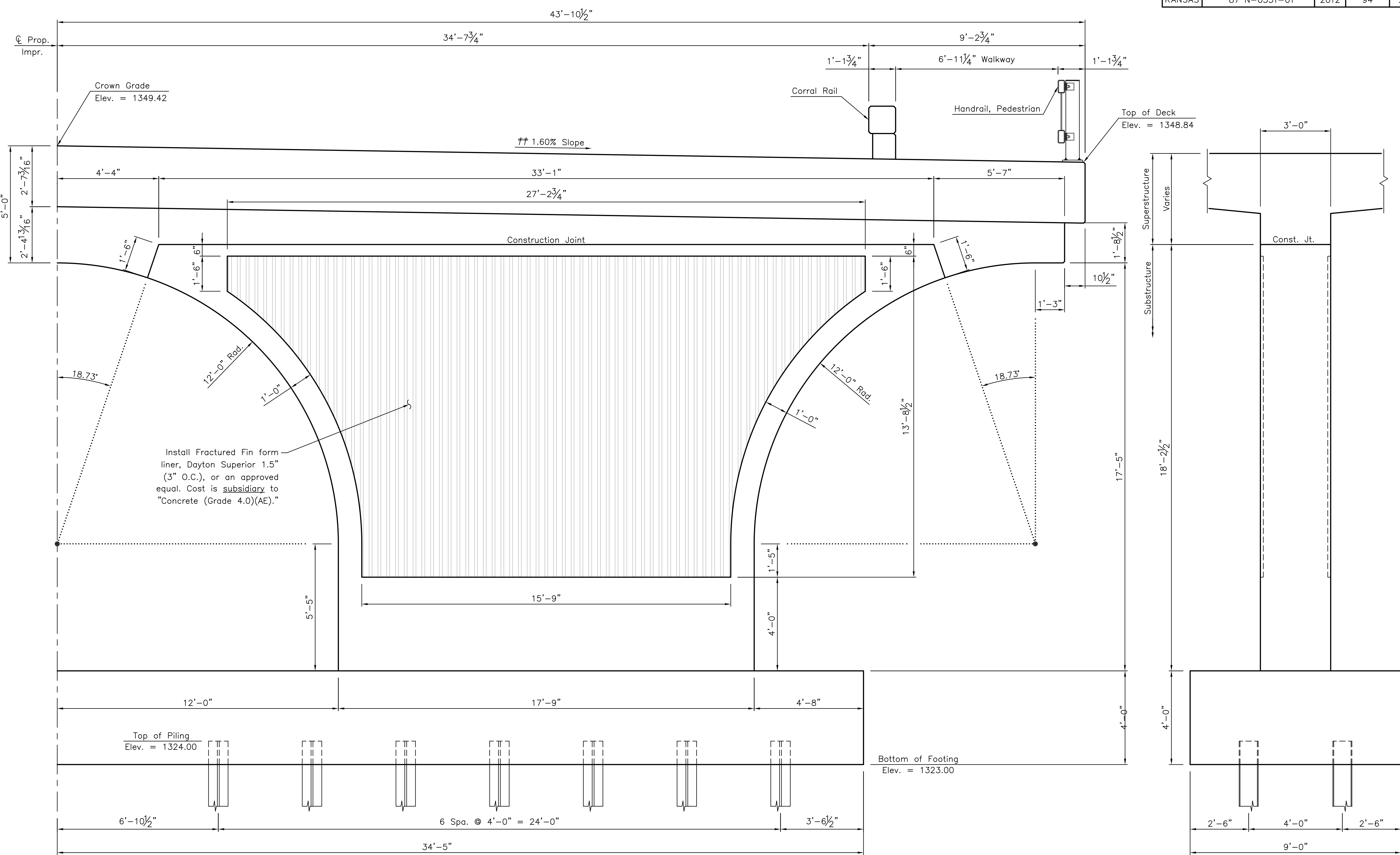

Install Fractured Fin form liner, Dayton Superior 1.5" (3" O.C.), or an approved equal. Cost is subsidiary to "Concrete (Grade 4.0)(AE)."

HALF ELEVATION

(Measured Along ϕ Pier)
(Looking Up Station, Pier No. 2)
(Looking Down Station, Pier No. 1)
** Cross slope perpendicular to ϕ Prop. Impr.

PLOTTED: Wednesday, November 14, 2012 @ 02:43PM

J:\Civil\04238\Draws\Bridge\04238PIER2_Central.dwg