

PROJECT NO.	YEAR	SHEET NO.	TOTAL SHEETS
472-84817 PHASE II	2011	19	93

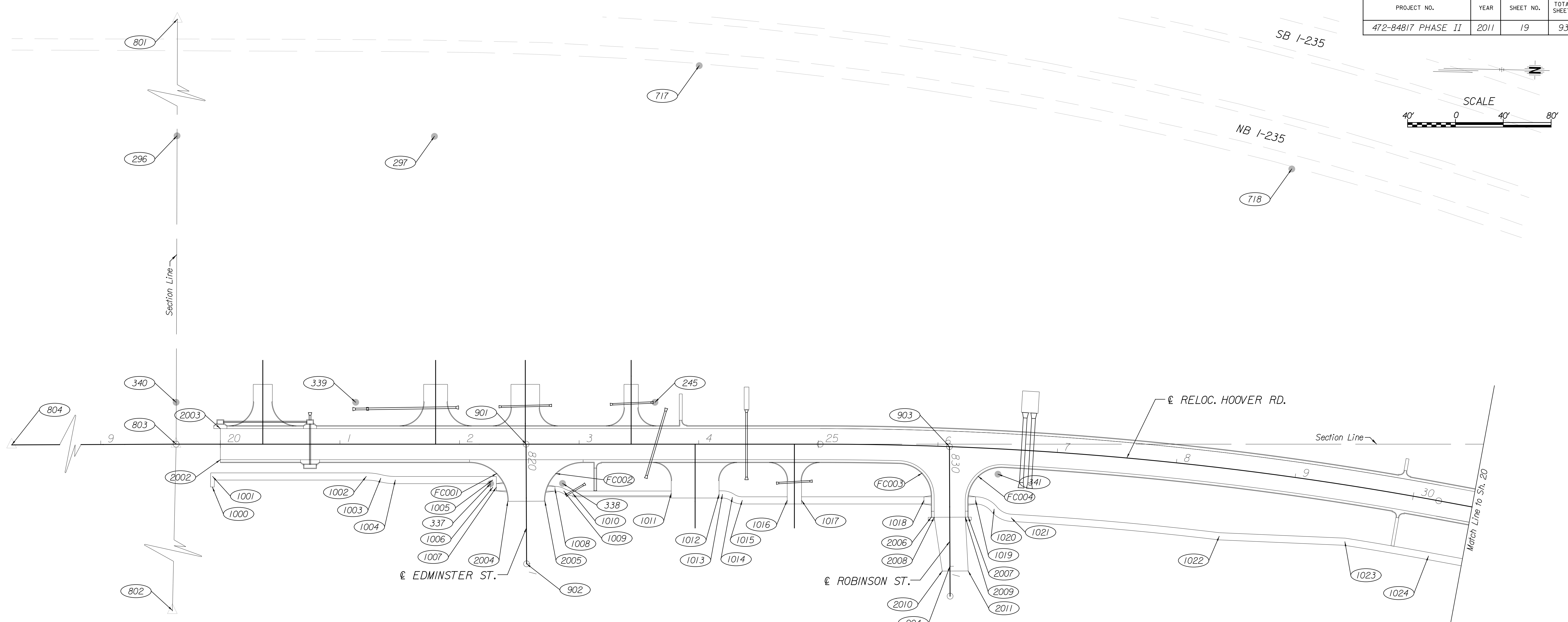

CONTROL POINTS					
POINT NO.	NORTH COORDINATE	EAST COORDINATE	STATION	OFFSET	DESCRIPTION
245	1,691,688.9813	1,628,452.7572	23+63.39	34.98' Lt.	IRP
295*	1,690,823.0135	1,628,246.6864	15+03.09	261.23' Lt.	IRP
296	1,691,284.7935	1,628,238.3801	19+63.79	257.80' Lt.	IRP
297	1,691,499.9790	1,628,234.3415	21+79.02	257.32' Lt.	RWM
337	1,691,553.0338	1,628,523.5995	22+25.98	32.99' Rt.	IRP
338	1,691,613.1386	1,628,522.1280	22+86.11	32.78' Rt.	IRP
339	1,691,438.8214	1,628,457.9723	21+13.18	35.02' Lt.	IRP
340	1,691,288.6937	1,628,461.1548			IRP
341	1,691,977.0072	1,628,506.7853	26+51.40	21.18' Rt.	IRP
354*	1,691,981.9010	1,629,111.9027	26+82.14	625.71' Rt.	IRP
355*	1,691,920.1863	1,629,038.1201	26+01.72	553.69' Rt.	IRP
356*	1,691,918.5719	1,628,978.1589	25+98.75	493.76' Rt.	IRP
357*	1,691,978.8245	1,628,986.8955	26+71.99	500.93' Rt.	IRP
712*	1,691,628.3471	1,628,034.3878	23+11.56	454.53' Lt.	*4 bar
713*	1,690,852.7188	1,628,044.8018	15+37.91	462.29' Lt.	*4 bar
716*	1,691,035.9141	1,628,172.9866	17+17.79	329.49' Lt.	*4 bar
717	1,691,720.1159	1,628,170.6249	24+00.44	316.40' Lt.	*4 bar
718	1,692,217.2986	1,628,246.5394	28+64.49	255.20' Lt.	*4 bar
801	1,691,242.0864	1,625,853.9779	19+71.18	2642.57' Lt.	Center Corner of Sec. 15, T27S R1W
802	1,691,286.4111	1,631,149.4823	18+92.57	2652.41' Rt.	Center Corner of Sec. 14, T27S R1W
803	1,691,289.4497	1,628,589.9619	19+63.03	0.00' Rt.	W Corner fo Sec. 14, T27S R1W
804	1,688,676.5915	1,628,562.5638			SW Corner of Sec. 14, T27S R1W
901	1,691,582.0006	1,628,489.9939	820+00.00	0.00' Rt.	Edminster & Point
902	1,691,584.5269	1,628,589.9619	821+00.00	0.00' Rt.	Edminster & Point
903	1,691,935.9745	1,628,484.6080	830+00.00	0.00' Rt.	Robinson & Point
904	1,691,938.5009	1,628,584.5761	831+00.00	0.00' Rt.	Robinson & Point

NO.	Δ	R	T	L	E	CURVE DATA							
						P.C. COORDINATES		P.I. COORDINATES		P.T. COORDINATES		C.C. COORDINATES	
						NORTH	EAST	NORTH	EAST	NORTH	EAST	NORTH	EAST
FC001	89°45'22" Rt.	32.50'	32.36'	50.91'	13.36'	1,691,535.0280	1,628,505.9841	1,691,567.3827	1,628,505.3043	1,691,568.2003	1,628,537.6559	1,691,535.7107	1,628,538.4769
FC002	90°14'38" Rt.	32.50'	32.64'	51.19'	13.56'	1,691,598.2009	1,628,537.3024	1,691,597.3764	1,628,504.6741	1,691,630.0079	1,628,503.9885	1,691,630.6906	1,628,536.4813
FC003	88°25'24" Rt.	28.00'	27.24'	43.21'	11.06'	1,691,894.1003	1,628,499.2066	1,691,921.3402	1,628,499.2679	1,691,922.0284	1,628,526.4992	1,691,894.0373	1,628,527.2065
FC004	93°20'01" Rt.	28.00'	29.68'	45.61'	12.80'	1,691,952.1120	1,628,529.4275	1,691,951.3622	1,628,499.7585	1,691,981.0245	1,628,500.7353	1,691,980.1030	1,628,528.7201

COORDINATE TABLE					
POINT NO.	NORTH COORDINATE	EAST COORDINATE	STATION	OFFSET	DESCRIPTION
2002	1,691,326.6806	1,628,508.3612	20+00.00	13.00' Rt.	Edge of Pavement
2003	1,691,326.1344	1,628,482.3670	20+00.00	13.00' Lt.	Edge of Pavement
2004	1,691,567.7107	1,628,538.0729	22+40.35	47.77' Rt.	Edge of Curb
2005	1,691,598.7008	1,628,537.2897	22+71.35	47.64' Rt.	Edge of Curb
2006	1,691,921.9700	1,628,543.9807	25+96.41	59.57' Rt.	Edge of Curb
2007	1,691,952.9601	1,628,543.1976	26+28.04	58.24' Rt.	Edge of Curb
2008	1,691,924.4692	1,628,543.9176	25+98.96	59.48' Rt.	Edge of Pavement
2009	1,691,950.4609	1,628,543.2607	26+25.49	58.36' Rt.	Edge of Pavement
2010	1,691,932.1778	1,628,588.7371	26+07.57	104.18' Rt.	Edge of Pavement
2011	1,691,953.8171	1,628,588.1903	26+30.02	103.20' Rt.	Edge of Pavement

See Sh. No. 22 for Sidewalk Coordinate Table (Point Nos. 1000-1049)

Plotted on: Monday, October 24, 2011 09:31 AM
 Plot Queue: \\ovpwp00\PL\TBWLP
 Design File Name: \\ovpwp00\Jobs\4809\Hoover\CD\Drawings\Coordinate-geometry.dgn
 Plot Scale: 40,000,000,000,000 Pen Tables: \\ovpwp00\Jobs\4809\Hoover\CD\Drawings\Coordinate-geometry.dgn



*Point falls off sheet

CITY OF WICHITA
PUBLIC WORKS & UTILITIES
ENGINEERING DIVISION

COORDINATE GEOMETRY PLAN

CITY ENGINEER
JAMES L. ARMOUR, P.E., L.S.

PROJECT NUMBER	OCA NUMBER	DATE
472-84817 PHASE II	770005	11/2011

CITY ENGINEER'S OFFICE
CITY HALL - SEVENTH FLOOR
455 NORTH MAIN STREET
WICHITA, KANSAS 67202-1620
(316) 268-4501

DESIGN	DRAWN

SHEET
19 of 93

\\ovpwp00\Jobs\4809\Hoover\CD\Drawings\Coordinate-geometry.dgn