

PROJECT NO.	YEAR	SHEET NO.	TOTAL SHEETS
472-84817 PHASE II	2011	59	93

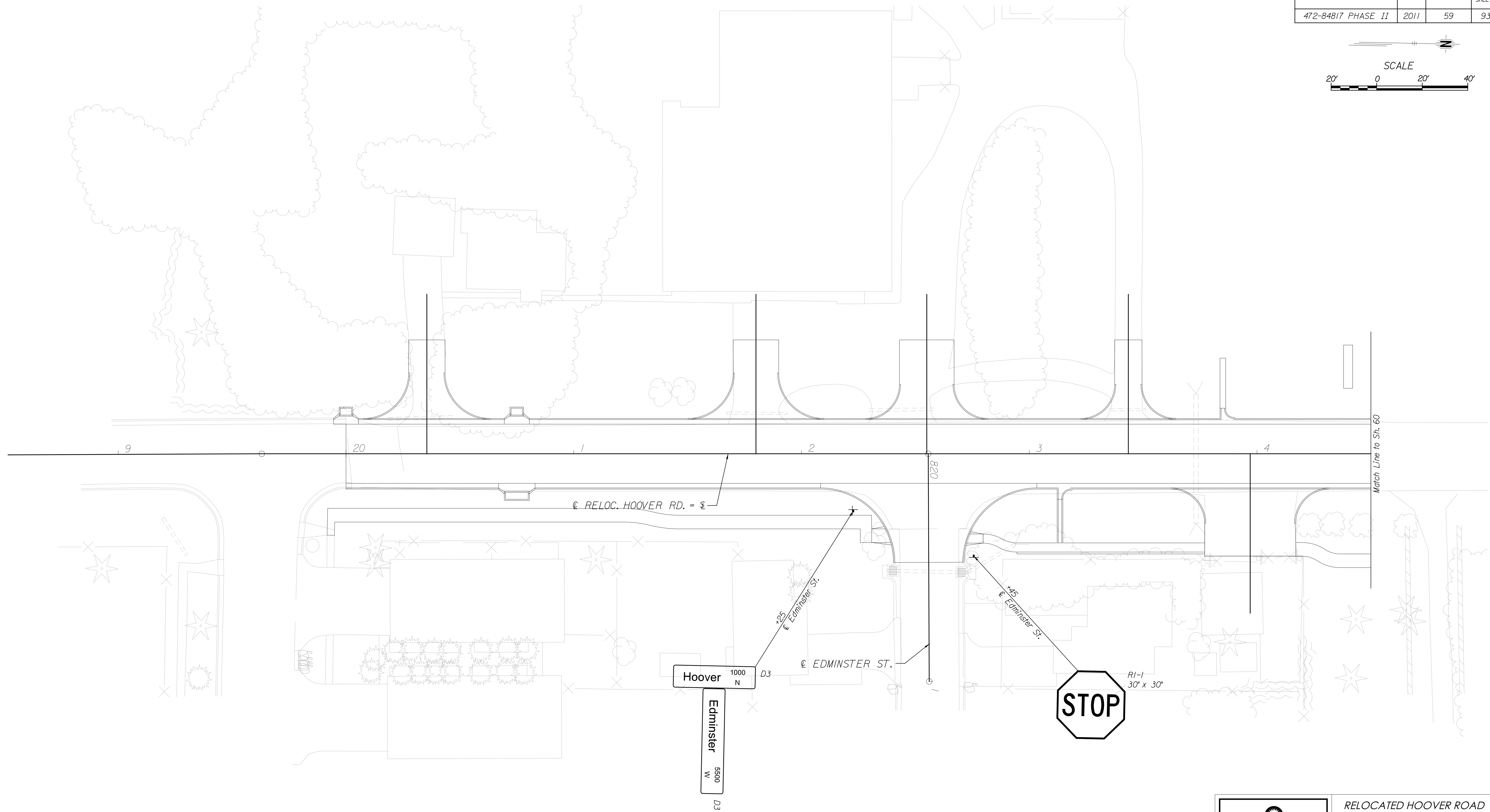

Plotted on: Monday, October 24, 2011 09:39 AM
 Plot Queue: \\ovp\00\PL\TBWLP
 Plot Scale: 20.000000:0.000000 Pen Tables: \\ovp\00\Jobs\4809\Common\Highway\Library\lib\pen\CC-22x36.pen
 Design Filename: \\ovp\00\Jobs\4809\Hoover\CD\Sign\Hvr_s Signs.dgn

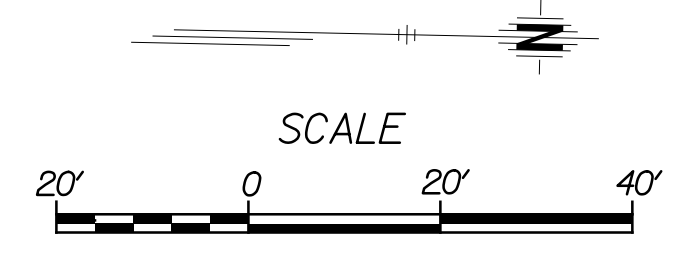

RELOCATED HOOVER ROAD SIGNING PLAN STA. 20+00 TO STA. 24+50		
CITY ENGINEER JAMES L. ARMOUR, P.E., L.S.		
PROJECT NUMBER	OCA NUMBER	DATE
472-84817 PHASE II	770005	11/2011
CITY ENGINEER'S OFFICE CITY HALL - SEVENTH FLOOR 455 NORTH MAIN STREET WICHITA, KANSAS 67202-1620 (316) 268-4501		DESIGN DRAWN SHEET 59 of 93

\\ovp\00\Jobs\4809\Hoover\CD\Sign\Hvr_s Signs.dgn