

PROJECT NO.	YEAR	SHEET NO.	TOTAL SHEETS
472-84817 PHASE II	2011	63	93

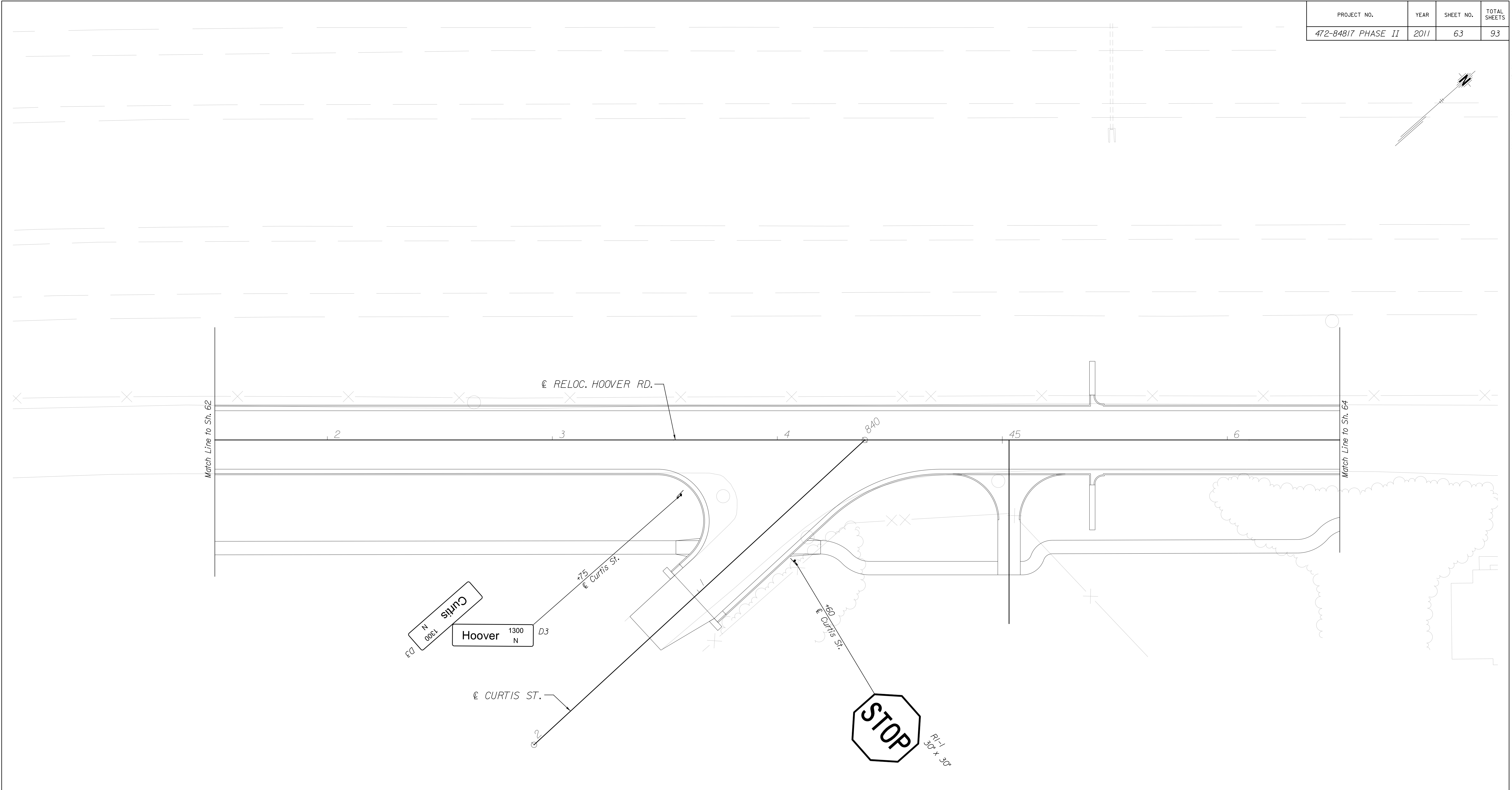

Plotted on: Monday, October 24, 2011 09:40 AM
 Plot Queue: \\ovp\00\PL\TBWLP
 Plot Scale: 20.000000:0.000000 Pen Tables: \\ovp\00\Jobs\4809\Common\Highway\Library\lob\pen\CC-22x35.pen
 Design Filename: \\ovp\00\Jobs\4809\Hoover\CD\Sign\hvr_signs.dgn



 CITY OF WICHITA PUBLIC WORKS & UTILITIES ENGINEERING DIVISION	RELOCATED HOOVER ROAD SIGNING PLAN STA. 41+50 TO STA. 46+50		
	CITY ENGINEER JAMES L. ARMOUR, P.E., L.S.		
	PROJECT NUMBER 472-84817 PHASE II	OCA NUMBER 770005	DATE 11/2011
	CITY ENGINEER'S OFFICE CITY HALL - SEVENTH FLOOR 455 NORTH MAIN STREET WICHITA, KANSAS 67202-1620 (316) 268-4501		DESIGN DRAWN SHEET 63 of 93