

PROJECT NO.	YEAR	SHEET NO.	TOTAL SHEETS
472-84817 PHASE II	2011	69	93

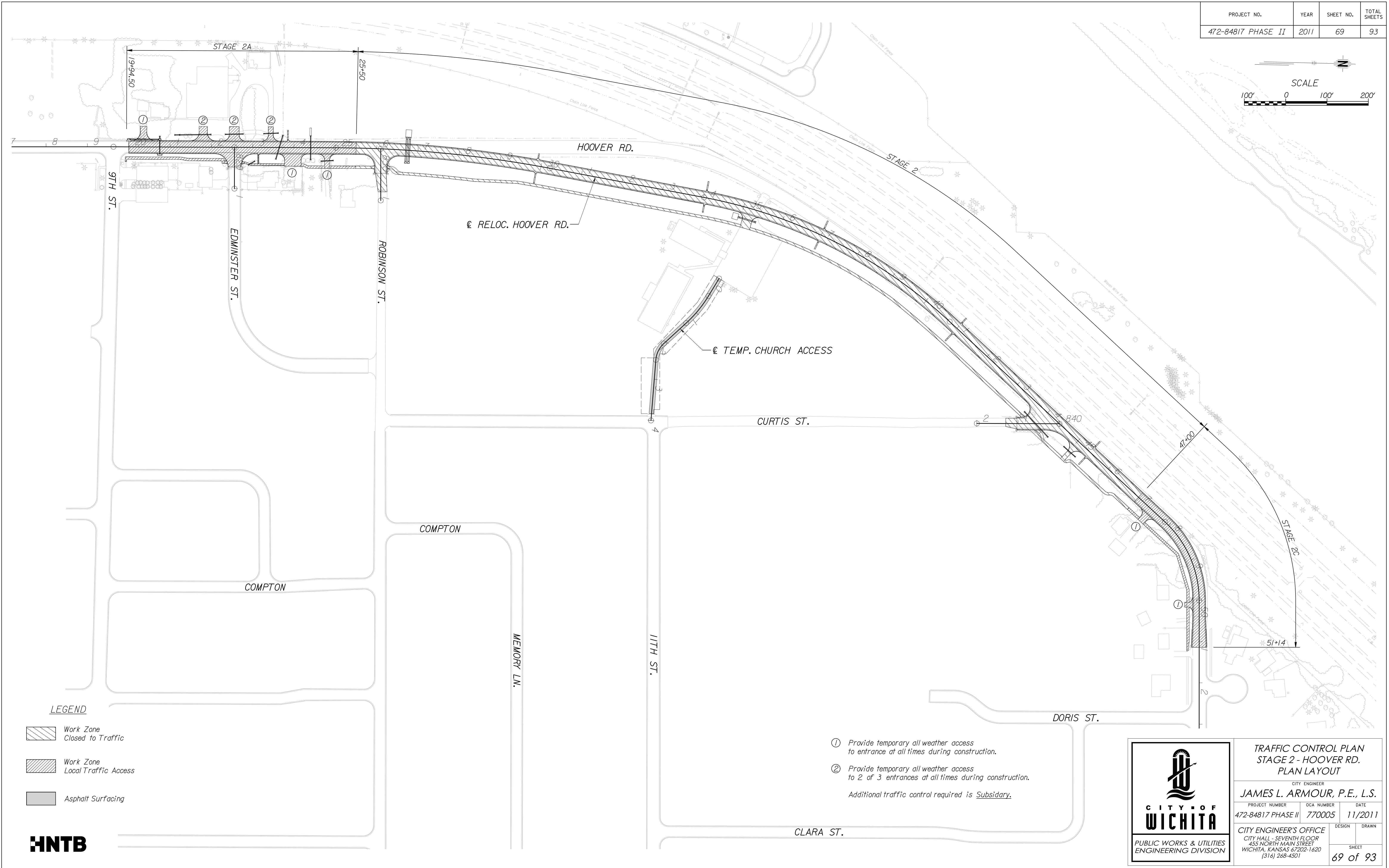
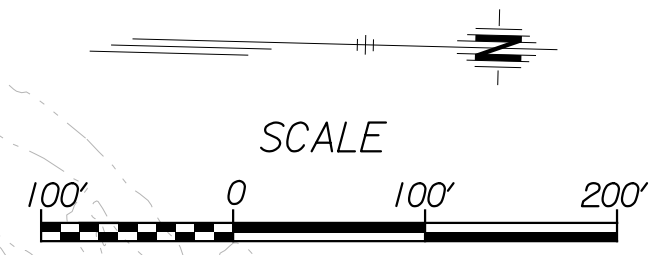

LEGEND

- Work Zone
Closed to Traffic
- Work Zone
Local Traffic Access
- Asphalt Surfacing

- ① Provide temporary all weather access to entrance at all times during construction.
 - ② Provide temporary all weather access to 2 of 3 entrances at all times during construction.
- Additional traffic control required is Subsidiary.



TRAFFIC CONTROL PLAN STAGE 2 - HOOPER RD. PLAN LAYOUT		
<small>CITY ENGINEER</small> JAMES L. ARMOUR, P.E., L.S.		
<small>PROJECT NUMBER</small> 472-84817 PHASE II	<small>OCA NUMBER</small> 770005	<small>DATE</small> 11/2011
<small>CITY ENGINEER'S OFFICE</small> CITY HALL - SEVENTH FLOOR 455 NORTH MAIN STREET WICHITA, KANSAS 67202-1620 (316) 268-4501		<small>DESIGN</small> <small>DRAWN</small> <small>SHEET</small> 69 of 93

Plotted on: Wednesday, December 05, 2012 09:23 AM
 kschonaker Plot Queue: \\ovpwp00\ovp\hntb\p
 Plot Scale: 80.000000:0.000000 Pen Table: \\ovpwp00\Jobs\4809\Comment\Highway\Library\Plot\pen\CC_22x35.pen
 Design Filename: \\ovpwp00\Jobs\4809\Hoover\CD\Icon\Hvr_Tcon.dgn

\\ovpwp00\Jobs\4809\Hoover\CD\Icon\Hvr_Tcon.dgn