

- LEGEND**
- PP UTILITY POLE
  - LP LIGHT POLE
  - DM DEAD MAN
  - WM WATER METER
  - WV WATER VALVE
  - GV GAS VALVE
  - SS MH SANITARY SEWER MANHOLE
  - SWS MH STORM SEWER MANHOLE

FIRE HYDRANTS REQUIRED			
STATION	BURY LINE ELEVATION	TOP OF PIPE ELEVATION	FIRE HYDRANT BURY REQUIRED*
23+74.6	108.38	104.50	4.5'
WL NO. 1, STA. 23+52.71			

(FOR FIRE HYDRANT ASSEMBLY, SEE DETAIL SHEET 27)

**AS-BUILT**  
WATER LINE NO. 1

REMOVE & REPLACE WHEELCHAIR RAMP, THIS SHEET = 4 EA  
 REMOVE & REPLACE CONCRETE SIDEWALK IN KIND, THIS SHEET = 8 LF  
 REMOVE & REPLACE CONCRETE DRIVE IN KIND, THIS SHEET = 46 LF  
 REMOVE & REPLACE CONCRETE PAVEMENT IN KIND, THIS SHEET = 333 LF

- NOTES:**
- UNLESS OTHERWISE INDICATED, DIMENSIONS ARE MEASURED TO CENTERLINE OF FITTINGS IN PLAN VIEW AND TOP OF PIPE IN PROFILE VIEW.
  - WL NO. 1 BASELINE = CENTERLINE OF MCCORMICK AVENUE RIGHT-OF-WAY.
  - REFER TO SHEET 2, NOTE NO. 8, FOR DIRECTIONAL DRILLING REQUIREMENTS.

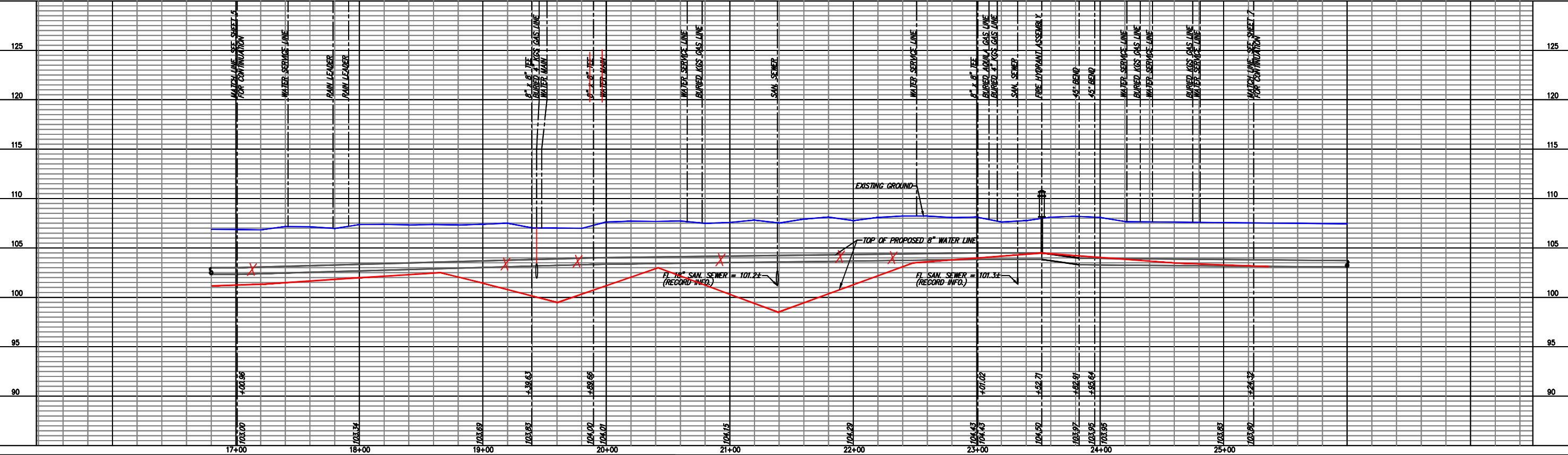

**YOUNG & ASSOCIATES, P.A.**  
Civil and Environmental Engineers

100 S. Georgia, Derby, KS 67037  
 Tele: (316) 798-2650 • Fax: (316) 798-4408 • Email: youngand@nemaha.com

Copyright 2006, by Young & Associates, P.A. All rights reserved. This drawing is the property of Young & Associates, P.A. and may not be reproduced in any form without the written permission of Young & Associates, P.A. The delivery of this drawing or copies thereof does not constitute a contract.

**WATER LINE NO. 1  
PLAN AND PROFILE**

McCormick Avenue Rehabilitation  
 City of Wichita, Sedgwick County, Kansas

PROJECT NO.	DATE	BY	APP.
06-228	2-15-07	DAS	DAS
		DESIGNED: DAS	CHECKED: CRT
		APPROVED:	