

- LEGEND**
- PP UTILITY POLE
  - LP LIGHT POLE
  - DM DEAD MAN
  - WM WATER METER
  - WV WATER VALVE
  - GV GAS VALVE
  - SS MH SANITARY SEWER MANHOLE
  - SWS MH STORM SEWER MANHOLE

**FIRE HYDRANTS REQUIRED**

STATION	BURY LINE ELEVATION	TOP OF PIPE ELEVATION	FIRE HYDRANT BURY REQUIRED*
WL NO. 2, STA. 6+89.67	105.38	102.00	4.0'

(FOR FIRE HYDRANT ASSEMBLY, SEE DETAIL, SHEET 27)

- NOTES:**
- UNLESS OTHERWISE INDICATED, DIMENSIONS ARE MEASURED TO CENTERLINE OF FITTINGS IN PLAN VIEW AND TOP OF PIPE IN PROFILE VIEW.
  - WL NO. 2 BASELINE = CENTERLINE OF VINE STREET RIGHT OF WAY.
  - REFER TO SHEET 2, NOTE NO. 8, FOR DIRECTIONAL DRILLING REQUIREMENTS.

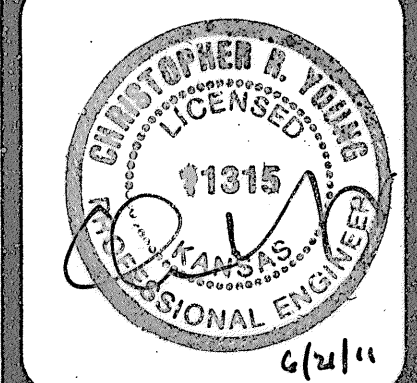
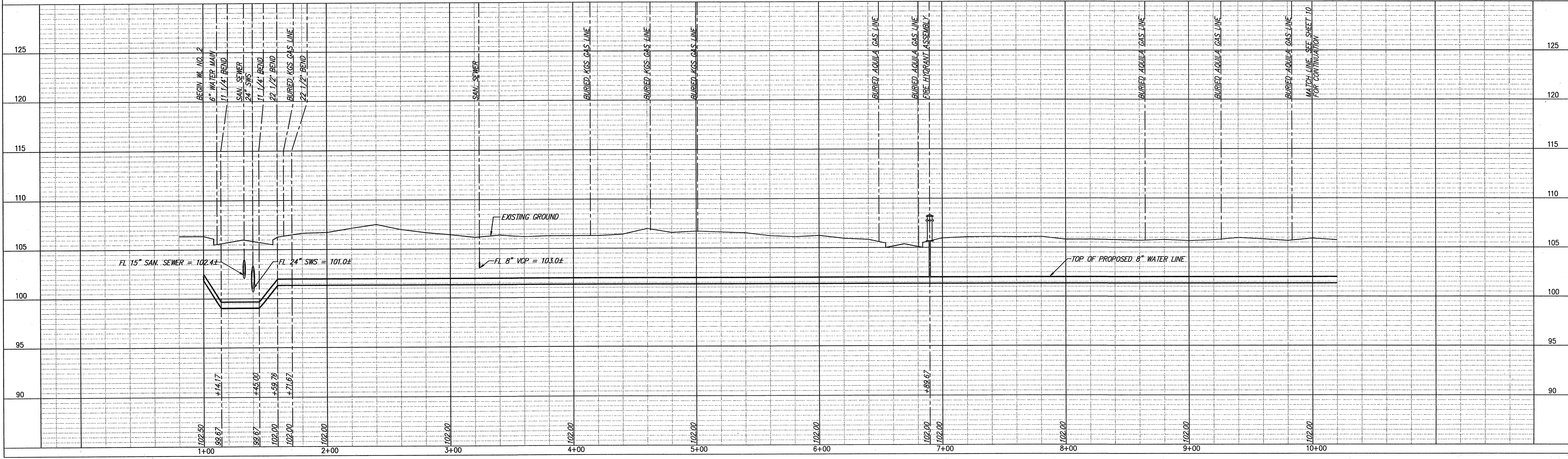

**YOUNG & ASSOCIATES, P.A.**  
 Civil and Environmental Engineers  
 100 S. Georgia, Derby, KS 67037  
 Phone: (316) 789-2532 Fax: (316) 789-4408  
 Email: youngpa@earthlink.net

Copyright 2006, by Young & Associates, P.A., all rights reserved. Prepared in the United States of America. This plan or profile is the property of Young & Associates, P.A. and may not be reproduced in any form without the specific written permission of Young & Associates, P.A. The plan and design is the property of Young & Associates, P.A. The liability of the engineer or engineer-in-charge shall not be limited by this seal.

**WATER LINE NO. 2  
 PLAN AND PROFILE**

**McCormicks Water Main Replacement**

City of Wichita, Sedgwick County, Kansas

PROJECT NO.	DATE	REVISIONS	BY	APP.
2-15-07				

DESIGNED: DAS  
 CHECKED: GRV  
 APPROVED: