

- Notes:
- 1.0 The pavement marking shall include 4" yellow single broken line along the center line of 29th St. N.
 - 2.0 Contractor shall salvage the existing posts and barbed wire fence and install new 5 strands barbed wire fence with 4 ft high T posts @ 15 ft spacing. The barbed wire fence shall be 12 1/2 gauge, 2 pt. barbs @ 4" spacing, class 1 galvanized or approved equal.

Curve	R	Δ	Curve Length
C1	600'	7.20°	82.70'

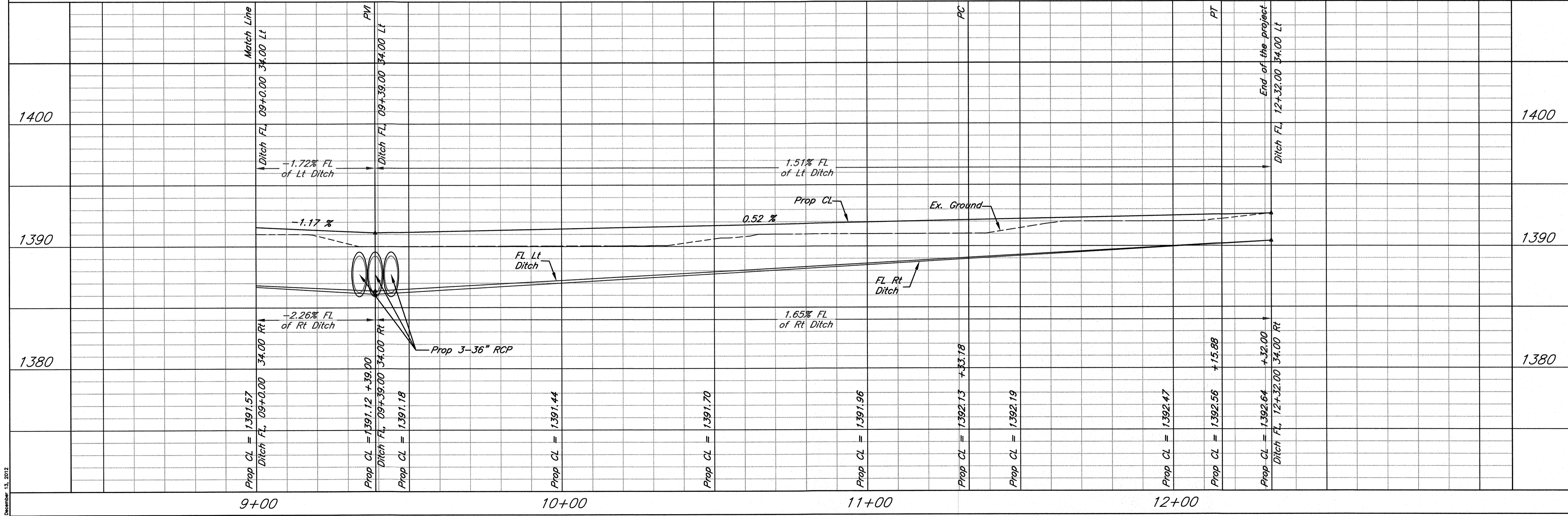

29th Street North
Paving Plan
Wichita, Kansas

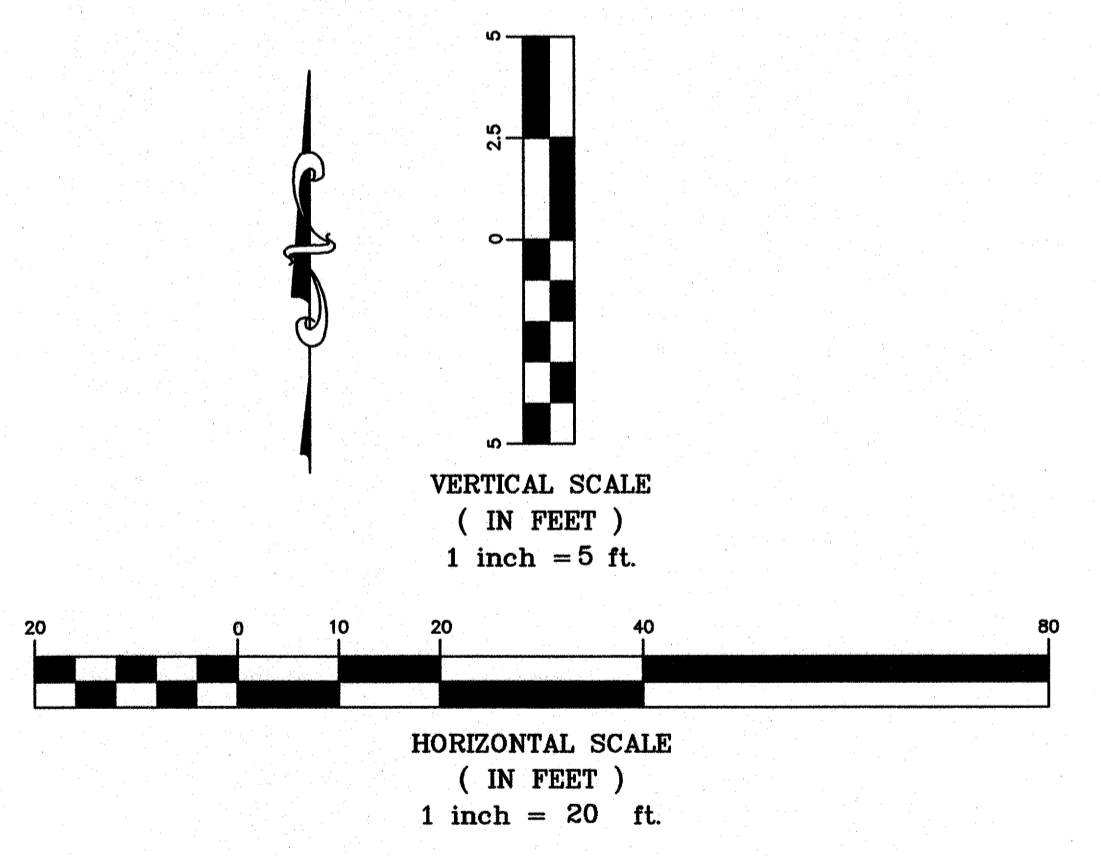

PROJECT NUMBER 472-84983			
KEM NO. 12078	FILE	DATE 10/2012	SHEET 4.0
DESIGN GP	DRAWN GP	REVISED	

November 13, 2012