

BENCHMARK:  
 BM #9 - Chiseled "□" on the North Curb Return of the Drive to 1341 W. Dora, 68' South and 16' East of the Centerlines of Dora and Martinson.  
 Elev. = 1292.58 (NAVD 88)

SCALE:  
 1" = 20' Horizontal  
 1" = 5' Vertical

CAUTION!  
 Existing  
 6" Water  
 2" Water  
 Crossings

CAUTION!  
 Existing  
 O/H Elec  
 Crossing

CAUTION!  
 Existing  
 Gas S/L  
 Crossing

N-9993.29, E-21846.03  
 Sta. 47+31.98, SWS Line 1  
 Construct MH Stack (4')  
 w/ Ring & Cover.  
 Top Elev. = 1290.41

CAUTION!  
 Existing  
 O/H Elec  
 8" SS  
 Crossings

N-10002.44, E-21718.42  
 Sta. 46+00.00, SWS Line 1 =  
 Sta. 0+00.00, SWS Line 1j  
 Construct MH Stack (4') w/  
 Ring & Cover.  
 Top Elev. = 1291.36

N-9983.36, E-21856.11  
 Sta. 47+46.13, SWS Line 1  
 Deflect 10' X 6' RCBC 44' 58' (Rt.)  
 Match Point

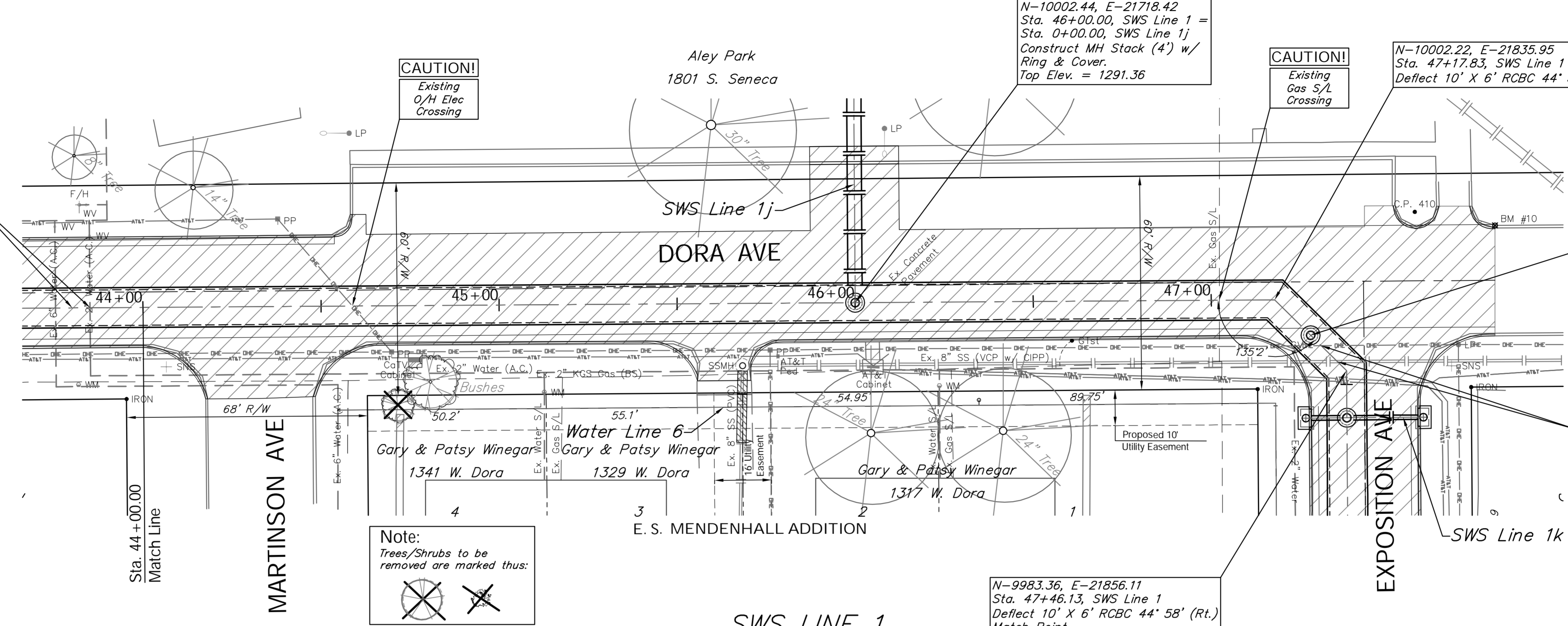

Note:  
 Trees/Shrubs to be  
 removed are marked thus:  
 X

Areas of Full Pavement  
 Removal & Replacement  
 are Indicated By:  
 [Hatched Box]

SWS LINE 1

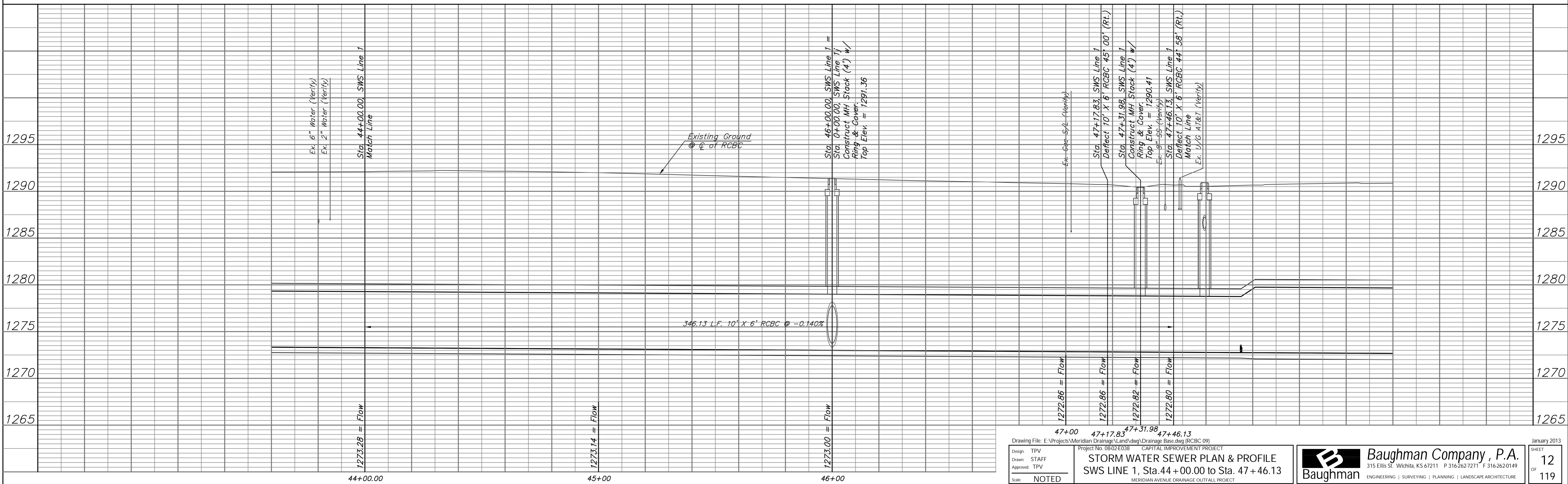

Drawing File: E:\Projects\Meridian Drainage\Land\dwg\Drainage\_Base.dwg (RCBC 09)  
 Project No: 0802E038 CAPITAL IMPROVEMENT PROJECT  
**STORM WATER SEWER PLAN & PROFILE**  
 SWS LINE 1, Sta. 44+00.00 to Sta. 47+46.13  
 MERIDIAN AVENUE DRAINAGE OUTFALL PROJECT  
 Design: TPV  
 Drawn: STAFF  
 Approved: TPV  
 Scale: NOTED

**Baughman Company, P.A.**  
 315 Ellis St., Wichita, KS 67211 P 316.262.1271 F 316.262.0149  
 ENGINEERING | SURVEYING | PLANNING | LANDSCAPE ARCHITECTURE

January 2013  
 SHEET  
 12  
 OF  
 119