

BENCHMARK:  
 BM #11 - Chiseled "C" on the West Curb Return of the Drive to the Seneca Village Townhouses, 15' South and 52' West of the Centerlines of May and Exposition. Elev. = 1291.76 (NAVD 88)

N-9365.55, E-21865.22  
 Sta. 53+65.79, SWS Line 1 =  
 Sta. 0+15.05, SWS Line 1/  
 Construct MH Stack (4') w/  
 Ring & Cover.  
 Top Elev. = 1291.24

N-9350.02, E-21880.99  
 Sta. 53+87.92, SWS Line 1  
 Deflect 10' X 7' RCBC 45° 00' (Lt.)

SCALE:  
 1" = 20' Horizontal  
 1" = 5' Vertical

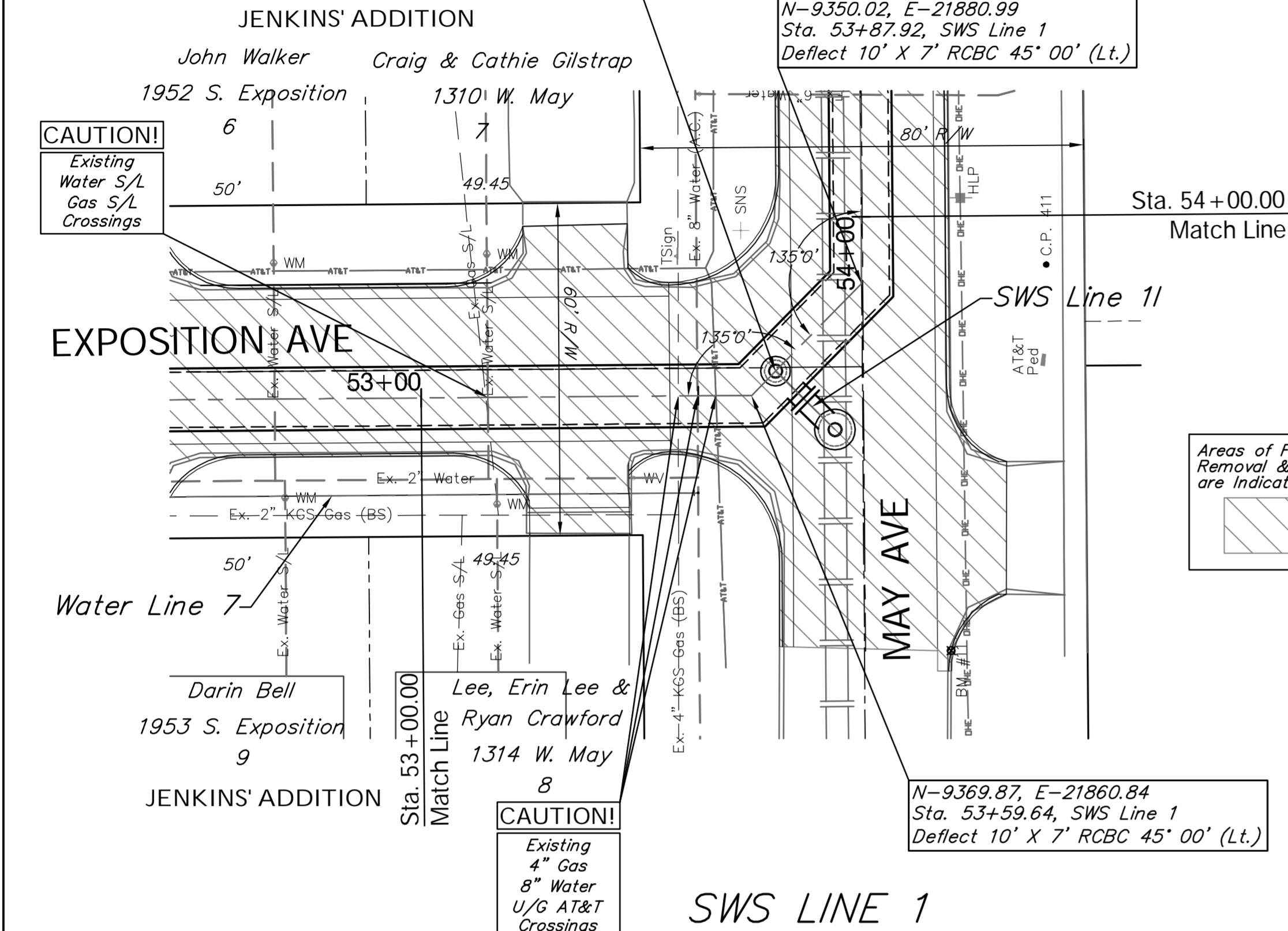

BENCHMARK:  
 BM #11 - Chiseled "C" on the West Curb Return of the Drive to the Seneca Village Townhouses, 15' South and 52' West of the Centerlines of May and Exposition. Elev. = 1291.76 (NAVD 88)

Remove Approx. 31 L.F. 15" RCP and 2 SWS Inlets. Cost to be SUBSIDIARY to the Lump Sum Bid Item "Removal of Existing Structures".

Remove Approx. 400 L.F. 48" RCP and 2 SWS Structures. Cost to be SUBSIDIARY to the Lump Sum Bid Item "Removal of Existing Structures".

N-9352.14, E-22159.00  
 Sta. 56+65.94, SWS Line 1  
 Construct MH Stack (4') w/ Ring & Cover. Install 15 L.F. 18" RCP (N) & Connect to Existing SWS. See Detail, Sheet 31. Top Elev. = 1290.89

N-9352.34, E-22185.27  
 Sta. 56+92.21, SWS Line 1  
 Deflect 10' X 7' RCBC 45° 00' (Rt.)

SCALE:  
 1" = 20' Horizontal  
 1" = 5' Vertical

