

BENCHMARK:
 BM #14 - Chiseled "I" on the Top of Curb at the South Property Line of MTA Addition on the West Side of McLean.
 Elev. = 1290.66 (NAVD 88)

Note:
 Trees/Shrubs to be removed are marked thus:

Install OSHA Restricted Access Signs on Either Side of Wingwall as Shown. See Detail, This Sheet. Cost of Signs to be SUBSIDIARY to the Lump Sum Bid Item "SWS Outfall at River".

N-8607.40, E-23579.86
 Sta. 75+40.04, End SWS Line 1
 End Cast-in-Place Reinf. Concrete Headwall and Wingwalls.

SCALE:
 1" = 20' Horizontal
 1" = 5' Vertical

The Contractor Shall Anchor the 2 Pre-cast RCBC Sections Adjacent to the Structure Together with the Cast-in-Place RCBC Section. The Cost Shall be SUBSIDIARY to the Installation of the RCBC Sections. Shops Drawings of the Anchors Shall be Provided to the Project Engineer Prior to Beginning Construction.

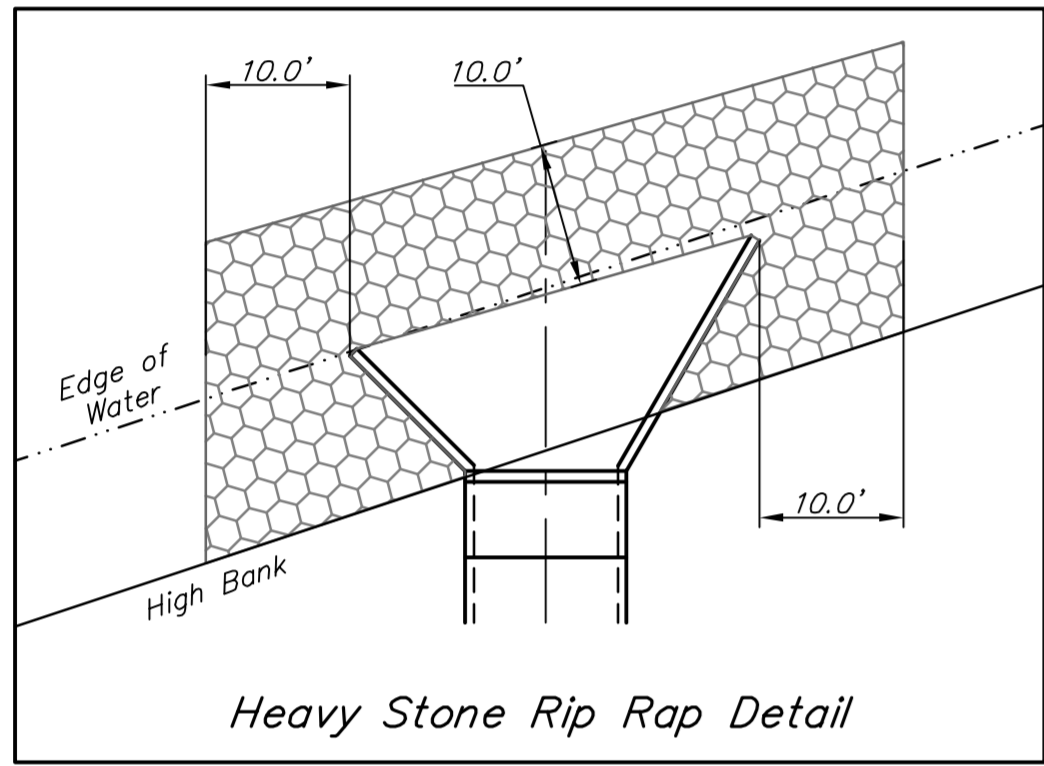

N-8805.16, E-23225.93
 Sta. 70+94.00, SWS Line 1
 Match Point

D-6111-18
 Gov. Lot 7
 City of Wichita

N-8768.78, E-23249.13
 Sta. 71+45.85, SWS Line 1
 End Construction of Debris Removal Structure. Begin Construction of Precast 10' X 8' RCBC Section.

N-8681.24, E-23292.91
 Sta. 72+43.74, SWS Line 1
 Construct MH Stack (4') w/ Ring & Cover. Deflect 10' X 8' RCBC 49' 00' (Lt.)
 Top Elev. = 1287.83

CAUTION!
 Existing 24" Water Crossing

Areas of Full Pavement Removal & Replacement are Indicated By:

The Contractor Shall Anchor the Last 3 Pre-cast RCBC Sections Together. The Cost Shall be SUBSIDIARY to the Installation of the RCBC Sections. Shops Drawings of the Anchors Shall be Provided to the Project Engineer Prior to Beginning Construction.



OSHA RESTRICTED ACCESS SIGN
 (20" X 14")
 2 REQUIRED

SWS LINE 1

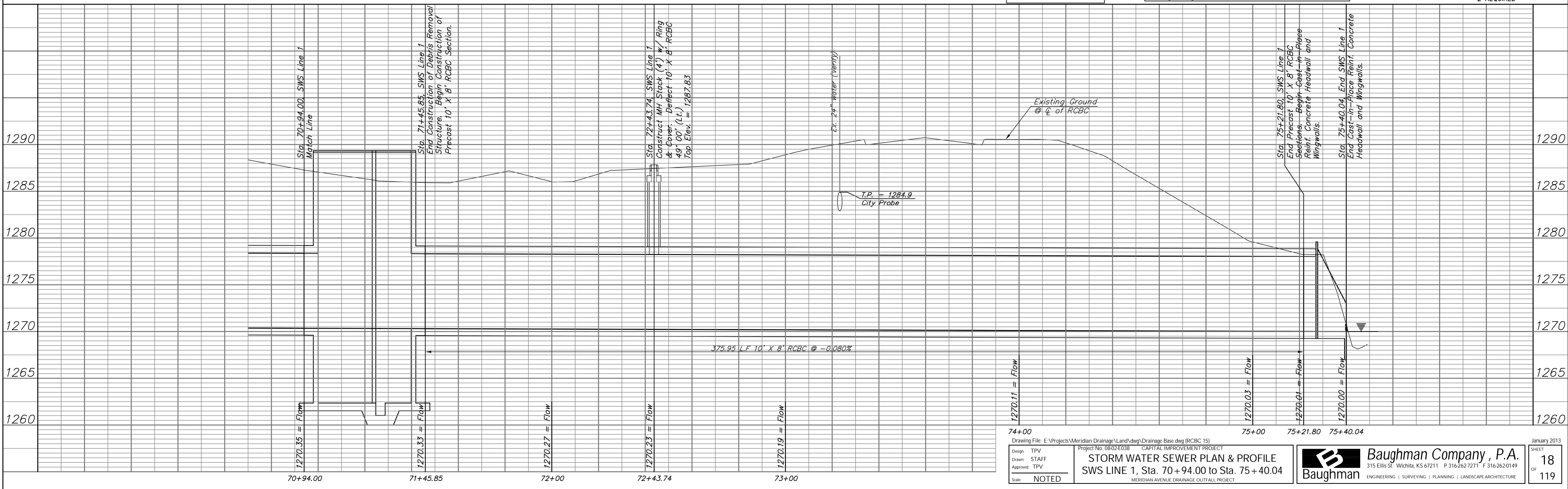

Drawing File: E:\Projects\Meridian Drainage\Land\dwg\Drainage Base.dwg (RCBC 15)
 Design: TPV
 Drawn: STAFF
 Approved: TPV
 Scale: NOTED

STORM WATER SEWER PLAN & PROFILE
 SWS LINE 1, Sta. 70+94.00 to Sta. 75+40.04
 MERIDIAN AVENUE DRAINAGE OUTFALL PROJECT

Baughman Company, P.A.
 315 Ellis St., Wichita, KS 67211 P 316-262-1271 F 316-262-0149
 ENGINEERING | SURVEYING | PLANNING | LANDSCAPE ARCHITECTURE

January 2013
 SHEET 18 OF 119