

BENCHMARK:
 BM #9 - Chiseled "I" on the North Curb Return of the Drive to 1341 W. Dora, 68' South and 16' East of the Centerlines of Dora and Martinson.
 Elev. = 1292.58 (NAVD 88)

Note:
 Trees/Shrubs to be removed are marked thus:

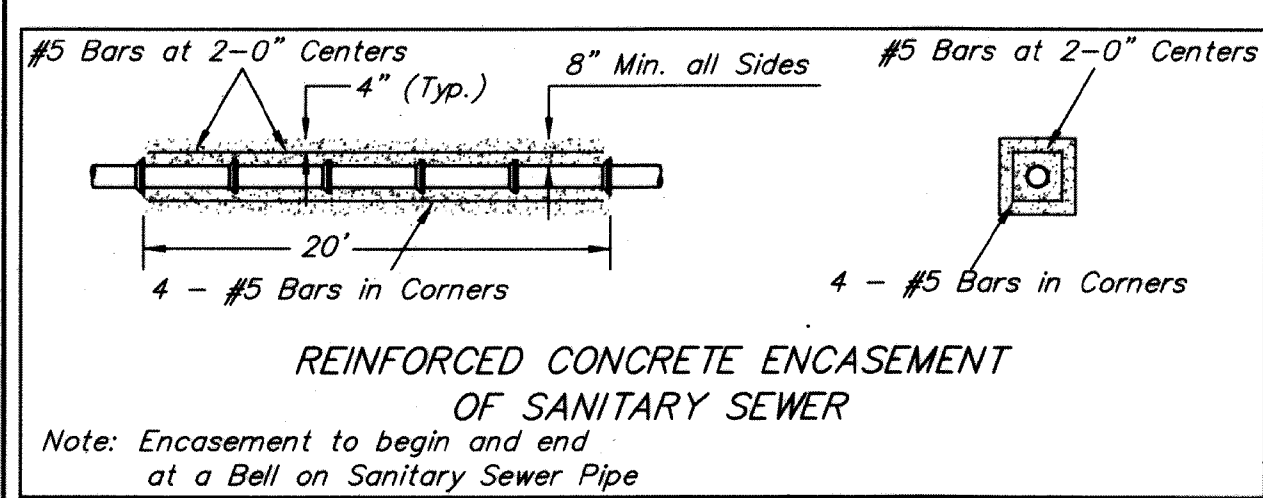



N-9974.42, E-21572.91
 W.L. Sta. 0+00.00, Begin Water Line 6
 Tap Ex. 6" Water Line.
 Install 1-6" X 6" Tapping Sleeve (S) & 6" Tapping Valve with Valve Box to be Furnished & Installed by the City of Wichita.
 Install 1-8" X 6" CIMJ Reducer Valve Box Elev. = 1292.8

CAUTION!
 Existing 6" Gas Crossing

Remove Ex. Concrete Sidewalk as Necessary for Construction. Do Not Replace.

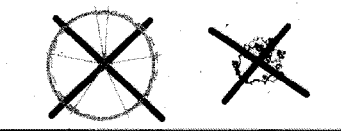
Note:
 Trees/Shrubs to be removed are marked thus:



Water Line 6

N-9980.12, E-21751.06
 W.L. Sta. 1+80.00, Water Line 6
 Install 1-Air Release Assy.
 Top Elevation = 1292.4

Remove Ex. Concrete Sidewalk as Necessary for Construction. Do Not Replace.

N-9980.76, E-21836.13
 W.L. Sta. 2+63.28, End Water Line 6 = W.L. Sta. 0+00.00, Water Line 7
 Install 1-8" X 8" CIMJ 90° Bend (S)
 Install 1-8" Anchored Valve Assy. (S)
 Valve Box Elev. = 1291.7

