

MERIDIAN AVENUE TYPICAL SECTION

Sta. 44+90.33 to Sta. 46+09.70

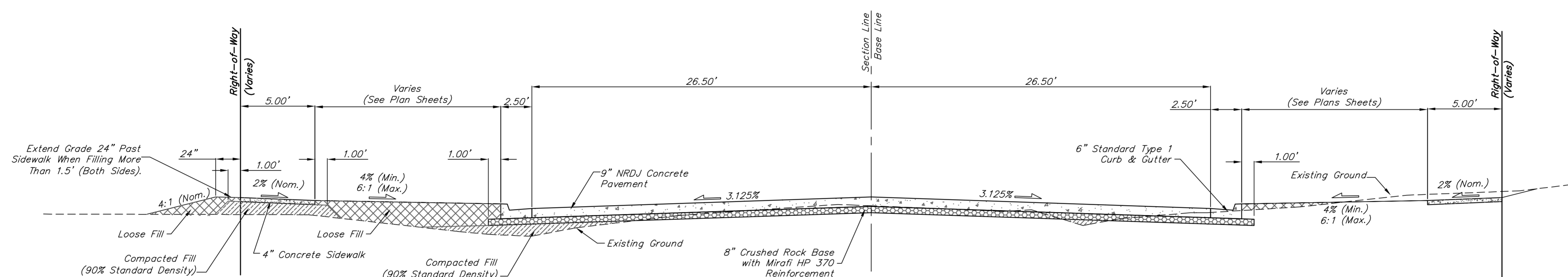

MERIDIAN AVENUE TYPICAL SECTION

Sta. 46+09.70 to Sta. 46+48.03

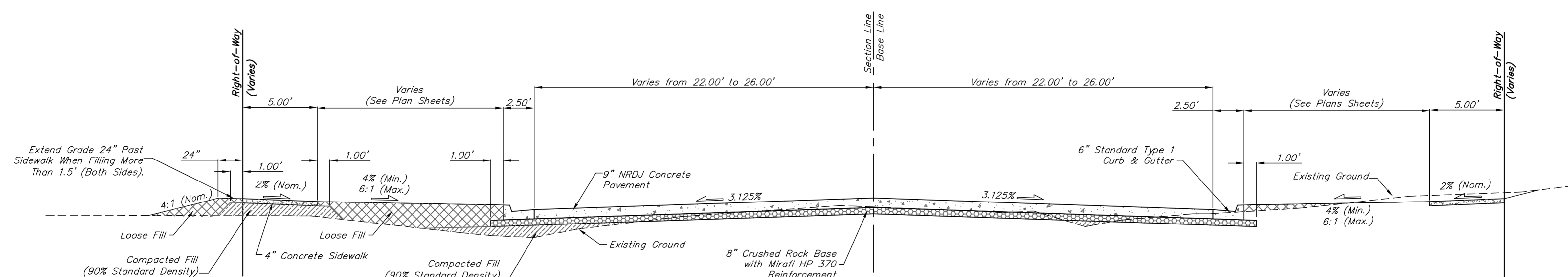

MERIDIAN AVENUE TYPICAL SECTION

Sta. 46+48.03 to Sta. 46+78.03

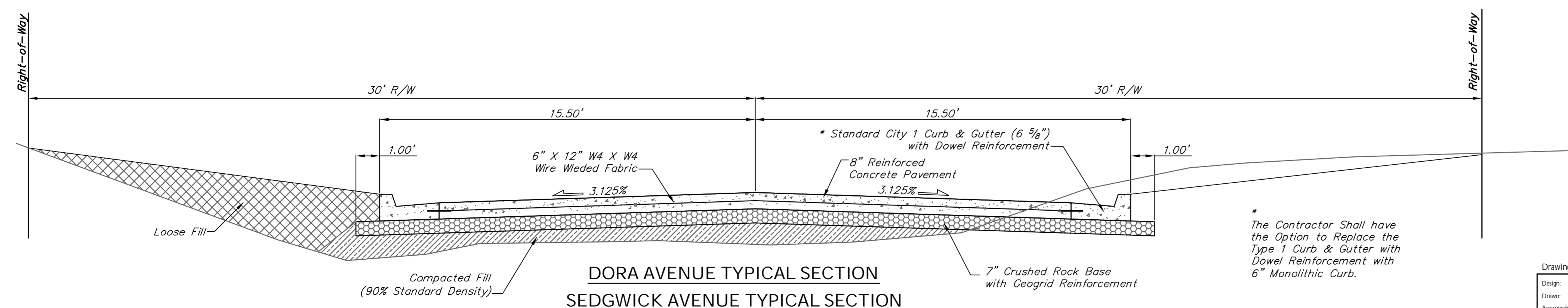

**DORA AVENUE TYPICAL SECTION
SEDGWICK AVENUE TYPICAL SECTION**

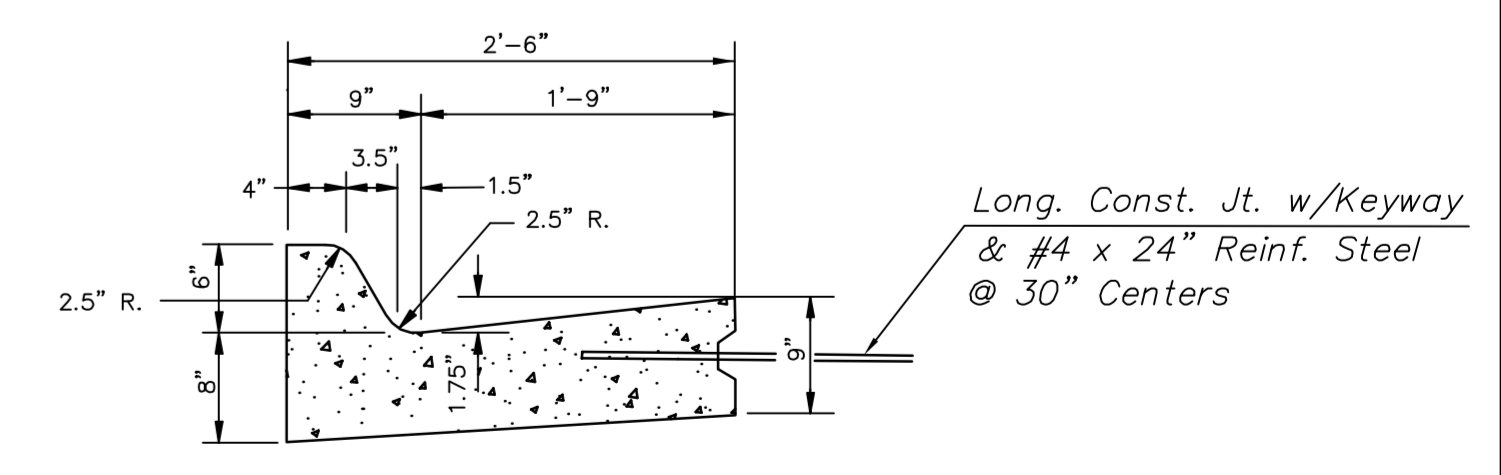

**TYPE I COMBINED
CURB & GUTTER
(6")**