

**BENCHMARK:**  
 BM #6 - Chiseled "L" located 10.5' North of the Curb Return of the Northwest Corner of Dora and Glenn, 41' North and 16' West of the Centerline of Both.  
 Elev. = 1292.81 (NAVD 88)

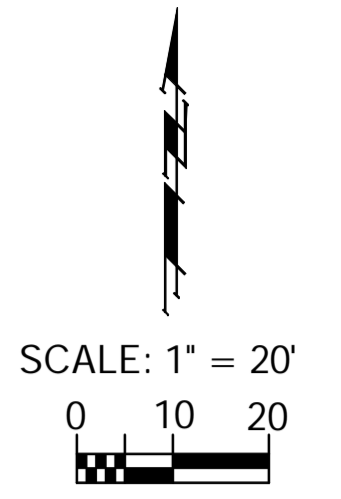

**BENCHMARK:**  
 BM #7 - Chiseled "L" on the North Curb Return of the Drive to 1901 S. Millwood, 36' South and 15' West of the Centerlines of Dora and Millwood.  
 Elev. = 1291.22 (NAVD 88)

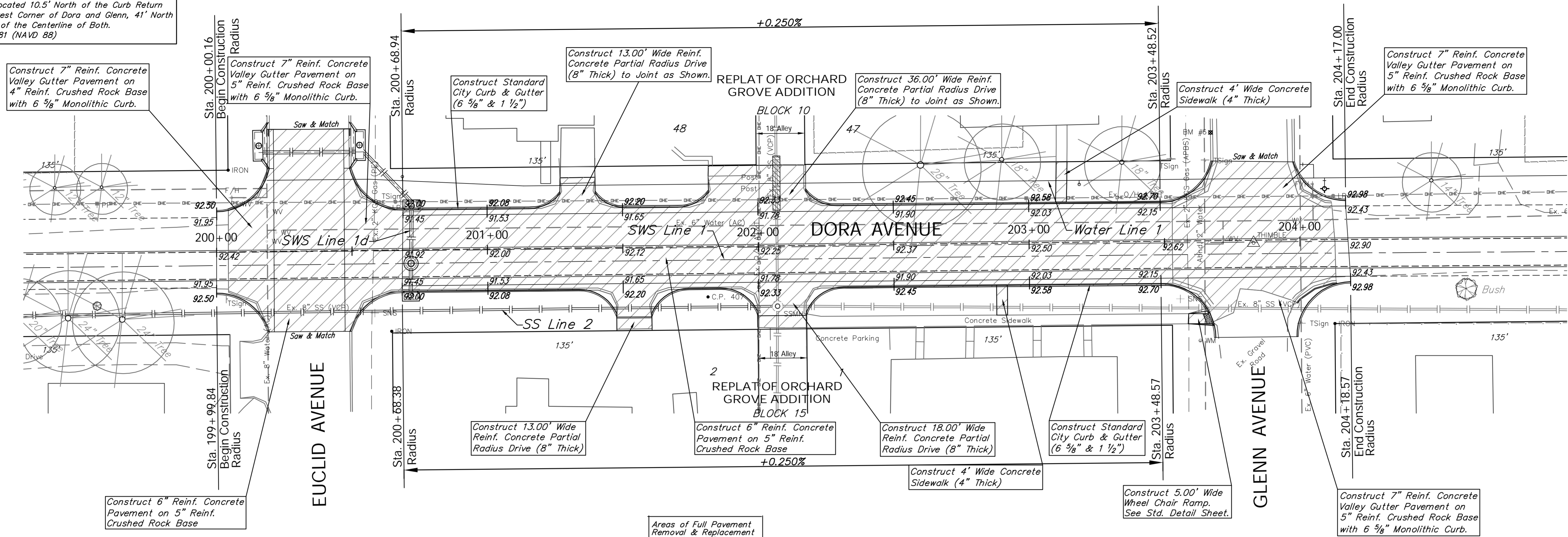
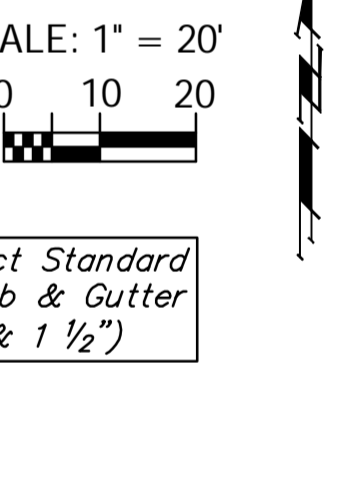
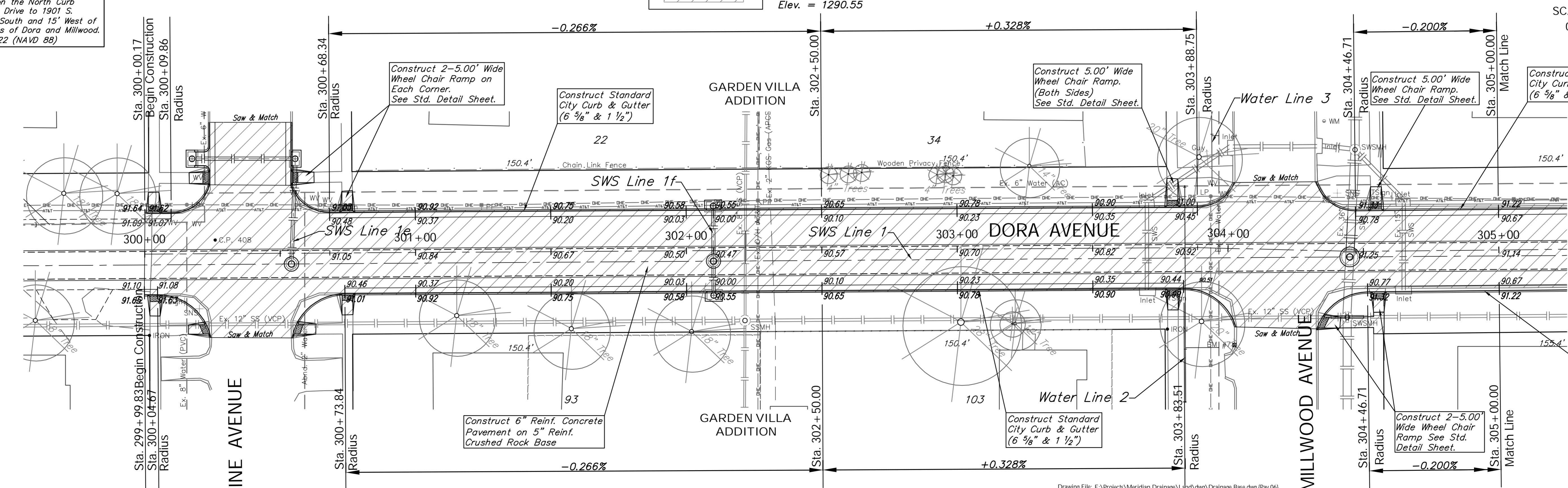

Design: TPV Drawn: STAFF Approved: TPV Scale: NOTED		Project No. 0802E038 CAPITAL IMPROVEMENT PROJECT <b>DORA AVENUE PAVING</b> STA. 199+84.84 TO STA. 305+00.00 MERIDIAN AVENUE DRAINAGE OUTFALL PROJECT	<p><b>Baughman Company, P.A.</b>          315 Ellis St., Wichita, KS 67211 P 316.262.1419 F 316.262.0149          ENGINEERING   SURVEYING   PLANNING   LANDSCAPE ARCHITECTURE</p>	January 2013 SHEET <b>59</b> OF <b>119</b>
--	--	--	---	--

P.V.I.  
 No V.C.  
 Elev. = 1290.55