

UTILITIES

AT&T, Wichita Central Unit
154 N. Broadway Ave. Rm 210
Wichita, Ks. 67202
Jason Edwards (316) 268-2102

Cox Communications
901 George Washington Blvd.
Wichita, Ks. 67211
Marc Henderson (316) 260-7745

Kansas Gas Service
1021 E. 26th St. N.
Wichita, Ks. 67219
Jim Coe (316) 832-3126

Southern Star Central Gas Pipeline, Inc.
4000 S. Seneca St.
Wichita, Ks. 67217
Andrew Buchanan (316) 529-6601

Westar Energy
1900 E. Central Ave.
P.O. Box 208
Wichita, Ks. 67201
Ken McClemore (316) 261-6512

Wichita Water Utilities
8th Floor - City Hall
455 N. Main St.
Wichita, KS 67202
Bill Perkins (San. Sewer) or
Greg Lolley (Water) (316) 268-4555

CP #104 Set #4 bar
100' N & 75' W of Ctr.
Intersection of 39th St. & Webb Rd.
N 1,711,560.5465 E 1,680,447.1896

CP #105 Found #5 bar w/Poe cap
63' S & 50' E of Ctr.
Intersection of 39th St. & Webb Rd.
N 1,711,406.6887 E 1,680,573.7478



45+00
45+50
46+00
46+50
47+00
47+50
48+00
48+50
49+00

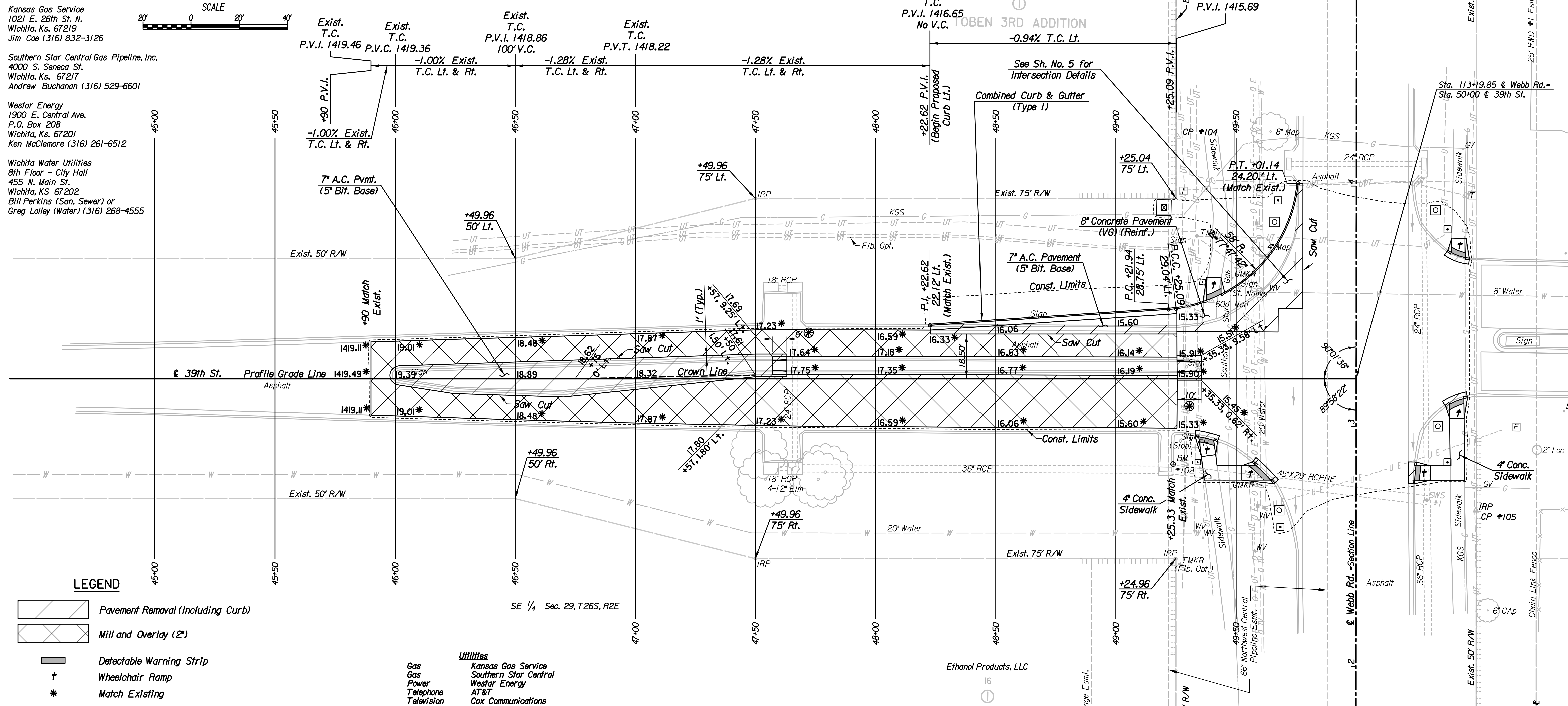

LEGEND

- Pavement Removal (Including Curb)
- Mill and Overlay (2')
- Detectable Warning Strip
- Wheelchair Ramp
- Match Existing
- Transition from Combined Curb & Gutter (Type 3) to no curb. Entire transition area, including 8" Nominal Concrete between curbs, shall be paid for as "Concrete Curb & Gutter, Combined Type 3 (8" & 1 1/2") Median"

Utilities
Gas Kansas Gas Service
Gas Southern Star Central
Power Westar Energy
Telephone AT&T
Television Cox Communications
Water Wichita Water and Sanitary Sewer

SE Corner Sec. 29, T26S, R2E

1. Found 1" Rebar in Thimble
2. N 1,710,141.1571 E 1,680,542.3059
3. to chiseled cross in NE corner of curb inlet
4. to 3 nails in SE face of power pole
5. to center of fence corner post
6. to chiseled cross in SE corner of curb inlet
7. to center of gas line marker
8. to W face of base of S brace post
9. to center of sanitary sewer manhole
10. to E edge of concrete pavement

E 1/4 Corner Sec. 29, T26S, R2E

1. Found #5 Rebar with Garber ID Cap
2. N 1,712,802.0214 E 1,680,503.5540
3. to chiseled cross, curb return S of driveway on W curb of Webb Road
4. to chiseled cross, SE corner of concrete pad for driveway, NW of S end of RCP
5. to top center of fire hydrant
6. to 3 nails in S face of high line pole
7. to NE face of gas pipeline marker post
8. to chiseled cross in NE corner of curb inlet
9. to chainlink fence going N and S
10. to center of aluminum cap "AGMTG-15" 0.5' S of pipeline marker post
11. to center of middle brace post

REMOVAL OF EXISTING STRUCTURES		
STATION	SIDE	ITEM
46+06	Lt.	Sign
48+64	Lt.	Sign
49+29	Lt.	Sign
49+52	Lt.	Sign

For Information Only

BM*101 C.O.W. BM Disk at the NW corner of 34th St. and Webb Road, 3' North of North back of curb, and 84' West of E Webb Road. NAVD88 Elev.=1432.07

BM*102 Chiseled " on the NE corner of curb inlet on the South side of 39th St., West of Webb Road. 76' Lt. E Sta. 112+84 NAVD88 Elev.=1415.78

Plotted By: svb Date: 8/2/2011 12:19:52 PM
FILE: I:\2010\10312\Plan\10312-Plan.dgn

Revision		By	Date
39TH STREET & WEBB RD.			
PLAN			
JAMES L. ARMOUR, P.E. - CITY ENGINEER CITY OF WICHITA PROJECT NO. 472-84720			
Professional Engineering Consultants, P.A. 303 S. TOPEKA - WICHITA, KANSAS 67202 316-262-2691 • FAX 316-262-3003			
Designed by	DRM	Job No.	10312
Drawn by	SVB	Date	April 2011
			Sh. 3 of 31