

CURVE DATA													
NO.	Δ	R	T	L	E	P.C. COORDINATES		P.I. COORDINATES		P.T. COORDINATES		C.C. COORDINATES	
						NORTH	EAST	NORTH	EAST	NORTH	EAST	NORTH	EAST
P101	169°14'04" Lt.	4'	42.45'	11.81'	38.64'	1,711,460.2232	1,680,124.8200	1,711,458.1847	1,680,082.4173	1,711,452.2668	1,680,124.4544	1,711,456.2278	1,680,125.0121
FC202	3°07'41" Lt.	58'	1.58'	3.17'	0.02'	1,711,488.4357	1,680,444.5995	1,711,488.5648	1,680,446.1779	1,711,488.7798	1,680,447.7469	1,711,546.2427	1,680,439.8716
FC203	77°47'42" Lt.	58'	46.80'	78.75'	16.52'	1,711,488.7798	1,680,447.7469	1,711,495.1338	1,680,494.1095	1,711,541.7918	1,680,497.7006	1,711,546.2427	1,680,439.8716

CURVE STAKE-OUT TABLE									
Curve No. FC202									
POINT NO.	STATION	OFFSET	ON CURVE		8' OFFSET		COMMENT		
			NORTH	EAST	NORTH	EAST			
9001	49+21.94	28.75' Lt.	1,711,488.4357	1,680,444.5995	1,711,496.4091	1,680,443.9474	P.C.		
9002	49+23.51	28.87' Lt.	1,711,488.5863	1,680,446.1756	1,711,496.5389	1,680,445.3060	1/2 Pt.		
9003	49+25.09	29.04' Lt.	1,711,488.7798	1,680,447.7469	1,711,496.7057	1,680,446.6606	P.T.		

Curve No. FC203									
POINT NO.	STATION	OFFSET	ON CURVE		8' OFFSET		COMMENT		
			NORTH	EAST	NORTH	EAST			
9004	49+25.09	29.04' Lt.	1,711,488.7798	1,680,447.7469	1,711,496.7057	1,680,446.6606	P.C.		
9005	49+59.69	46.21' Lt.	1,711,506.4662	1,680,482.0834	1,711,511.9526	1,680,476.2611	1/2 Pt.		
9006	49+75.83	81.30' Lt.	1,711,541.7918	1,680,497.7006	1,711,542.4057	1,680,489.7242	P.T.		

CONTROL POINTS						
POINT NO.	NORTH COORDINATE	EAST COORDINATE	LOCATION	STATION	OFFSET	DESCRIPTION
104	1,711,560.5465	1,680,447.1896	Webb Rd.	114+20.62	74.44' Lt.	1/2" Rebar
105	1,711,406.6887	1,680,573.7478	Webb Rd.	112+64.94	49.87' Rt.	#5 Bar/Property Iron
382	1,711,384.7306	1,680,449.1437	39th St. N.	49+24.92	75.02' Rt.	Property Iron
383	1,711,382.1419	1,680,274.2572	39th St. N.	47+50.02	74.97' Rt.	Property Iron
384	1,711,532.0267	1,680,272.0416	39th St. N.	47+50.05	74.93' Lt.	Property Iron
502	1,711,492.3708	1,680,462.3574	39th St. N.	49+39.75	32.41' Lt.	60d Nail

SIDEWALK COORDINATE TABLE						
POINT NO.	NORTH COORDINATE	EAST COORDINATE	LOCATION	STATION	OFFSET	DESCRIPTION
SW101	1,711,420.8671	1,680,476.0705	Webb Rd.	112+80.54	47.59' Lt.	CL Sidewalk P.I. (WCR)
SW102	1,711,420.6782	1,680,463.0994	Webb Rd.	112+80.54	60.57' Lt.	CL Sidewalk P.I. (Match Exist. to South)
SW103	1,711,422.0102	1,680,554.5584	Webb Rd.	112+80.54	30.90' Rt.	CL Sidewalk P.I. (WCR)
SW104	1,711,422.1741	1,680,565.8136	Webb Rd.	112+80.54	42.16' Rt.	CL Sidewalk P.I. (Match Exist. to South)
SW105	1,711,427.8390	1,680,462.1053	Webb Rd.	112+87.71	61.46' Lt.	CL Sidewalk P.I. (WCR)
SW106	1,711,444.8983	1,680,565.2403	Webb Rd.	113+03.27	41.92' Rt.	CL Sidewalk P.I. (WCR)
SW107	1,711,501.9330	1,680,463.1926	Webb Rd.	113+61.78	59.29' Lt.	CL Sidewalk P.I. (WCR) (Match Exist. to North)
SW108	1,711,519.8970	1,680,564.9806	Webb Rd.	113+78.26	42.75' Rt.	CL Sidewalk P.I. (WCR) (Match Exist. to North)

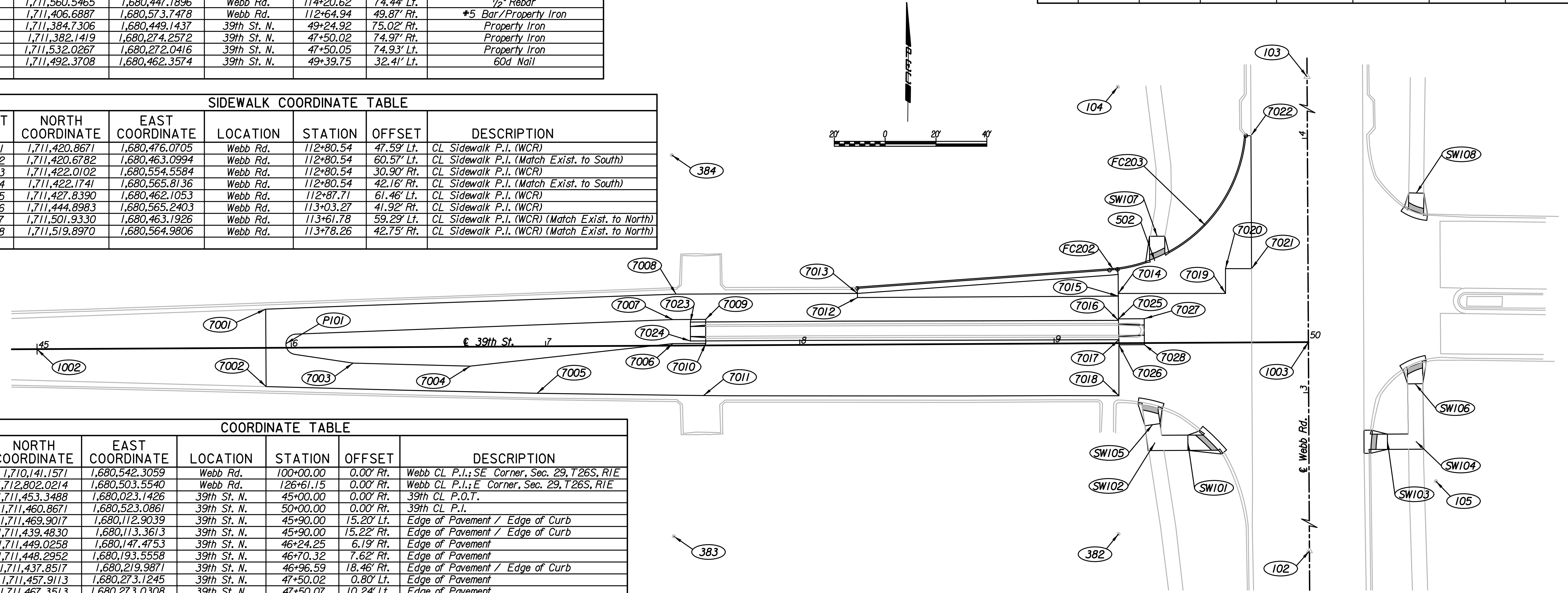

COORDINATE TABLE						
POINT NO.	NORTH COORDINATE	EAST COORDINATE	LOCATION	STATION	OFFSET	DESCRIPTION
102	1,710,141.1571	1,680,542.3059	Webb Rd.	100+00.00	0.00' Rt.	Webb CL P.I.; SE Corner, Sec. 29, T26S, R1E
103	1,712,802.0214	1,680,503.5540	Webb Rd.	126+61.15	0.00' Rt.	Webb CL P.I.; E Corner, Sec. 29, T26S, R1E
1002	1,711,453.3488	1,680,023.1426	39th St. N.	45+00.00	0.00' Rt.	39th CL P.O.T.
1003	1,711,460.8671	1,680,523.0861	39th St. N.	50+00.00	0.00' Rt.	39th CL P.I.
7001	1,711,469.9017	1,680,112.9039	39th St. N.	45+90.00	15.20' Lt.	Edge of Pavement / Edge of Curb
7002	1,711,439.4830	1,680,113.3613	39th St. N.	45+90.00	15.22' Rt.	Edge of Pavement / Edge of Curb
7003	1,711,449.0258	1,680,147.4753	39th St. N.	46+24.25	6.19' Rt.	Edge of Pavement
7004	1,711,448.2952	1,680,193.5558	39th St. N.	46+70.32	7.62' Rt.	Edge of Pavement
7005	1,711,437.8517	1,680,219.9871	39th St. N.	46+96.59	18.46' Rt.	Edge of Pavement / Edge of Curb
7006	1,711,457.9113	1,680,273.1245	39th St. N.	47+50.02	0.80' Lt.	Edge of Pavement
7007	1,711,467.3513	1,680,273.0308	39th St. N.	47+50.07	10.24' Lt.	Edge of Pavement
7008	1,711,477.3764	1,680,274.2427	39th St. N.	47+51.43	20.25' Lt.	Edge of Pavement / Edge of Curb
7009	1,711,467.5493	1,680,285.9584	39th St. N.	47+63.00	10.25' Lt.	Edge of Pavement
7010	1,711,458.1014	1,680,286.1032	39th St. N.	47+63.00	0.80' Lt.	Edge of Pavement
7011	1,711,437.6018	1,680,285.4235	39th St. N.	47+62.01	19.69' Rt.	Edge of Pavement / Edge of Curb
7012	1,711,476.6999	1,680,345.5851	39th St. N.	48+22.76	18.50' Lt.	Edge of Pavement
7013	1,711,478.3289	1,680,345.5606	39th St. N.	48+22.76	20.13' Lt.	Edge of Pavement / Edge of Curb
7014	1,711,479.3180	1,680,448.1309	39th St. N.	49+25.33	19.58' Lt.	Edge of Pavement
7015	1,711,478.2423	1,680,448.1471	39th St. N.	49+25.33	18.50' Lt.	Edge of Pavement
7016	1,711,468.7170	1,680,448.2904	39th St. N.	49+25.33	8.97' Lt.	Edge of Pavement / Edge of Curb
7017	1,711,461.1088	1,680,448.4048	39th St. N.	49+25.33	1.36' Lt.	Edge of Pavement / Edge of Curb
7018	1,711,439.0713	1,680,448.7362	39th St. N.	49+25.33	20.68' Rt.	Edge of Pavement / Edge of Curb
7019	1,711,479.7112	1,680,490.2974	39th St. N.	49+67.50	19.33' Lt.	Edge of Pavement
7020	1,711,489.4608	1,680,490.2065	39th St. N.	49+67.55	29.08' Lt.	Edge of Pavement
7021	1,711,489.5564	1,680,500.4695	Webb Rd.	113+48.87	22.20' Lt.	Edge of Pavement
7022	1,711,541.8186	1,680,499.7083	Webb Rd.	114+01.13	22.20' Lt.	Edge of Pavement
7023	1,711,466.4575	1,680,279.9727	39th St. N.	47+57.00	9.25' Lt.	Edge of Pavement / Edge of Curb
7024	1,711,459.0134	1,680,280.0833	39th St. N.	47+57.00	1.80' Lt.	Edge of Pavement / Edge of Curb
7025	1,711,469.3192	1,680,448.2813	39th St. N.	49+25.33	9.58' Lt.	Edge of Pavement / Edge of Curb
7026	1,711,459.1203	1,680,448.4347	39th St. N.	49+25.33	0.62' Rt.	Edge of Pavement / Edge of Curb
7027	1,711,469.4695	1,680,458.2802	39th St. N.	49+35.33	9.58' Lt.	Edge of Pavement / Edge of Curb
7028	1,711,459.2707	1,680,458.4336	39th St. N.	49+35.33	0.62' Rt.	Edge of Pavement / Edge of Curb

Plotted By: svb Date: 8/2/2011 12:24:42 PM
 FILE: I:\2010\10312_Geometry\10312-COG0.dgn

No.	Revision	By	Date
	39TH STREET & WEBB RD.		
COORDINATE GEOMETRY PLAN			
JAMES L. ARMOUR, P.E. - CITY ENGINEER CITY OF WICHITA PROJECT NO. 472-84720			
Professional Engineering Consultants, P.A. 303 S. TOPKA - WICHITA, KANSAS 67202 316-262-2691 • FAX 316-262-3003			
Designed by	DRM	Job No.	10312
Drawn by	SVB	Date	April 2011
			Sht. 4 of 31