

Sta. 18+57.47 Line 1
Sta. 0+00.00 Line 1H
Constr. Std. MH Type 'P'
N 4714.3392, E 6676.0039

Sta. 20+32.23 Line 1
Sta. 0+00.00 Line 1I
Constr. Std. MH Type 'P'
N 4700.4164, E 6850.2033

Sta. 22+47.16 Line 1
Sta. 0+00.00 Line 1J
Sta. 0+00.00 Line 1K
Constr. Std. MH Type 'P'
N 4713.7368, E 7064.7195

Sta. 25+70.70 Line 1
Constr. Std. MH Type 'P'
N 4889.7269, E 7336.2127

Sta. 27+91.60 Line 1
Sta. 0+00.00 Line 2
Constr. Std. MH Type 'P'
N 5016.8778, E 7516.8504

SANITARY SEWER RISER SUMMARY										
No.	Line	Sta./Dir.	Lot No.	Block No.	Saddle Size	8" Main FL	Information Only Approx. Length 4" Pipe		Coordinates at End of 4" Pipe	
							Vert.	Horiz.	Northing	Easting
14	1	19+48 Rt.	13	3	8"x4"	126.7	8'	7'	4700.1683	6765.4461
15	1	20+28 Rt.	14	3	8"x4"	126.8	8'	7'	4693.7350	6846.2005
16	1	21+17 Rt.	15	3	8"x4"	127.0	9'	14'	4691.6927	6935.6081
17	1	22+26 Rt.	16	3	8"x4"	127.2	9'	6'	4706.4305	7043.8684

- S1/4 Cor. 19-26S-1E
1. Found stone w/ "+" cut.
 2. Steel fence post on NW side of stone
 3. Bent 60d spike in hedge stump 17.15' S.
 4. 3/4" IP on W side of stone
 5. Spike in 15" hack. 11.2' SW.
 6. Spike & washer in 10" hack. 20.7' WSW.

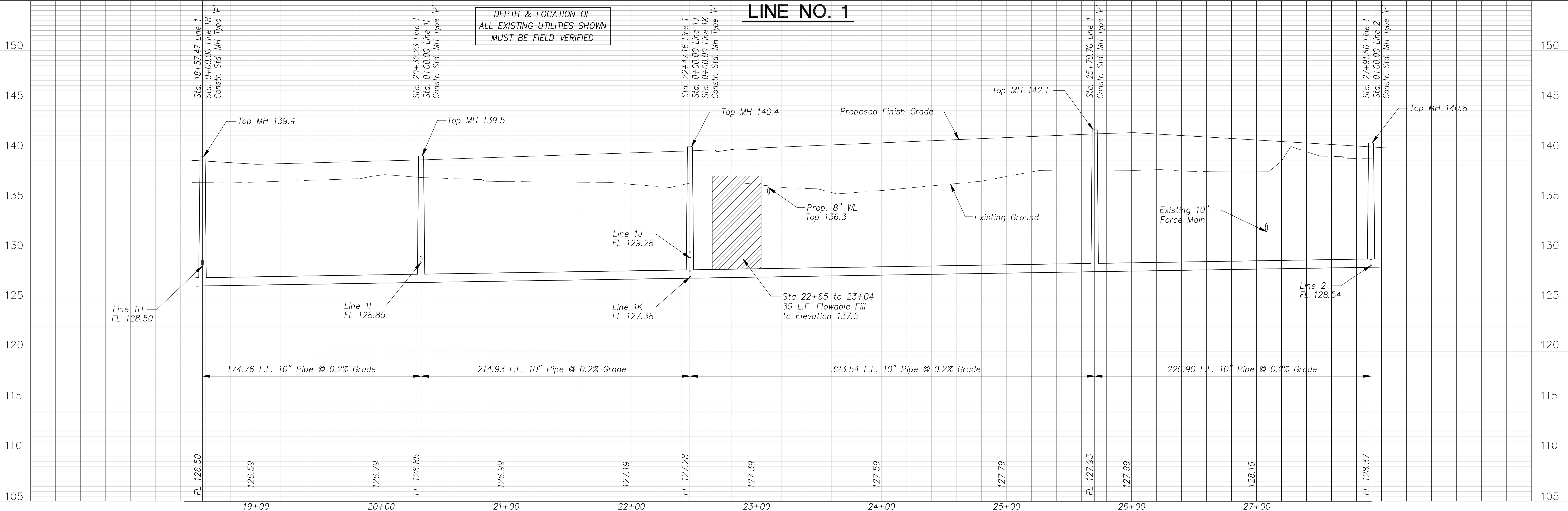

DEPTH & LOCATION OF ALL EXISTING UTILITIES SHOWN MUST BE FIELD VERIFIED

No.	Date	By	Approved	Revision

HARBOR ISLE 3RD ADDITION
SANITARY SEWER IMPROVEMENTS
SEWERLINE NO. 1
CITY OF WICHITA, KANSAS
JAMES ARMOUR, P.E. - CITY ENGINEER
Proj.# 468-83106 O.C.A.# 744037

POE & ASSOCIATES, INC.
CONSULTING ENGINEERS
5940 E. Central, Suite 200 • Wichita, KS 67208-4242
Phone 316/685-4114 • FAX 316/685-4444

FINAL

Designed By: J. Ubert / B. Kulla
Drawn By: B. Kulla
Poe Job No.: 1786
Date: February 2004

Sheet
4 of 21