

2013 Sanitary Sewer Reconstruction Phase 9

OCA 620647 / 468-84906

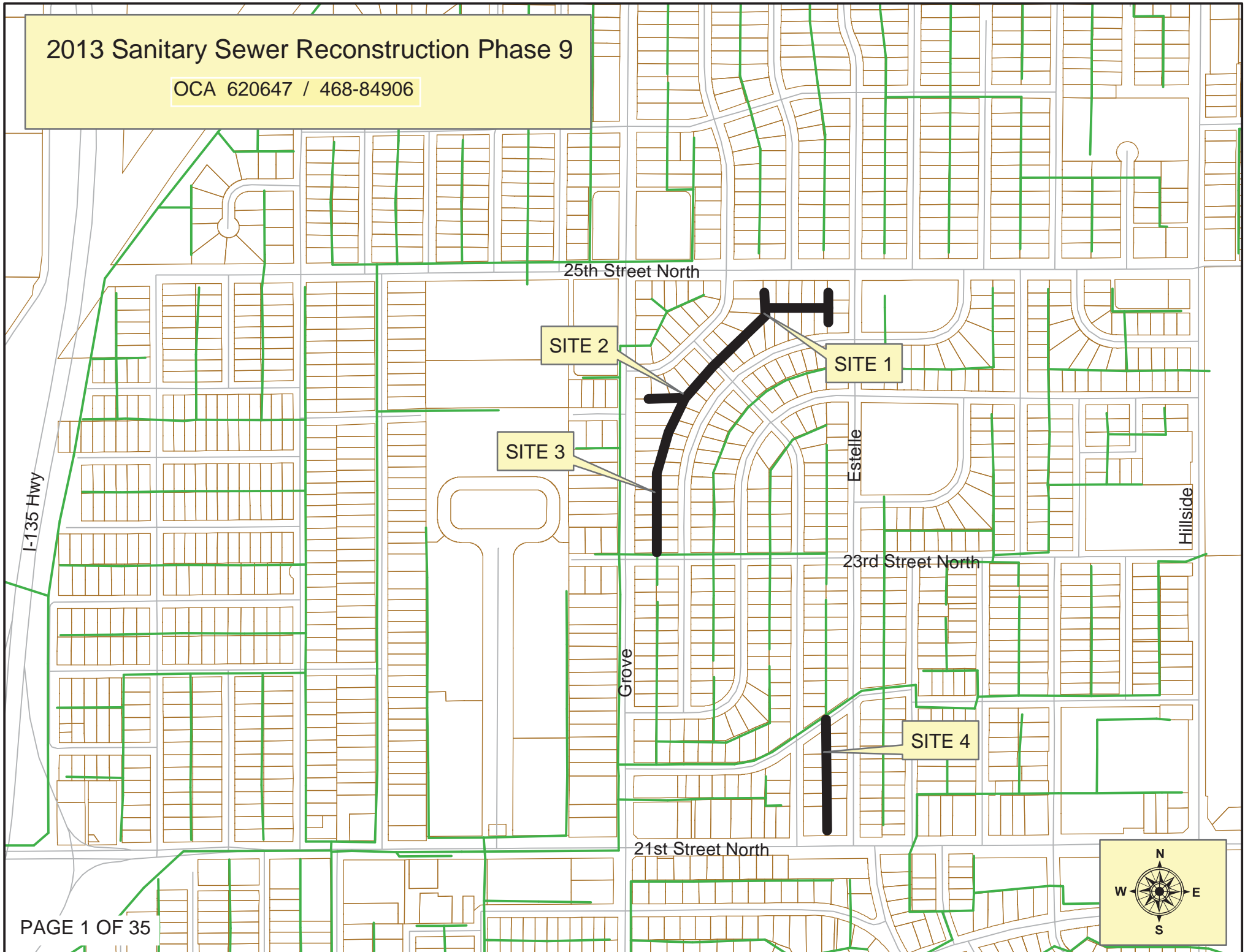

2013 Sanitary Sewer Reconstruction Phase 9

OCA 620647 / 468-84906

<u>SITE NO.</u>	<u>GENERAL LOCATION</u>	<u>UPSTREAM MANHOLE</u>	<u>DOWNSTREAM MANHOLE</u>	<u>RECORD UPSTREAM INVERT ELEVATION</u>	<u>RECORD DOWNSTREAM INVERT ELEVATION</u>	<u>LENGTH</u>
1	Easements south of 25th Street North, betw Estelle and Raleigh, north of Prince St.	5650-247	5650-245	1337.61	1337.42	53
		5650-246	5650-245	1337.61	1337.38	51
		5650-245	5650-244	1337.08	1335.93	292
		5650-244	5650-243	1334.10	1334.01	33
		5650-243	5650-242	1333.77	1332.40	343
		5650-248	5650-244	1336.60	1336.40	51
2	Easement between Grove and Poplar, south of Prince and south of Raleigh	5650-242	5650-241	1331.19	1330.40	196
		5650-241	5650-240	1327.03	1326.40	155
		5650-240	5650-239	1323.20	1322.40	200
		5650-249	5650-241	1327.85	1327.23	160
3	Easement between Grove and Poplar, north of 23rd Street North	5650-239	5650-238	1318.91	1318.20	177
		5650-238	5650-207	1318.2	1317.42	200
4	Easement between Prince and Estelle, between 21st St. N. and Audrey St.	5650-313	5650-312	1331.69	1330.40	323
		5650-312	5650-255	1327.40	1326.60	200
				Total Linear Feet =		2434

Bid Items by Site Reference

2013 Sanitary Sewer Reconstruction Phase 9

<u>Item</u>	<u>Site 1</u>	<u>Site 2</u>	<u>Site 3</u>	<u>Site 4</u>	<u>Totals</u>	
<u>Lump Sum Items:</u>						
Pipe, SS 8"	823	711	377	523	2434	lf
Pipe Removed (8")	823	711	377	523	2434	lf
Service Connection Replaced (Relocated)	1				1	ea
MH, Adjust to Grade (< 6")		1		1	2	ea
MH, Adjust to Grade (6" to 12")	1	1			2	ea
MH, Adjust to Grade (12" to 16")			1		1	ea
MH Frame & Cover, Replaced	3	5	1	1	10	ea
MH, Bench & Invert, Removed & Replaced	1	3			4	ea
MH, Outside Drop Constructed		3		1	4	ea
Concrete Driveway Rem & Repl (Parking Lot)				9	9	lf
Concrete Pavement Rem & Replaced	32			40	72	lf
Fill, Flowable	32			40	72	lf
Site Clearing					1	LS
Site Restoration					1	LS
<u>Measured Quantity Items:</u>						
Service Reconnection, Sewer (4")	17	19	12	10	58	ea
Service Reconnection, Sewer (6")				1	1	ea
Fence Removed & Reset (Concrete Base)	240				240	lf
BMP, Construction Entrance	1	1	1	1	4	ea
BMP, Curb Inlet Protection				1	1	ea
BMP, Back of Curb Protection	20	20	20	20	80	lf
BMP, Silt Fence				20	20	lf
BMP, Erosion Control Mat	30	30	30	30	120	sy