

Plotted By: svb Date: 8/15/2013 6:35:53 PM
 FILE: I:\2008\08207\Plan\08207-PL PR ChannelB 3.dgn

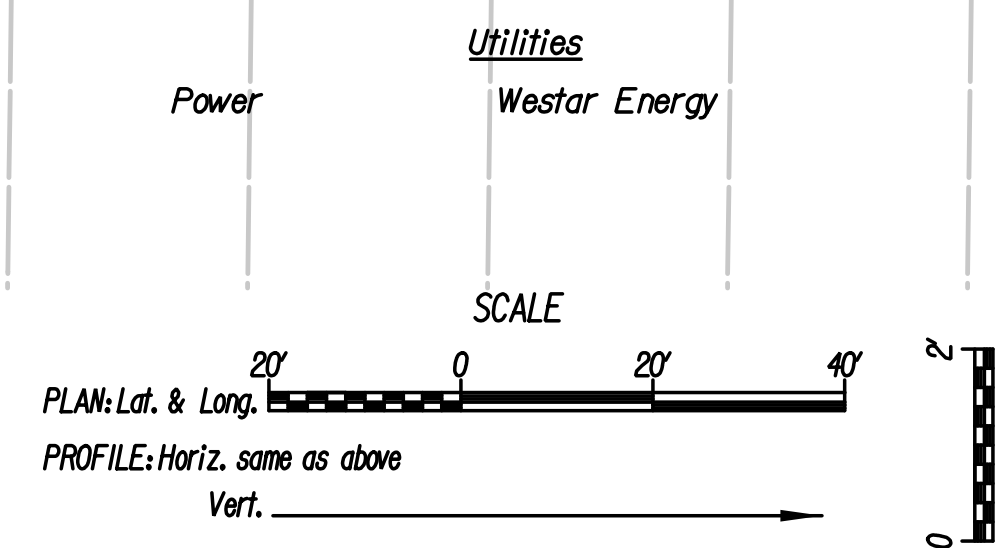

BM*59 60d Step Nails in W face of Power Pole, W side of drainage ditch, E side of RR tracks, 1325' ± S of 37th St. N, 31' Rt. & Sta. 18+34 Elev. = 1320.99

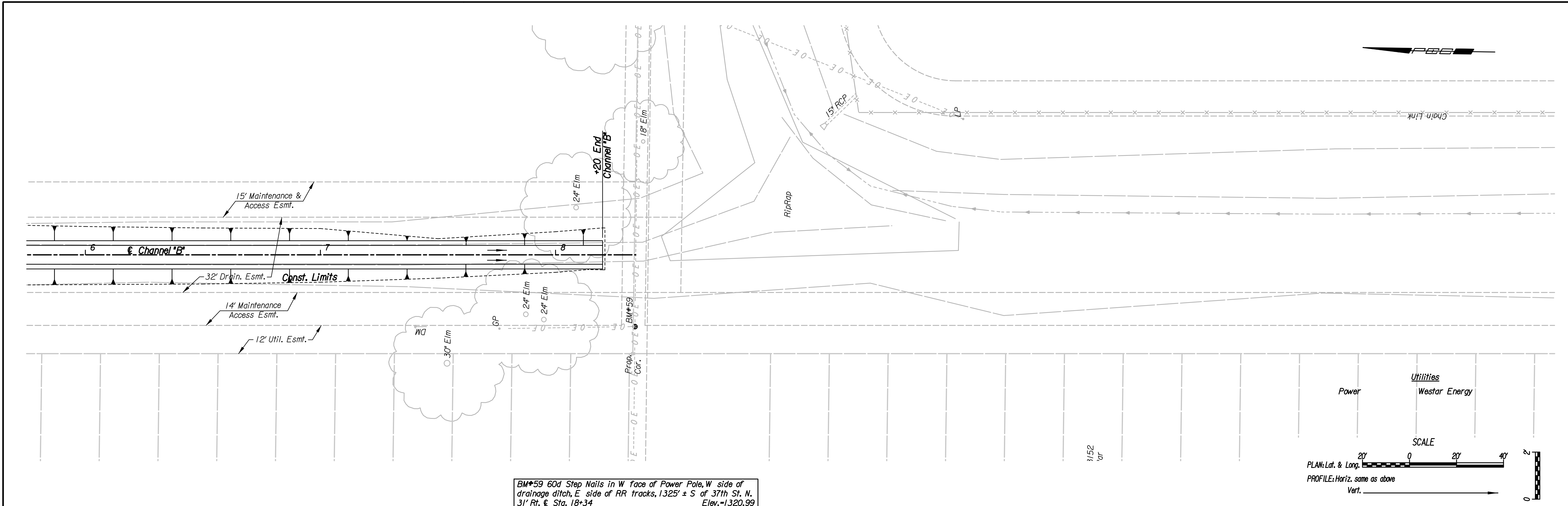
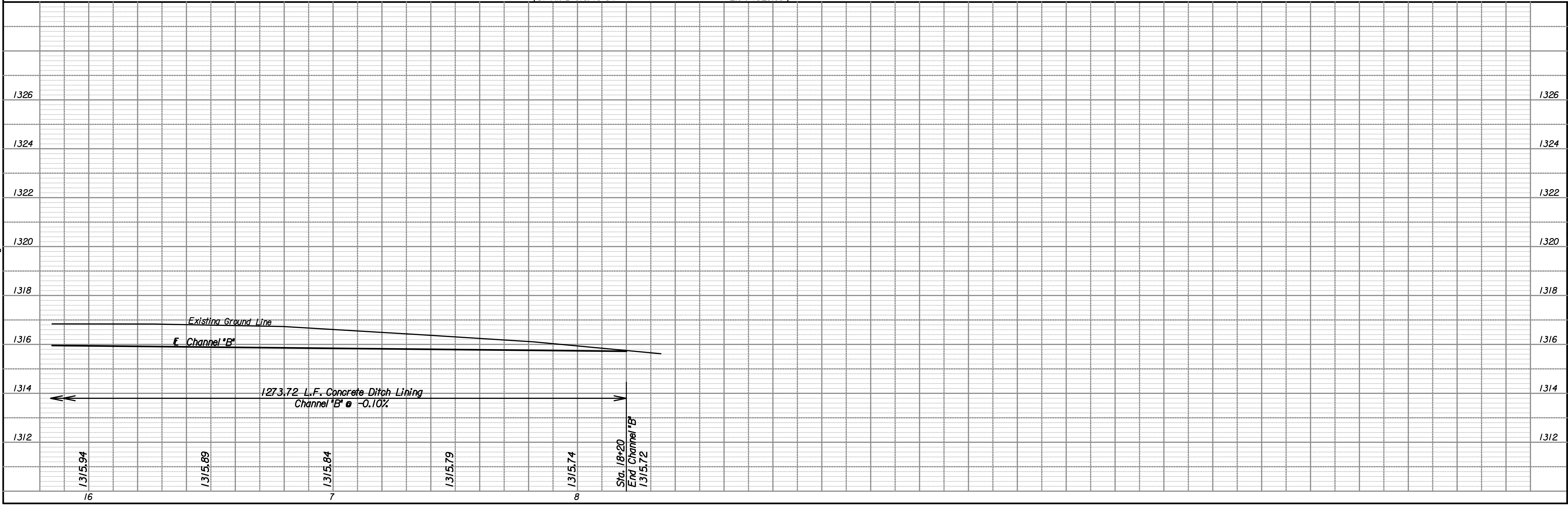

37TH STREET NORTH
CHANNEL "B" PLAN
 STA. 16+00 TO STA. 18+20
 C.O.W. PROJ. NO. 472-94692

PROFESSIONAL ENGINEERING CONSULTANTS, P.A.
 303 SOUTH DOPEKA, WICHITA, KS 67202
 316-262-2891 www.pec1.com

PEC

Job No. 08207
 Date August, 2013

Designed by JPS
 Drawn by SYB