

NO.	Δ	R	T	L	E	CURVE DATA							
						P.C. COORDINATES		P.I. COORDINATES		P.T. COORDINATES		C.C. COORDINATES	
						NORTH	EAST	NORTH	EAST	NORTH	EAST	NORTH	EAST
FC017	20° 21' 51" Lt.	198.00'	35.56'	70.37'	3.17'	1,709,780.0471	1,654,096.4995	1,709,780.3080	1,654,132.0604	1,709,792.9273	1,654,165.3080	1,709,978.0418	1,654,095.0470
FC018	57° 04' 41" Lt.	38.00'	20.67'	37.86'	5.26'	1,709,792.9273	1,654,165.3080	1,709,800.2606	1,654,184.6289	1,709,820.4645	1,654,188.9741	1,709,828.4543	1,654,151.8235
FC019	12° 50' 19" Lt.	118.00'	13.28'	26.44'	0.74'	1,709,820.4645	1,654,188.9741	1,709,833.4437	1,654,191.7655	1,709,846.7188	1,654,191.6030	1,709,845.2750	1,654,073.6119
FC020	12° 50' 19" Rt.	118.00'	13.28'	26.44'	0.74'	1,709,738.2322	1,654,121.8773	1,709,738.3296	1,654,135.1530	1,709,735.4746	1,654,148.1184	1,709,620.2354	1,654,122.7429
FC021	56° 00' 39" Rt.	38.00'	20.21'	37.15'	5.04'	1,709,735.4746	1,654,148.1184	1,709,731.1286	1,654,167.8552	1,709,712.3344	1,654,175.2853	1,709,698.3637	1,654,139.9467
FC022	20° 21' 51" Rt.	198.00'	35.56'	70.37'	3.17'	1,709,712.3344	1,654,175.2853	1,709,679.2632	1,654,188.3596	1,709,643.7092	1,654,189.1085	1,709,639.5395	1,653,991.1524
FC023	90° 21' 07" Lt.	58.00'	58.36'	91.46'	24.28'	1,709,839.6183	1,654,231.6929	1,709,781.2652	1,654,232.4069	1,709,782.3377	1,654,290.7545	1,709,840.3279	1,654,289.6886
FC024	90° 09' 13" Rt.	48.00'	48.13'	75.53'	19.97'	1,709,680.2654	1,654,240.3501	1,709,728.3836	1,654,239.3365	1,709,729.2682	1,654,287.4572	1,709,681.2763	1,654,288.3394

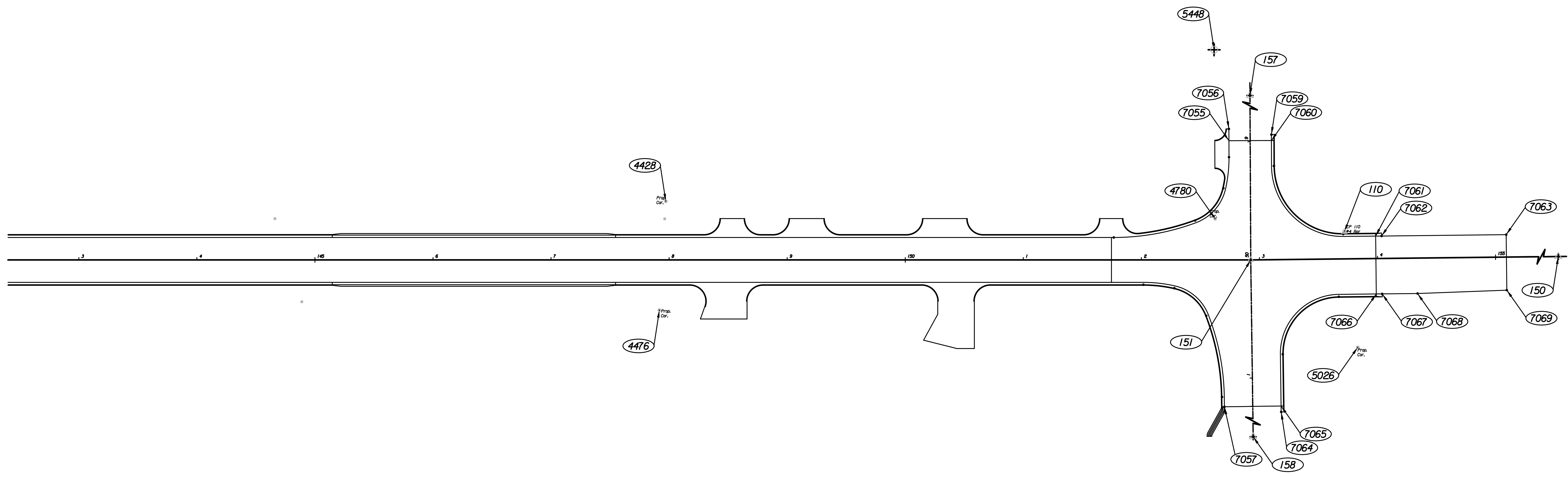
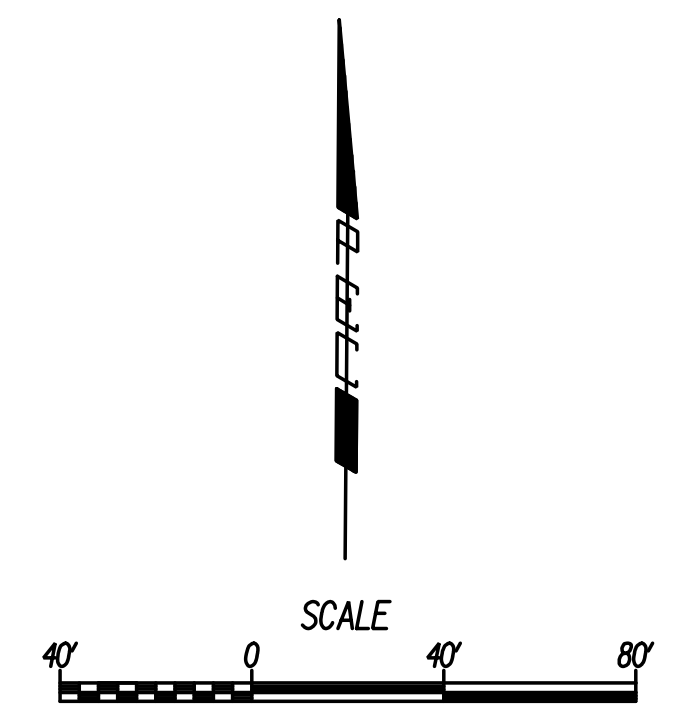

CONTROL POINTS					
POINT NO.	NORTH COORDINATE	EAST COORDINATE	STATION	OFFSET	DESCRIPTION
110	1,709,784.2612	1,654,291.7772	153+72.19	22.90' Lt.	*4 Bar
150	1,709,808.2699	1,656,844.1569	179+24.58	0.00' Rt.	3/4" IRP in Thimble, S1/4 Corner Sec. 27-26-1E
151	1,709,759.8988	1,654,212.6669	152+92.64	0.00' Rt.	*4 Bar w/Cap, SW Corner Sec. 27-26-1E
157	1,712,416.0972	1,654,180.1643	23+43.60	0.00' Rt.	2" Alum. Cap, W1/4 Corner Sec. 27-26-1E
158	1,707,082.0777	1,654,269.0721	76+78.42	0.00' Rt.	1" IRP, W1/4 Corner Sec. 34-26-1E
4428	1,709,805.9141	1,653,716.8323	147+97.16	49.65' Lt.	IRP, Property Corner
4476	1,709,713.7767	1,653,712.0914	147+91.74	42.45' Rt.	IRP, Property Corner
4780	1,709,794.5004	1,654,182.2667	152+62.50	34.82' Lt.	IRP, Property Corner
4923	1,709,509.2887	1,654,142.7730	52+49.08	75.16' Rt.	IRP, Property Corner
4955	1,709,109.2116	1,654,176.2177	56+49.78	50.14' Rt.	IRP, Property Corner
5026	1,709,686.5655	1,654,303.8271	153+82.44	75.00' Rt.	IRP, Property Corner
5080	1,709,691.0216	1,654,563.7814	156+42.43	75.32' Rt.	IRP, Property Corner
5081	1,709,716.0030	1,654,563.1967	156+42.31	50.33' Rt.	IRP, Property Corner
5240	1,709,810.1262	1,654,989.6624	160+70.43	35.94' Lt.	MJH Target
5448	1,709,937.5388	1,654,180.3371	152+61.62	177.87' Lt.	IRP, Property Corner

COORDINATE TABLE					
POINT NO.	NORTH COORDINATE	EAST COORDINATE	STATION	OFFSET	DESCRIPTION
7055	1,709,860.6710	1,654,193.4325	152+74.15	100.91' Lt.	Edge of Curb / Edge of Curb
7056	1,709,870.6703	1,654,193.3101	152+74.10	110.91' Lt.	Edge of Curb / Match Line
7057	1,709,635.4209	1,654,191.2836	152+70.35	124.32' Rt.	Edge of Curb / Edge of Curb
7059	1,709,866.1111	1,654,229.3686	153+11.29	105.89' Lt.	Edge of Curb / Match Line
7060	1,709,861.1115	1,654,229.4298	153+11.26	100.89' Lt.	Edge of Curb / Edge of Curb
7061	1,709,780.8437	1,654,318.2998	153+98.64	19.00' Lt.	Edge of Curb / Edge of Curb
7062	1,709,780.9356	1,654,323.2990	154+03.64	19.00' Lt.	Edge of Curb / Edge of Curb
7063	1,709,782.8759	1,654,428.8571	155+09.22	19.00' Lt.	Edge of Pavement / Match Line
7064	1,709,631.4328	1,654,239.3782	153+16.99	128.94' Rt.	Edge of Curb / Match Line
7065	1,709,636.4317	1,654,239.2729	153+16.98	123.94' Rt.	Edge of Curb / Edge of Curb
7066	1,709,731.8520	1,654,319.2004	153+98.64	30.00' Rt.	Edge of Curb / Edge of Curb
7067	1,709,731.9439	1,654,324.1995	154+03.64	30.00' Rt.	Edge of Curb / Edge of Curb
7068	1,709,732.4943	1,654,354.1420	154+33.59	30.00' Rt.	Edge of Pavement
7069	1,709,735.8839	1,654,429.7209	155+09.22	28.00' Rt.	Edge of Pavement / Match Line

Plotted By: svb Date: 8/15/2013 7:08:10 PM
 FILE: I:\2008\0820\COGO\08201-C06043.dgn

Revision		By	Date
37TH STREET NORTH			
COORDINATE GEOMETRY PLAN			
STA. 143+00 TO STA. 155+00			
GARY JANZEN, P.E. - CITY ENGINEER CITY OF WICHITA PROJECT NO. 472-84692			
PEC		PROFESSIONAL ENGINEERING CONSULTANTS, P.A. 303 SOUTH TOPEKA WICHITA, KS 67202 316-262-2691 www.pec1.com	
Designed by	JPS	Job No.	08207
Drawn by	SVB	Date	August, 2013
			Sht. 23 of 193