

Sta. 106+85.1 SWS Line No. 100-
Sta. 5+00 SWS Line No. 104-
Sta. 108+07, 13' Lt. & 37th St.
Construct R.C. Manhole (On RCB)
Stack=1.39'
Install 15"x9.5' SWS (RCP) (N)
See Sh. No. 53, 55, 72

Sta. 5+09.5 SWS Line No. 104-
Sta. 108+07, 22.50' Lt. & 37th St.
Construct Std. Type I Curb Inlet
L=10'-0" W=3'-0"
See Sh. No. 48, 55

Sta. 4+90.5 SWS Line No. 105-
Sta. 108+47, 22.50' Lt. & 37th St.
Construct Std. Type I Curb Inlet
L=10'-0" W=3'-0"
See Sh. No. 48, 55

Sta. 107+25.1 SWS Line No. 100-
Sta. 5+00 SWS Line No. 105-
Sta. 108+47, 13' Lt. & 37th St.
Construct R.C. Manhole (On RCB)
Stack=1.31'
Install 15"x9.5' SWS (RCP) (N)
Install 15"x35.5' SWS (RCP) (S)
See Sh. No. 53, 55, 72

Sta. 5+09.5 SWS Line No. 106-
Sta. 111+00, 22.50' Lt. & 37th St.
Construct Std. Type I Curb Inlet
L=5'-0" W=3'-0"
See Sh. No. 48, 55

Sta. 110+53.1 SWS Line No. 100-
Sta. 5+00 SWS Line No. 107-
Sta. 111+75, 13' Lt. & 37th St.
Construct R.C. Manhole (On RCB)
Stack=1.53'
Install 15"x9.5' SWS (RCP) (N)
Install 15"x35.5' SWS (RCP) (S)
See Sh. No. 53, 56, 72

Sta. 4+90.5 SWS Line No. 107-
Sta. 111+75, 22.50' Lt. & 37th St.
Construct Std. Type I Curb Inlet
L=10'-0" W=3'-0"
See Sh. No. 48, 56

Sta. 111+46.1 SWS Line No. 100-
Sta. 5+00 SWS Line No. 108-
Sta. 112+68, 13' Lt. & 37th St.
Construct R.C. Manhole (On RCB)
Stack=2.00'
Install 15"x20.0' SWS (RCP) (N)
with End Section (136)
See Sh. No. 53, 56, 62, 72

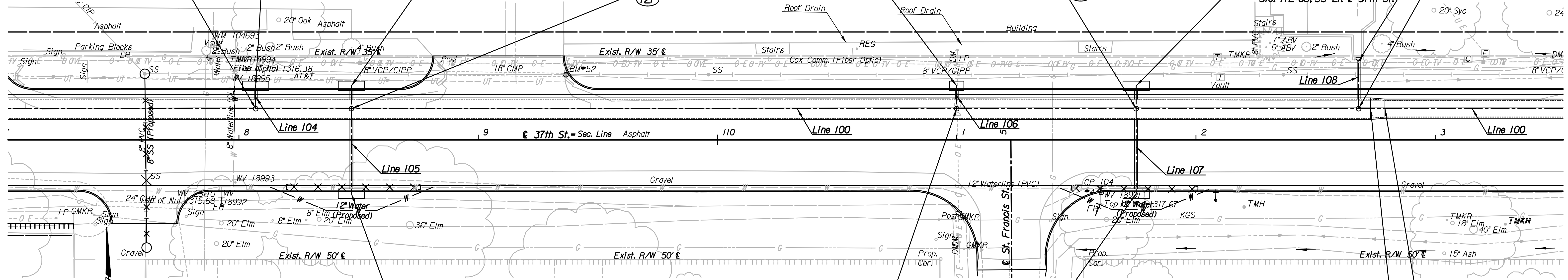

Sta. 5+35.5 SWS Line No. 105-
Sta. 108+47, 22.50' Rt. & 37th St.
Construct Std. Type I Curb Inlet
L=10'-0" W=3'-0"
See Sh. No. 48, 55

Sta. 109+78.1 SWS Line No. 100-
Sta. 5+00 SWS Line No. 106-
Sta. 111+00, 13' Lt. & 37th St.
Construct R.C. Manhole (On RCB)
Stack=1.76'
Install 15"x9.5' SWS (RCP) (N)
See Sh. No. 53, 55, 72

Sta. 5+35.5 SWS Line No. 107-
Sta. 111+75, 22.50' Rt. & 37th St.
Construct Std. Type I Curb Inlet
L=10'-0" W=3'-0"
See Sh. No. 48, 56

Sta. 111+51.1 SWS Line No. 100-
Sta. 112+73, 13' Lt. & 37th St.
Install Transition 8'x3'
7'x3'x6.0' SWS (RCB) (E)
See Sh. No. 55, 72, 76, 97-99

Sta. 111+57.1 SWS Line No. 100-
Sta. 112+79, 13' Lt. & 37th St.
Install 7'x3'x454.0' SWS (RCB) (E)
See Sh. No. 55, 72, 76, 97-99

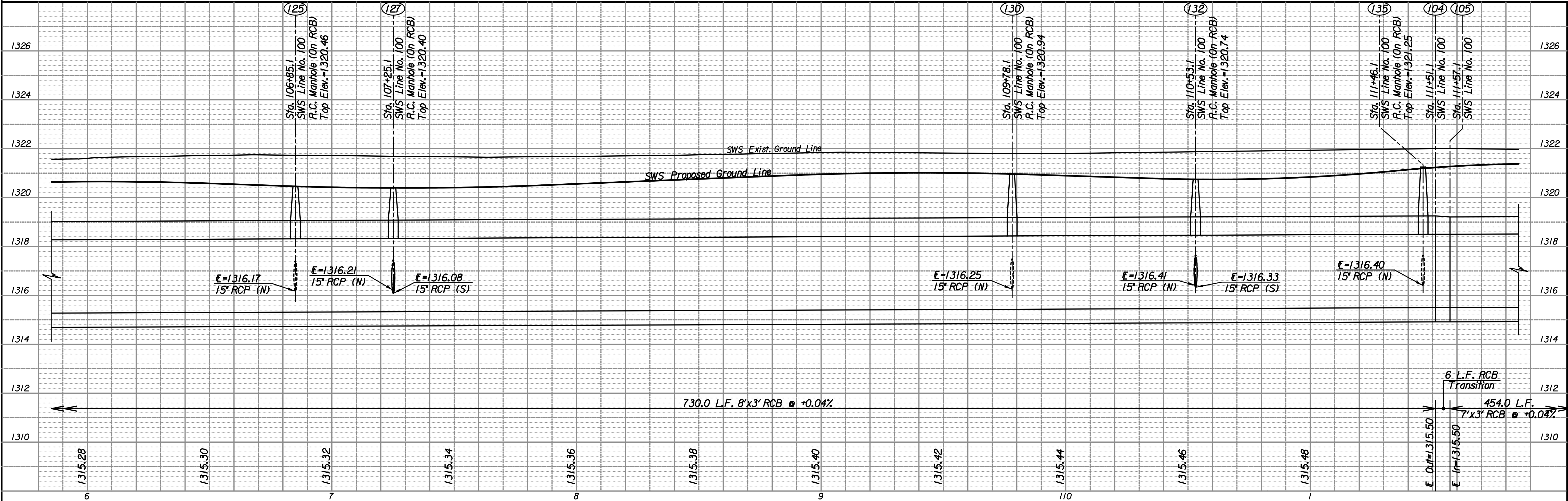

Plotted By: svb Date: 8/2/2013 5:37:56 PM
FILE: I:\2008\08207\SWS\08207-SWS System 100-2.dgn

37TH STREET NORTH
STORM SEWER PLAN
LINE NO. 100

DESIGNED BY: JFS
DRAWN BY: SVB
Job No. 08207 Date August, 2013
Professional Engineering Consultants, P.A.
303 SOUTH TOPEKA WICHITA, KS 67202
316-262-2891 www.pec1.com
Sheet 26 of 193