

Sta. 118+78.3 SWS Line No. 100-
Sta. 5+00 SWS Line No. 114-
Sta. 120+00, 23.50' Lt. & 37th St.
Construct Std. Type I Curb Inlet
L=10'-0" W=5'-0"
Install 42"x27"x58.0' SWS (RCPHE) (E)
Install 18"x46.0' SWS (RCP) (S)
See Sh. No. 48, 55

Sta. 119+36.3 SWS Line No. 100-
Sta. 120+58, 23.50' Lt. & 37th St.
Construct Std. Type I Curb Inlet
L=10'-0" W=5'-0"
Install 42"x27"x167.0' SWS (RCPHE) (E)
See Sh. No. 48, 55

Sta. 121+03.3 SWS Line No. 100-
Sta. 122+25, 23.50' Lt. & 37th St.
Construct Std. Type I Curb Inlet
L=5'-0" W=5'-0"
Install 42"x27"x180.0' SWS (RCPHE) (E)
See Sh. No. 48, 55

Sta. 122+83.3 SWS Line No. 100-
Sta. 5+00 SWS Line No. 115-
Sta. 124+05, 23.50' Lt. & 37th St.
Construct Std. Type I Curb Inlet
L=10'-0" W=5'-0"
Install 24"x20.0' SWS (RCP) (E)
Install 15"x46.0' SWS (RCP) (S)
See Sh. No. 48, 55

Sta. 123+03.3 SWS Line No. 100-
Sta. 124+25, 23' Lt. & 37th St.
Construct Std. Type I Curb Inlet
L=15'-0" W=4'-0"
Install 15"x110.5' SWS (RCP, ACSP,
PEP, or PVC) (NE)
with End Section (114)
See Sh. No. 49, 56, 61-67

Sta. 124+13.8 SWS Line No. 100-
Sta. 125+34, 41' Lt. & 37th St.

Sta. 5+46.0 SWS Line No. 114-
Sta. 120+00, 22.50' Rt. & 37th St.
Construct Std. Type I Curb Inlet
L=10'-0" W=3'-0"
Install 15"x58.0' SWS (RCP) (E)
See Sh. No. 48, 56

Sta. 6+04.0 SWS Line No. 114-
Sta. 120+58, 22.50' Rt. & 37th St.
Construct Std. Type I Curb Inlet
L=10'-0" W=3'-0"
See Sh. No. 48, 56

Sta. 5+46.0 SWS Line No. 115-
Sta. 124+05, 22.50' Rt. & 37th St.
Construct Std. Type I Curb Inlet
L=10'-0" W=3'-0"
See Sh. No. 48, 56

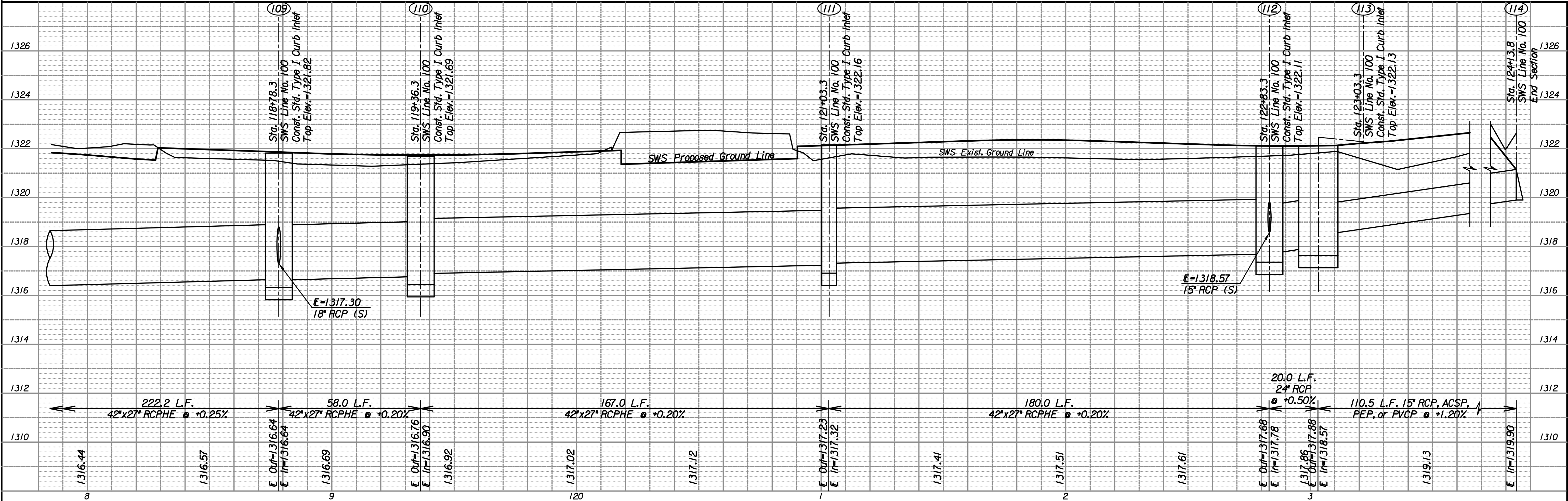
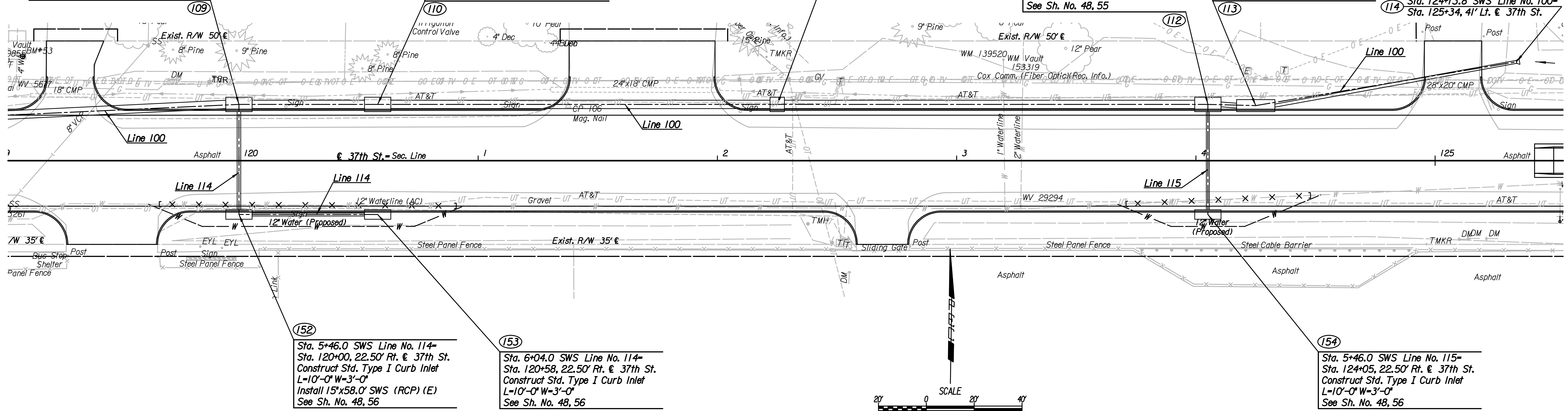

Plotted By: svb Date: 8/2/2013 6:26:50 PM
FILE: I:\2008\08207\SWS\08207-SWS System 100-4.dgn

STORM SEWER PLAN
LINE NO. 100
37TH STREET NORTH

PROFESSIONAL ENGINEERING CONSULTANTS, P.A.
303 SOUTH DOCKA WICHITA, KS 67202
316-262-2891 www.pec1.com

Job No. 08207 Date August, 2013
Designed by JFS Drawn by SVB

Sheet 28 of 193