

Plotted By: svb Date: 8/3/2013 9:39:14 AM
 FILE: I:\2008\08207\SWS\08207-SWS System 600.dgn

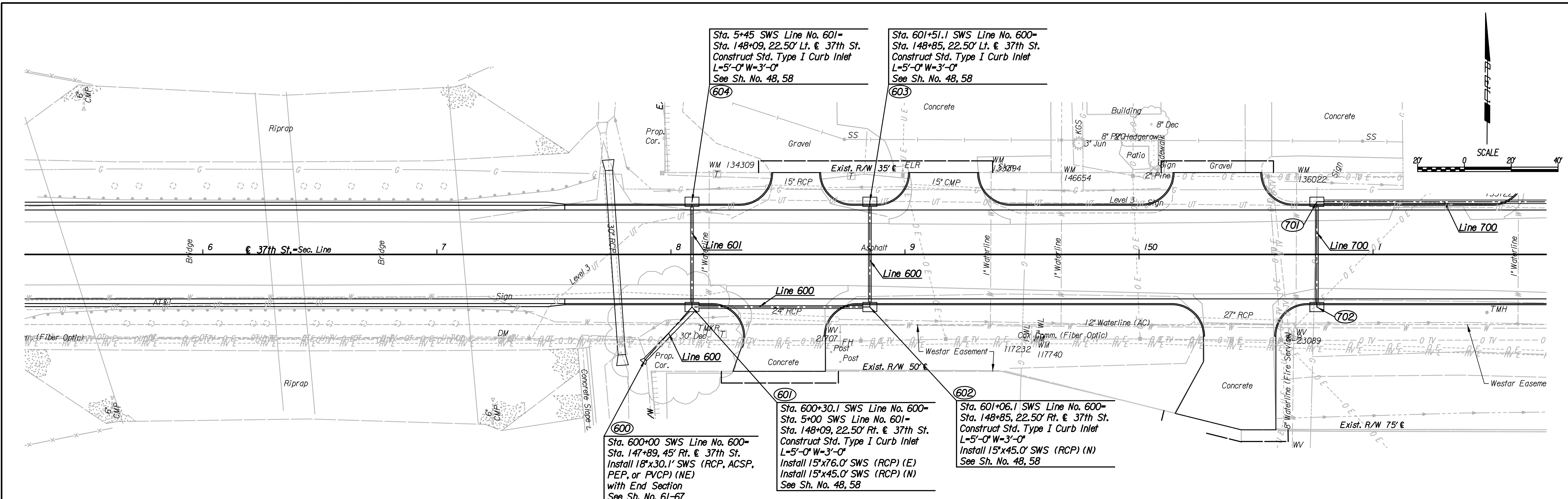

600
 Sta. 600+00 SWS Line No. 600-
 Sta. 147+89, 45' Rt. & 37th St.
 Install 18"x30.1' SWS (RCP, ACSP,
 PEP, or PVC) (NE)
 with End Section
 See Sh. No. 61-67

601
 Sta. 600+30.1 SWS Line No. 600-
 Sta. 5+00 SWS Line No. 601-
 Sta. 148+09, 22.50' Rt. & 37th St.
 Construct Std. Type I Curb Inlet
 L=5'-0" W=3'-0"
 Install 15"x76.0' SWS (RCP) (E)
 Install 15"x45.0' SWS (RCP) (N)
 See Sh. No. 48, 58

602
 Sta. 601+06.1 SWS Line No. 600-
 Sta. 148+85, 22.50' Rt. & 37th St.
 Construct Std. Type I Curb Inlet
 L=5'-0" W=3'-0"
 Install 15"x45.0' SWS (RCP) (N)
 See Sh. No. 48, 58

604
 Sta. 5+45 SWS Line No. 601-
 Sta. 148+09, 22.50' Lt. & 37th St.
 Construct Std. Type I Curb Inlet
 L=5'-0" W=3'-0"
 See Sh. No. 48, 58

603
 Sta. 601+51.1 SWS Line No. 600-
 Sta. 148+85, 22.50' Lt. & 37th St.
 Construct Std. Type I Curb Inlet
 L=5'-0" W=3'-0"
 See Sh. No. 48, 58

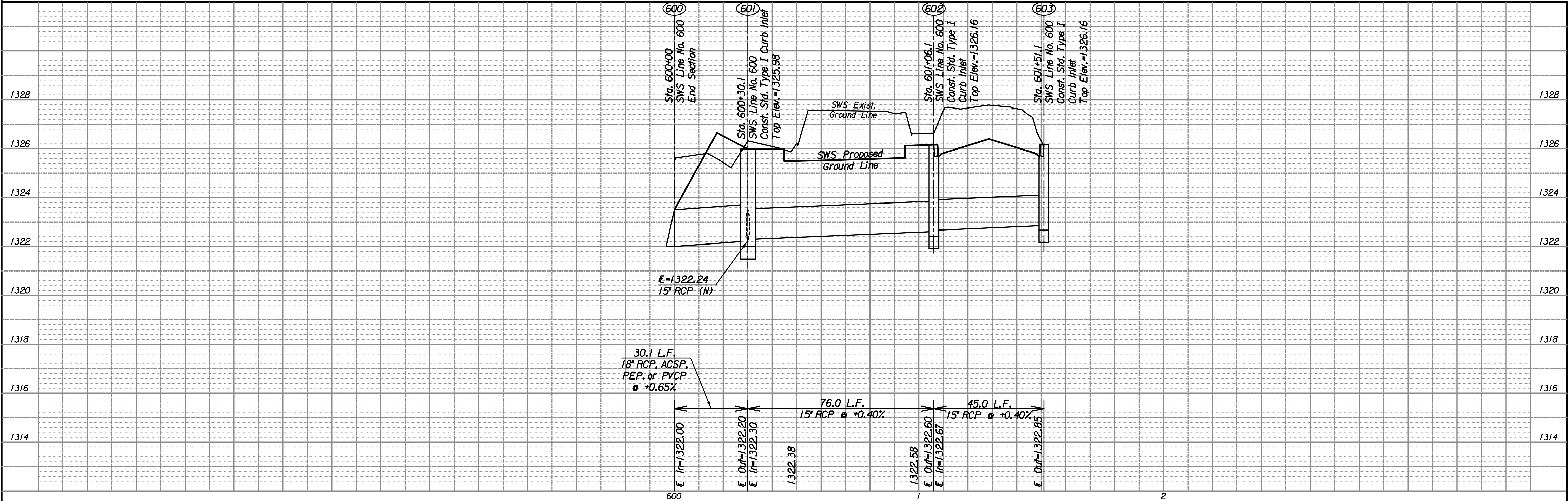

37TH STREET NORTH
STORM SEWER PLAN
 LINE NO. 600

PROFESSIONAL ENGINEERING CONSULTANTS, P.A.
 303 SOUTH DOPEKA WICHITA, KS 67202
 316-262-2891 www.pec1.com

Job No. 08207 Date August, 2013
 Designed by JPS Drawn by SVB