

LONGITUDINAL SECTION

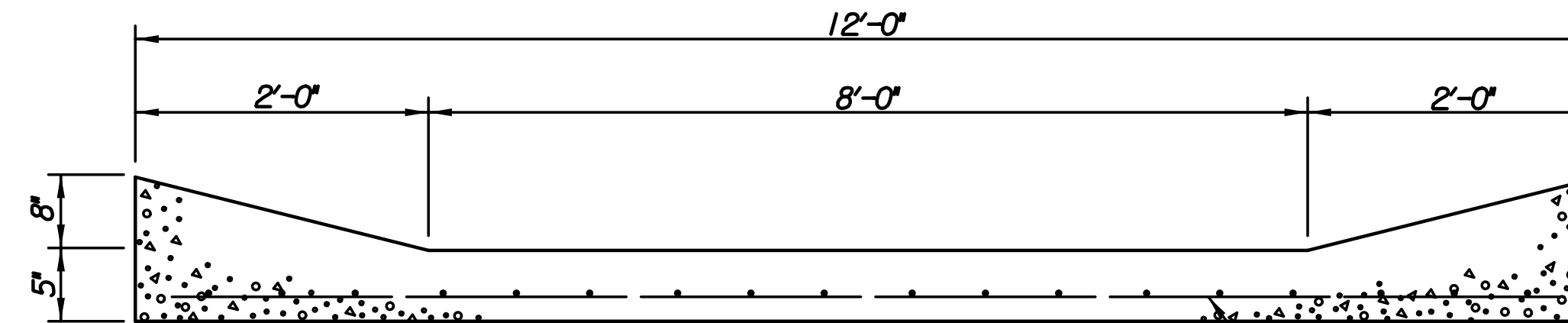

CROSS SECTION

CONCRETE DITCH LINING

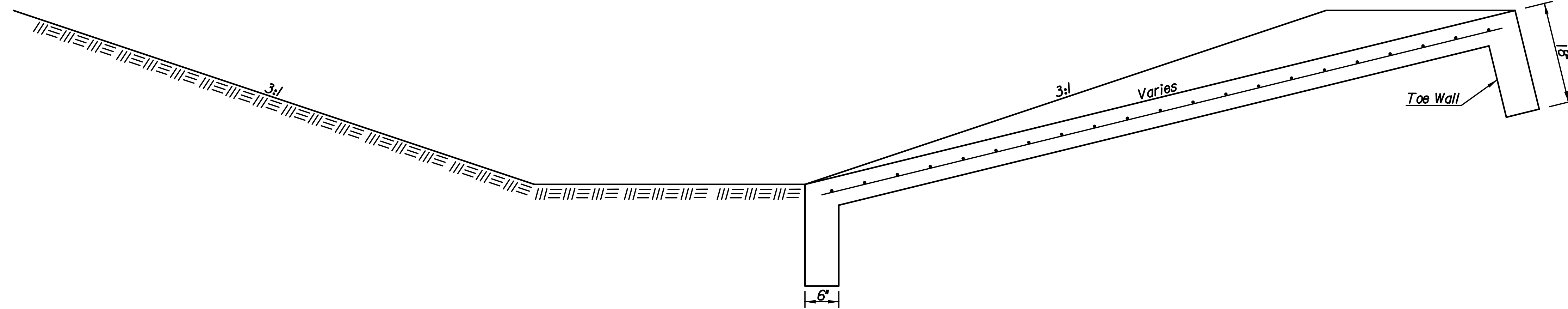

LONGITUDINAL SECTION

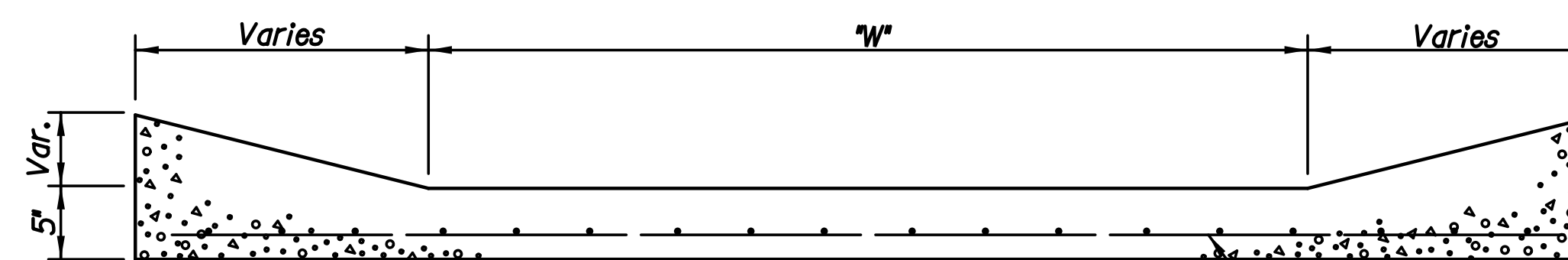

CROSS SECTION

CONCRETE DITCH LINING BACKSLOPE

Note:
 Concrete Grade 3.0 shall be used in Concrete Ditch Lining.
 Reinforcement as shown is included in the unit price bid for "Concrete Ditch Lining".
 Measurements of Concrete Ditch Lining shall be per lineal foot.
 The additional concrete required to construct the toewalls shall be Subsidiary to "Concrete Ditch Lining".
 The exact location and dimensions may be adjusted, if required, by the Engineer at the time of construction.
 Longitudinal construction joints may be constructed at the Contractor's option.

W=2' at Channel "B" Sta. 6+77.75
 W=6' at Channel "B" Sta. 12+72

Plotted By: svb Date: 8/6/2013 10:21:29 AM
 FILE: I:\2008\08207\Standards\08207-Conc Ditch Lining Dtl.dgn

No.	Revision	By	Date
37TH STREET NORTH			
CONCRETE DITCH LINING			
GARY JANZEN, P.E.—CITY ENGINEER CITY OF WICHITA PROJECT NO. 472-84692			
PEC PROFESSIONAL ENGINEERING CONSULTANTS, P.A. 303 SOUTH TOPEKA WICHITA, KS 67202 316-262-2691 www.pec1.com			
Designed by	JPS	Job No.	08207
Drawn by	SVB	Date	August, 2013
			Sht. 47 of 193