

Plotted By: svb Date: 8/5/2013 11:49:55 PM
 FILE: I:\2008\0820\Traffic Control\08207-TC Stage 2 107.dgn

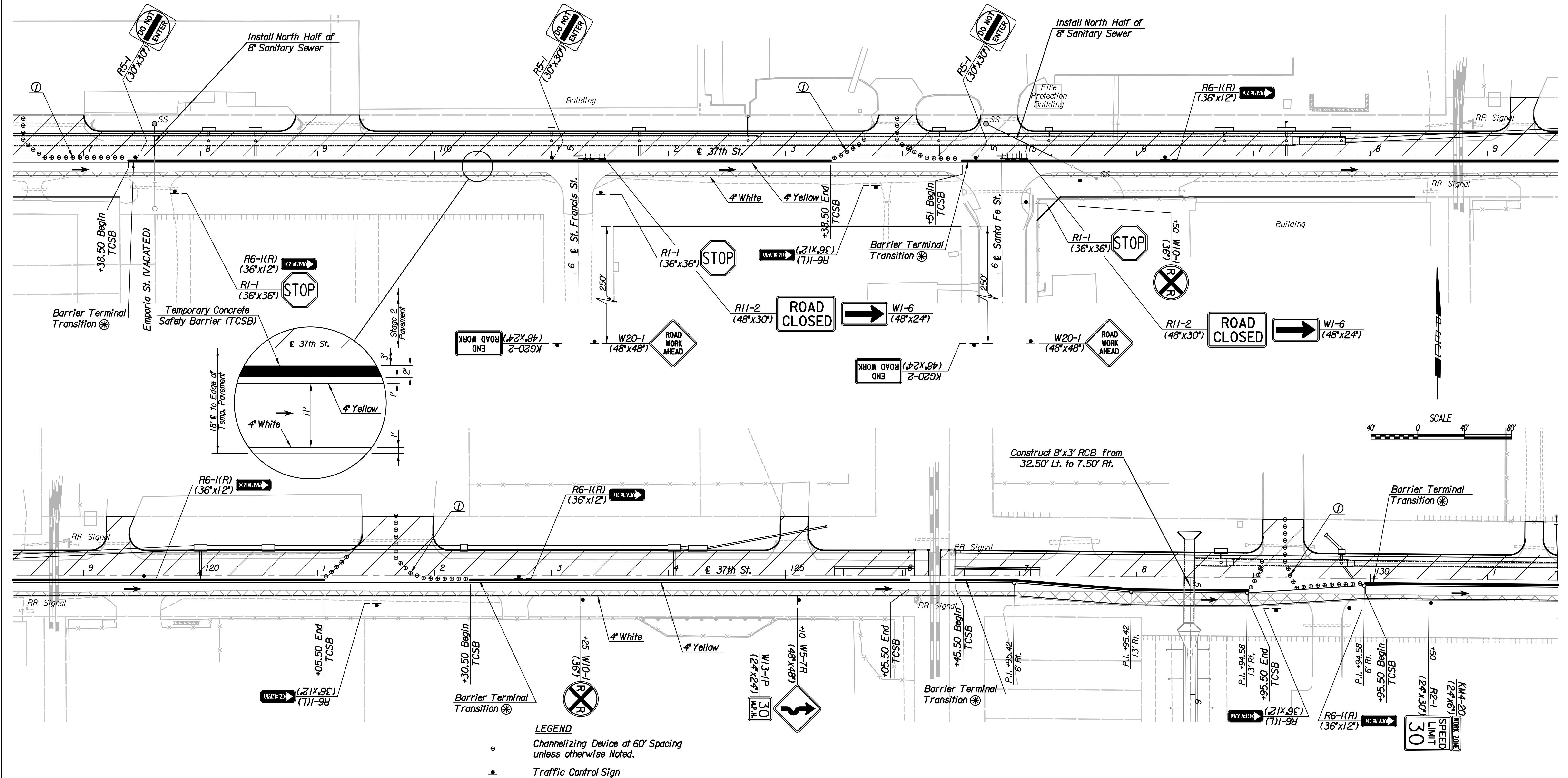

Note: Utilities are not shown on Traffic Control Plans. The Contractor is responsible for verification as to type and location of underground utilities as may be necessary to avoid damage thereto. The Contractor is responsible for repairing any damage to underground utilities.

- LEGEND**
- Channelizing Device at 60' Spacing unless otherwise Noted.
 - Traffic Control Sign
 - ▤ Type III Barricades
 - ⊗ Install Type I Object Marker at end of Barrier Terminal
 - ▨ Work Area (New Pavement)
 - ▩ Temporary Pavement for Detours
 - Direction of Traffic
- Note: Signs and barricades are shown diagrammatically only. Contractor will be responsible to install the required number of posts to support the installation.

① Place channelizing devices as necessary during construction to restrict access to work area.

Moving temporary concrete safety barrier, channelizing devices, and signs, and additional traffic control may be necessary to construct entrances. Maintain all weather access at all times during construction. This shall be considered Subsidiary.

Revision		By	Date
37TH STREET NORTH			
TRAFFIC CONTROL PLAN			
STAGE 2 - STA. 107+00 TO STA. 131+00			
GARY JANZEN, P.E.-CITY ENGINEER CITY OF WICHITA PROJECT NO. 472-84692			
PEC		PROFESSIONAL ENGINEERING CONSULTANTS, P.A. 303 SOUTH TOPEKA WICHITA, KS 67202 316-262-2691 www.pec1.com	
Designed by	JPS	Job No.	08207
Drawn by	SVB	Date	August, 2013
			Sht. 126 of 193