

Remove Broken White (4 Each) for Construction of Stage 1 Traffic Control. Replace Broken White (4 Each) upon Completion of Traffic Control Stage 2.

Remove Turn Arrows (2 Each) for Construction of Stage 1 Traffic Control. Replace Turn Arrows (2 Each) upon Completion of Traffic Control Stage 2.

Remove Broken White (3 Each) for Construction of Stage 1 Traffic Control. Replace Broken White (3 Each) upon Completion of Traffic Control Stage 2.

4" Double Yellow
Saw Cut (Subsidiary)

Remove Broken White (14 Each) for Construction of Stage 1 Traffic Control. Replace Broken White (14 Each) upon Completion of Traffic Control Stage 2.

Remove Double Yellow (500 L.F.) for Construction of Stage 1 Traffic Control. Replace Double Yellow (500 L.F.) upon Completion of Traffic Control Stage 2.

Remove Diagonal Line (153 L.F.) for Construction of Stage 1 Traffic Control. Replace Diagonal Line (153 L.F.) upon Completion of Traffic Control Stage 2.

Remove 6" White (230 L.F.) for Construction of Stage 1 Traffic Control. Replace 6" White (230 L.F.) upon Completion of Traffic Control Stage 2.

Contractor Shall Contact City of Wichita Traffic for Adjustments to Traffic Signal Phasing/Timing as Necessary. Contractor Shall Cover all Traffic Signal Heads in Conflict with Changes to Traffic Signal Phasing. Per City of Wichita Specifications.

LEGEND

- × FIXED CHANNELIZING DEVICE AT 50' SPACING OR SPACING AS NOTED.
- CHANNELIZING DEVICE AT 50' SPACING OR SPACING AS NOTED.
- LLL TYPE III BARRICADE WITH TYPE A LOW INTENSITY FLASHING WARNING LIGHTS.
- * SIGN TO BE MOUNTED ON TYPE III BARRICADE
- ▨ WORK AREA

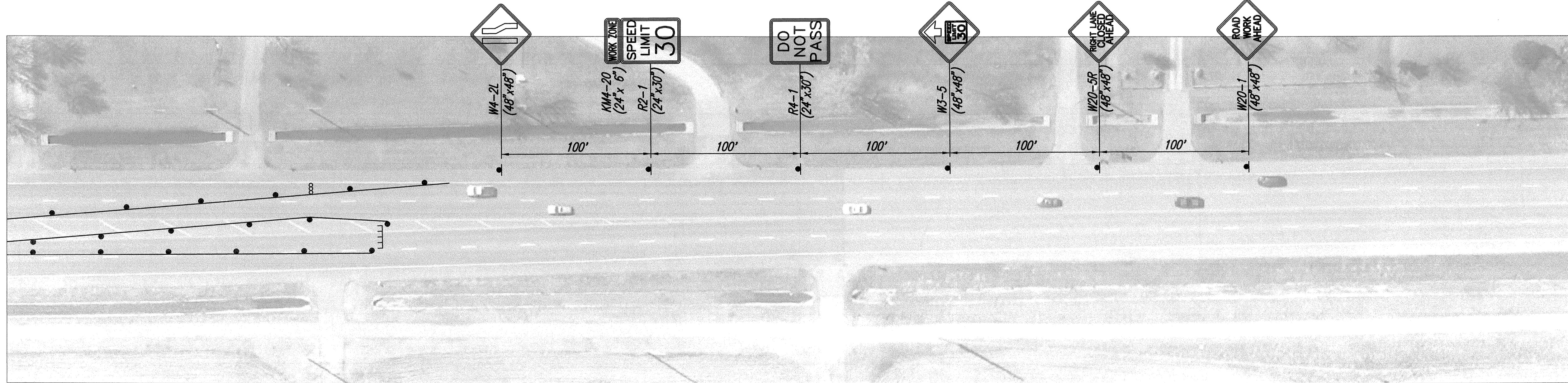

Saved 12-17-2013 8:46:50 AM by BJS
 Plot Scale: 1:40 12-17-2013 2:03:38 PM by BJS
 CA\2012\12568\000_001\12568-001-425-TRAFFIC CONTROL-STAGE 1

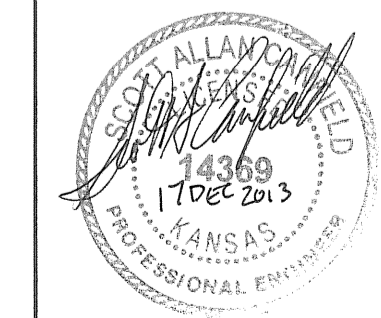

No.	Revision	By	Date
MAIZE ROAD PAVING AND DRAINAGE IMPROVEMENTS LOT 1, BLOCK 1 NEWMARKET V ADDITION TRAFFIC CONTROL-STAGE 1 GARY JANZEN, P.E.—CITY ENGINEER CITY OF WICHITA PROJECT NO. 472-84607			
		PROFESSIONAL ENGINEERING CONSULTANTS, P.A. 303 SOUTH TOPEKA WICHITA, KS 67202 316-262-2691 www.pec1.com	
Designed by	CSB	Job No.	35-12568-000/001
Drawn by	BJS	Date	September 2013
			Sht. 42 of 65