

Sheet 12 of 65 - 0913 8:17:00 AM by BJS
 Plot Scale: 1"=40' - 12-17-2013 2:06:27 PM by BJS
 03/20/13 12:58:00 00112568-001-435-TRAFFIC CONTRL-STAGE 2

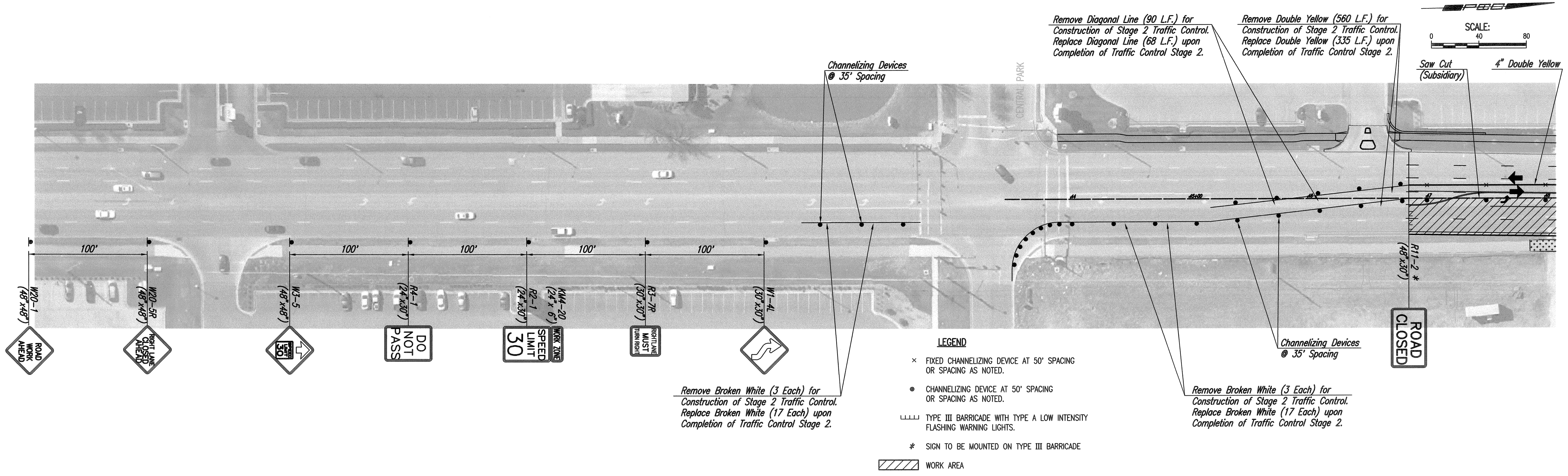

① Channelizing Devices are to be Relocated to the Solid White Line While Work is in Progress. At the Completion of Work and During Non-work Periods the Channelizing Devices Shall be in the Standard Location.

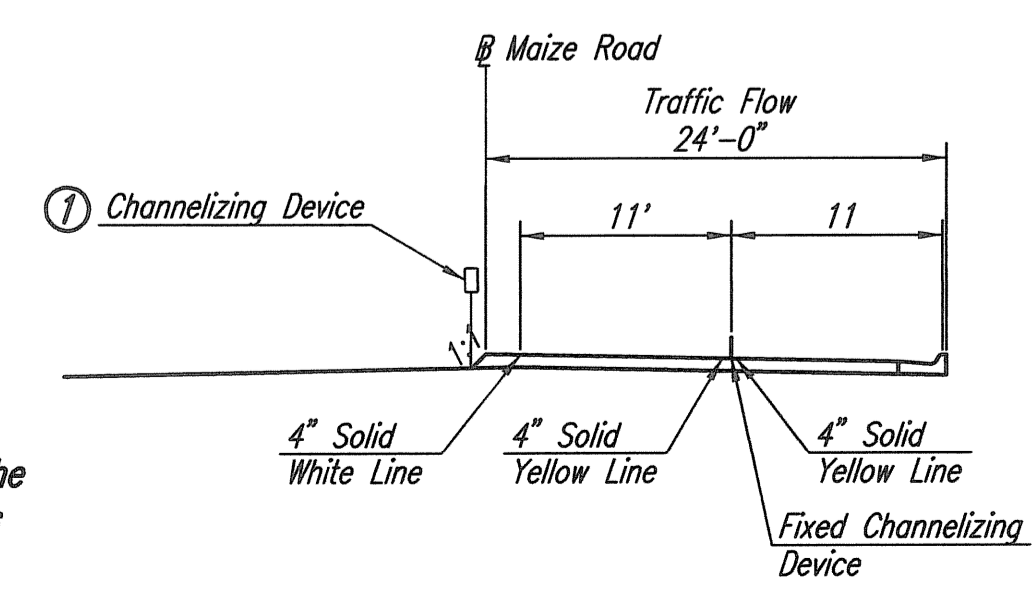

STAGE I TYPICAL TRAFFIC CONTROL SPACING

		No. _____ Revision _____ By _____ Date _____
MAIZE ROAD PAVING AND DRAINAGE IMPROVEMENTS LOT 1, BLOCK 1 NEWMARKET V ADDITION TRAFFIC CONTROL-STAGE 2 GARY JANZEN, P.E.-CITY ENGINEER CITY OF WICHITA PROJECT NO. 472-84607		
PROFESSIONAL ENGINEERING CONSULTANTS, P.A. 303 SOUTH TOPEKA WICHITA, KS 67202 316-262-2891 www.pec1.com		
Designed by CSB Drawn by BJS	Job No. 35-12568-000/001 Date September 2013	Sht. 43 of 65