

NO.	Δ	R	T	L	E	CURVE DATA							
						P.C. COORDINATES		P.I. COORDINATES		P.T. COORDINATES		C.C. COORDINATES	
						NORTH	EAST	NORTH	EAST	NORTH	EAST	NORTH	EAST
FC009	01° 57' 24"	1,501.25	25.64	51.27	0.22	1,700,112.1403	1,686,227.4163	1,700,137.7769	1,686,227.1788	1,700,163.4067	1,686,227.8167	1,700,126.0523	1,687,728.6019
FC010	02° 08' 51"	1,465.00	27.46	54.91	0.26	1,700,127.6051	1,686,264.2161	1,700,155.0620	1,686,263.8702	1,700,182.5126	1,686,264.5535	1,700,146.0601	1,687,729.0999
FC011	02° 08' 51"	1,502.00	28.15	56.30	0.26	1,700,273.6424	1,686,266.8217	1,700,301.7863	1,686,267.5222	1,700,329.9367	1,686,267.1675	1,700,311.0156	1,684,765.2867
FC012	01° 32' 01"	1,465.75	19.62	39.23	0.13	1,700,274.5444	1,686,230.5829	1,700,294.1545	1,686,231.0710	1,700,313.7706	1,686,231.0341	1,700,311.0156	1,684,765.2867
FC013	16° 49' 21"	148.75	22.00	43.67	1.62	1,700,313.7706	1,686,231.0341	1,700,335.7660	1,686,230.9928	1,700,356.8082	1,686,224.5875	1,700,313.4910	1,686,082.2844
FC014	16° 12' 31"	151.25	21.54	42.79	1.53	1,700,356.8082	1,686,224.5875	1,700,377.4123	1,686,218.3156	1,700,398.9482	1,686,218.0443	1,700,400.8535	1,686,369.2823
FC015	180° 00' 00"	8.50	-----	26.70	-----	1,700,589.1831	1,686,215.6476	-----	-----	1,700,588.9689	1,686,198.6490	1,700,589.0760	1,686,207.1483
FC016	85° 33' 03"	28.00	25.91	41.81	10.15	1,700,584.8433	1,686,263.9561	1,700,610.7473	1,686,263.6298	1,700,613.0821	1,686,289.4304	1,700,585.1960	1,686,291.9539
FC017	94° 26' 57"	20.00	21.62	32.97	9.45	1,700,632.8961	1,686,508.3846	1,700,634.8443	1,686,529.9132	1,700,613.2294	1,686,530.1855	1,700,612.9775	1,686,510.1871
FC018	190° 40' 25"	8.75	-----	29.12	-----	1,700,645.3094	1,686,296.0676	-----	-----	1,700,662.6362	1,686,294.2285	1,700,653.8869	1,686,294.3388
FC019	90° 00' 01"	28.00	28.00	43.98	11.60	1,700,688.5931	1,686,290.6514	1,700,688.2403	1,686,262.6535	1,700,716.2382	1,686,262.3008	1,700,716.5909	1,686,290.2986
FC020	23° 04' 26"	151.25	30.87	60.91	3.12	1,701,006.0250	1,686,217.3967	1,701,036.8963	1,686,217.0078	1,701,065.1455	1,686,204.5509	1,701,004.1197	1,686,066.1587
FC021	23° 04' 26"	148.75	30.36	59.90	3.07	1,701,065.1455	1,686,204.5509	1,701,092.9278	1,686,192.3000	1,701,123.2888	1,686,191.9175	1,701,125.1627	1,686,340.6557
FC022	23° 04' 26"	148.75	30.36	59.90	3.07	1,701,211.6781	1,686,219.8062	1,701,242.0392	1,686,219.4237	1,701,269.8214	1,686,207.1728	1,701,209.8043	1,686,071.0680
FC023	23° 04' 26"	151.25	30.87	60.91	3.12	1,701,269.8214	1,686,207.1728	1,701,298.0706	1,686,194.7159	1,701,328.9420	1,686,194.3270	1,701,330.8473	1,686,345.5650
FC024	15° 33' 49"	148.00	20.23	40.20	1.38	1,701,322.1396	1,686,254.6675	1,701,342.3635	1,686,254.4127	1,701,361.9143	1,686,259.5935	1,701,324.0040	1,686,402.6557
FC025	15° 33' 49"	152.00	20.77	41.29	1.41	1,701,361.9143	1,686,259.5935	1,701,381.9935	1,686,264.9143	1,701,402.7640	1,686,264.6526	1,701,400.8492	1,686,112.6647

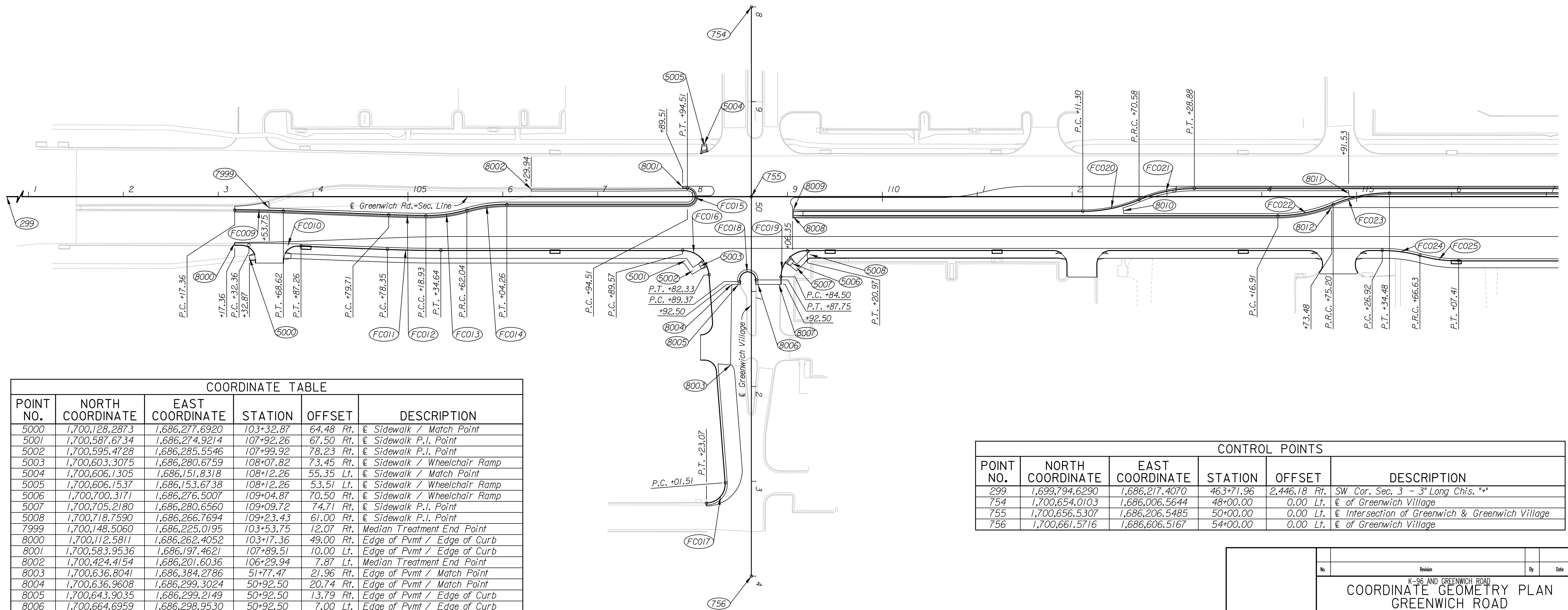
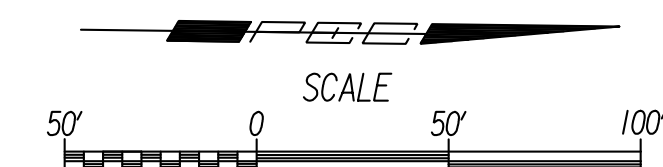

COORDINATE TABLE					
POINT NO.	NORTH COORDINATE	EAST COORDINATE	STATION	OFFSET	DESCRIPTION
5000	1,700,128.2873	1,686,277.6920	103+32.87	64.48 Rt.	Edge of Pvm / Match Point
5001	1,700,587.6734	1,686,274.9214	107+92.26	67.50 Rt.	Edge of Pvm / Match Point
5002	1,700,595.4728	1,686,285.5546	107+99.92	78.23 Rt.	Edge of Pvm / Match Point
5003	1,700,603.3075	1,686,280.6759	108+07.82	73.45 Rt.	Edge of Pvm / Match Point
5004	1,700,606.1305	1,686,151.8318	108+12.26	55.35 Lt.	Edge of Pvm / Match Point
5005	1,700,606.1537	1,686,153.6738	108+12.26	53.51 Lt.	Edge of Pvm / Match Point
5006	1,700,700.3171	1,686,276.5007	109+04.87	70.50 Rt.	Edge of Pvm / Match Point
5007	1,700,705.2180	1,686,280.6560	109+09.72	74.71 Rt.	Edge of Pvm / Match Point
5008	1,700,718.7590	1,686,266.7694	109+23.43	61.00 Rt.	Edge of Pvm / Match Point
7999	1,700,148.5060	1,686,225.0195	103+53.75	12.07 Rt.	Median Treatment End Point
8000	1,700,112.5811	1,686,262.4052	103+17.36	49.00 Rt.	Edge of Pvm / Edge of Curb
8001	1,700,583.9536	1,686,197.4621	107+89.51	10.00 Lt.	Edge of Pvm / Edge of Curb
8002	1,700,424.4154	1,686,201.6036	106+29.94	7.87 Lt.	Median Treatment End Point
8003	1,700,636.8041	1,686,384.2786	51+77.47	21.96 Rt.	Edge of Pvm / Match Point
8004	1,700,636.9608	1,686,299.3024	50+92.50	20.74 Rt.	Edge of Pvm / Match Point
8005	1,700,643.9035	1,686,299.2149	50+92.50	13.79 Rt.	Edge of Pvm / Edge of Curb
8006	1,700,664.6959	1,686,298.9530	50+92.50	7.00 Lt.	Edge of Pvm / Edge of Curb
8007	1,700,686.6941	1,686,298.6758	50+92.50	29.00 Lt.	Edge of Pvm / Edge of Curb
8008	1,700,701.1825	1,686,227.4877	109+06.35	21.50 Rt.	Edge of Pvm / Edge of Curb
8009	1,700,701.0880	1,686,219.9883	109+06.35	14.00 Rt.	Edge of Pvm / Edge of Curb
8010	1,701,048.9687	1,686,216.3556	112+54.25	14.75 Rt.	Median Treatment End Point
8011	1,701,285.9982	1,686,195.3680	114+91.53	3.25 Lt.	Median Treatment End Point
8012	1,701,268.1408	1,686,210.3442	114+73.48	11.50 Rt.	Edge of Pvm / Saw Cut

CONTROL POINTS					
POINT NO.	NORTH COORDINATE	EAST COORDINATE	STATION	OFFSET	DESCRIPTION
299	1,699,794.6290	1,686,217.4070	463+71.96	2,446.18 Rt.	SW Cor. Sec. 3 - 3" Long Chis. "A"
754	1,700,654.0103	1,686,006.5644	48+00.00	0.00 Lt.	Edge of Greenwich Village
755	1,700,656.5307	1,686,206.5485	50+00.00	0.00 Lt.	Edge of Intersection of Greenwich & Greenwich Village
756	1,700,661.5716	1,686,606.5167	54+00.00	0.00 Lt.	Edge of Greenwich Village

Plotted By: cp
 Date: 12/30/2013 11:34:07 AM
 FILE: I:\2009\0952\Geometry\0952-geom-sr101.dgn

No.	Revision	By	Date
K-96 AND GREENWICH ROAD COORDINATE GEOMETRY PLAN GREENWICH ROAD STA. 101+00 TO STA. 117+00 GARY JANZEN, P.E.-CITY ENGINEER CITY OF WICHITA PROJECT NO. 472-85066			
		PROFESSIONAL ENGINEERING CONSULTANTS, P.A. 303 SOUTH TOPEKA WICHITA, KS 67202 316-262-2691 www.pec1.com	
Designed by	JPS	Job No.	09521
Drawn by	CP	Date	Jan., 2014
			Sht. 26 of 388