

RETAINING WALL TYPICAL SECTION

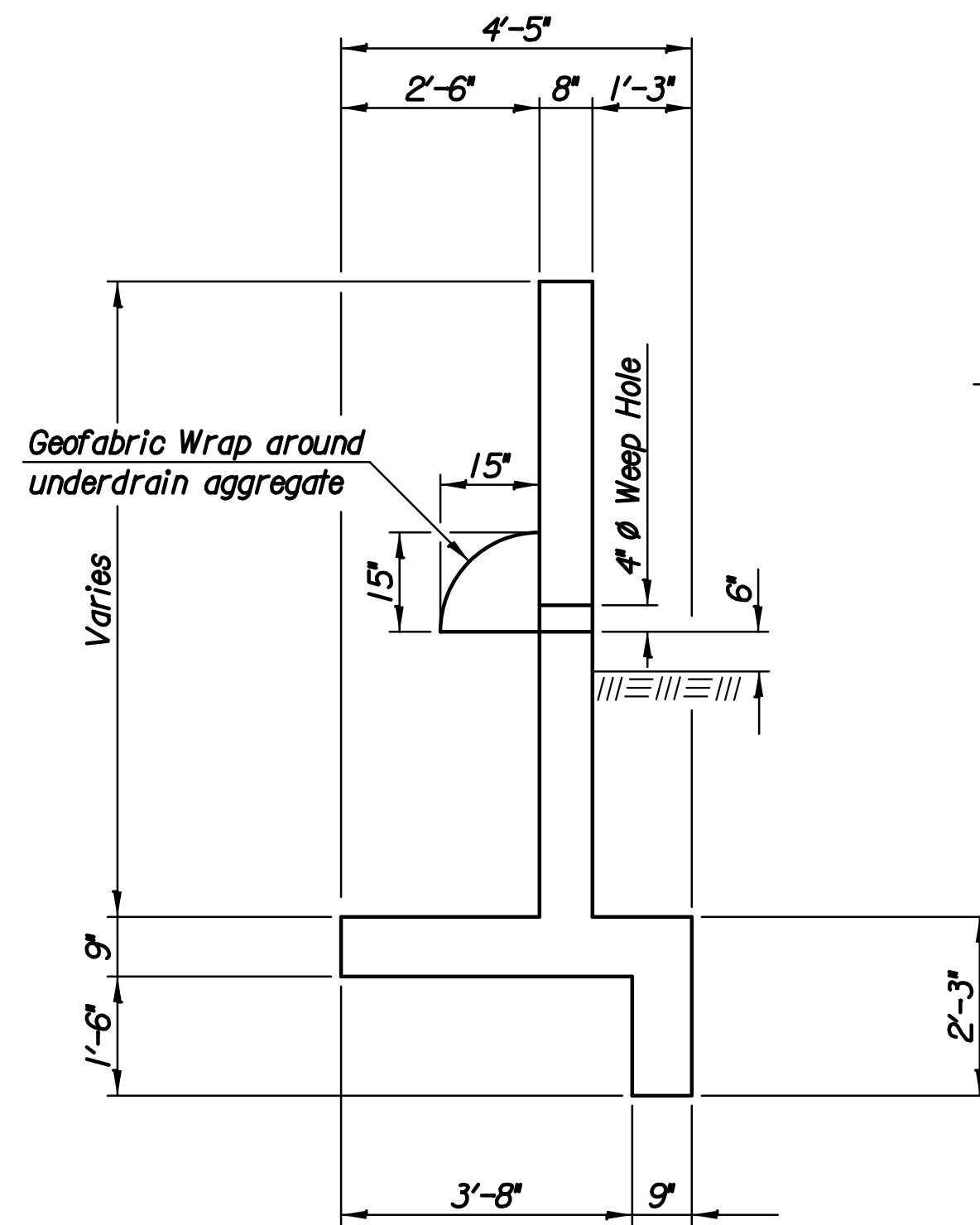

TYPICAL WEEP HOLE DETAIL

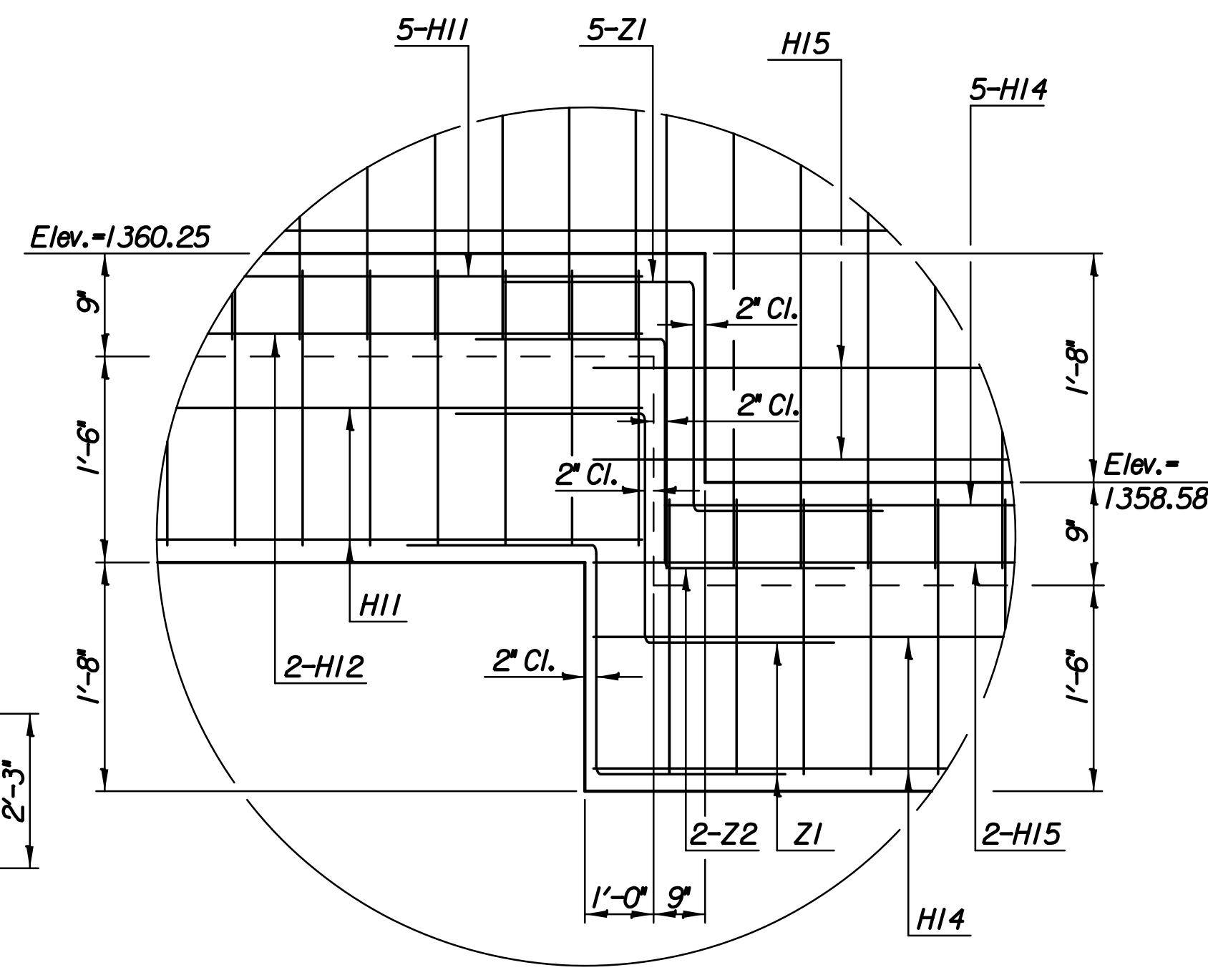

DETAIL A

Retaining Wall along Ramp W-NS

BILL OF MATERIALS							
REINFORCING STEEL							
Mark	No.	Size	Length	Mark	No.	Size	Length
H1	10	#5	39'-1"	L1	77	#5	Varies
H2	2	#5	31'-5"	L2	98	#5	Varies
H3	1	#5	8'-0"	L3	59	#5	Varies
H4	14	#4	38'-11"	L4	119	#5	9'-0"
H5	2	#5	39'-1"	L5	356	#5	6'-0"
H6	14	#5	50'-10"				
H7	1	#5	55'-3"				
H8	14	#4	50'-8"				
H9	2	#5	50'-10"				
H10	12	#5	50'-10"				
H11	7	#4	58'-2"				
H12	2	#5	58'-2"	Z1	7	#4	7'-2"
H13	2	#5	50'-10"	Z2	2	#5	7'-2"
H14	7	#4	41'-2"				
H15	4	#5	41'-2"				
H16	20	#5	39'-1"				
H17	14	#4	38'-11"				

Retaining Wall along Ramp NS-W

BILL OF MATERIALS							
REINFORCING STEEL							
Mark	No.	Size	Length	Mark	No.	Size	Length
H20	10	#5	38'-3"	L5	216	#5	6'-0"
H21	14	#4	38'-1"	L6	76	#5	Varies
H22	2	#5	36'-5"	L7	94	#5	8'-0"
H23	1	#5	47'-2"	L8	46	#5	Varies
H24	1	#5	23'-7"				
H25	2	#5	38'-5"				
H26	18	#5	47'-4"				
H27	14	#4	47'-2"				
H28	6	#5	44'-8"				
H29	1	#5	30'-10"				
H30	1	#5	15'-5"	U1	4	#5	12'-4"
H31	7	#4	44'-8"				
H32	1	#5	44'-9"				

**SUMMARY OF QUANTITIES

Item	Quantity	Unit
* Concrete (Grade 4.0)	107.0	C.Y.
* Reinforcing Steel (Gr. 60)	10,067	Lbs

**SUMMARY OF QUANTITIES

Item	Quantity	Unit
* Concrete (Grade 4.0)	62.0	C.Y.
* Reinforcing Steel (Gr. 60)	5,919	Lbs

*Concrete shall meet 4000 psi 28-day compressive strength and be air-entrained.

**For Information Only. The amount of completed and accepted work shall be paid for at the contract unit price bid per lineal foot for "Retaining Wall Concrete" and shall be considered full compensation for furnishing all material, equipment and labor necessary to complete the work.

Note: All weepholes to be formed with 4" Dia. Schedule 40 PVC pipe spaced at 25'-0" max spacing between expansion joints. All outfalls to be fitted with rodent protectant screen.

Retaining walls shall be built from expansion joint to expansion joint. Provide 3/4" Type B expansion joint material in stemwall and footing. Short all reinforcing steel 2" from expansion joint locations.

Bevel all exposed corners with 3/4" triangular molding.

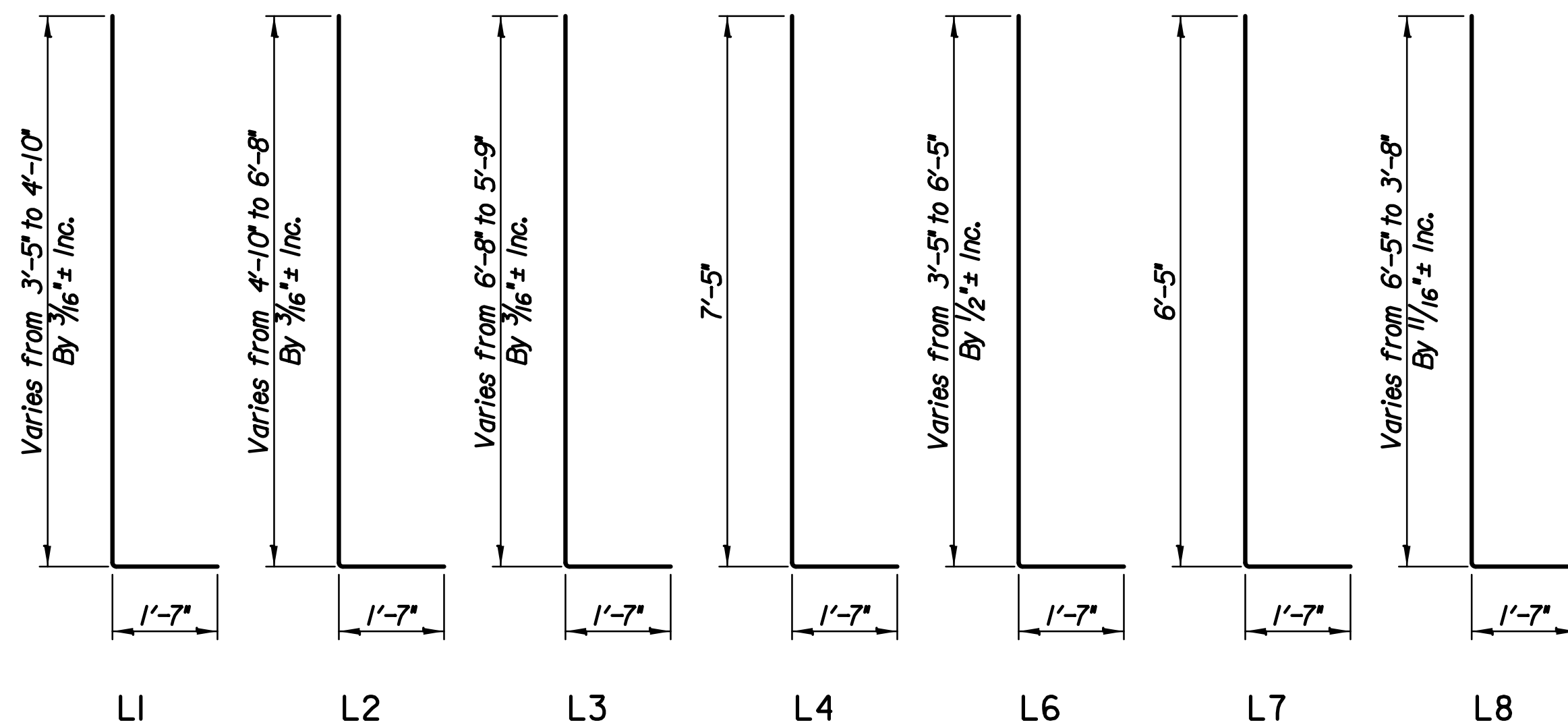

BENDING DIAGRAM

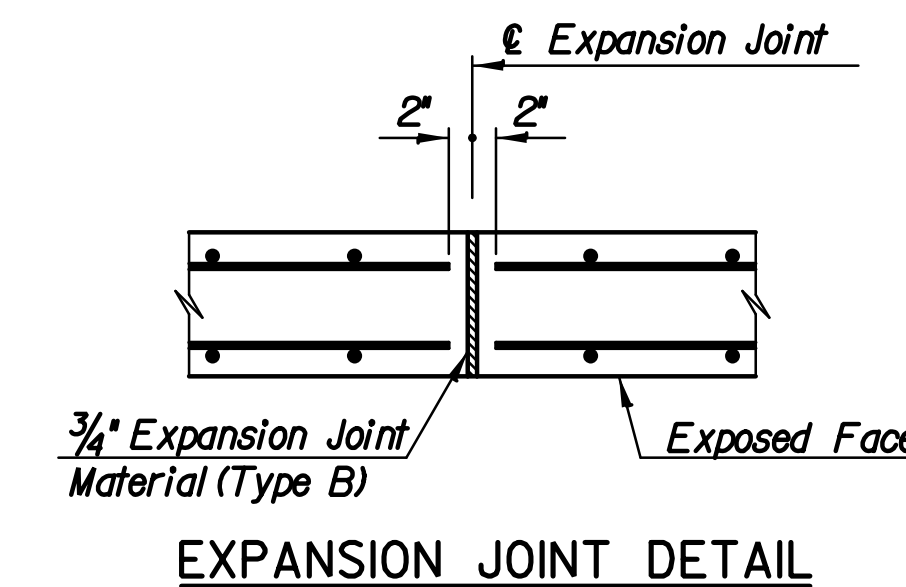
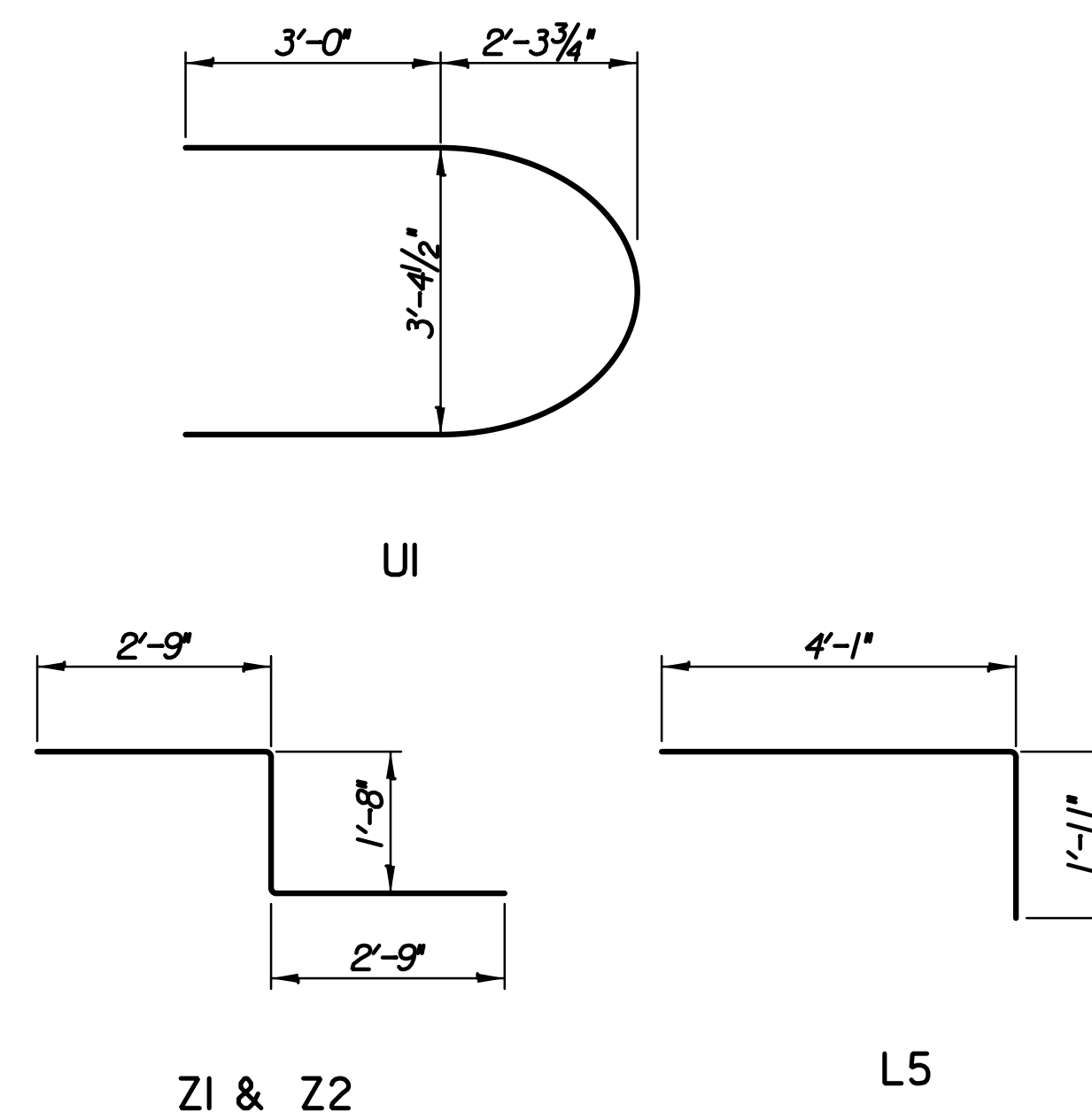

SPLICE	
Size	Length
#4	1'-8"
#5	2'-0"

No.	Revisions	By	Date

Ramp W-NS STA. 457+49.82 to 460+81.84
Ramp NS-W STA. 459+00.00 to 461+00.63

RETAINING WALL DETAILS

K-96 OVER GREENWICH ROAD
PROJECT NO. 472-85066 SEDGWICK COUNTY

Professional Engineering Consultants, P.A.
303 S. TOPEKA • WICHITA, KANSAS 67202
316-262-2691 • FAX 316-262-3003

Designed by	C.W.P.J.	Checked by	R.A.S.
Drawn by	C.P.	Date	Jan. 2014
		Job No.	09521