

- LEGEND**
- Channelizing Device at 40' Spacing unless otherwise noted.
 - ▲ Traffic Control Sign
 - Direction of Traffic
 - ▨ Remove Existing Median and Replace with Temporary Bituminous Pavement

Note: Signs and barricades are shown diagrammatically only. Contractor will be responsible to install the required number of posts to support the installation.

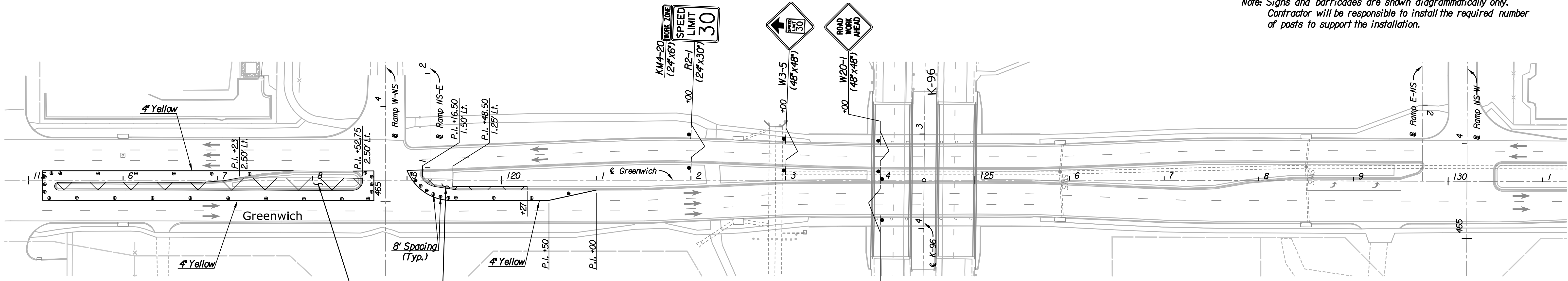

Remove Existing Median as Shown and Replace with Temporary Bituminous Pavement for Traffic Handling

Remove Existing Median as Shown and Replace with Temporary Bituminous Pavement for Traffic Handling

Note: Utilities are not shown on Traffic Control Plans. The Contractor is responsible for verification as to type and location of underground utilities as may be necessary to avoid damage thereto. The Contractor is responsible for repairing any damage to underground utilities.

| | | | |
|--|----------|---------|-----------------|
| No. | Revision | By | Date |
| K-96 AND GREENWICH ROAD | | | |
| TRAFFIC CONTROL PLAN | | | |
| STAGE I- GREENWICH ROAD | | | |
| GARY JANZEN, P.E.-CITY ENGINEER CITY OF WICHITA PROJECT NO. 472-85066 | | | |
| PEC PROFESSIONAL ENGINEERING CONSULTANTS, P.A. 303 SOUTH TOPEKA WICHITA, KS 67202 316-262-2691 www.pec1.com | | | |
| Designed by | JPS | Job No. | 09521 |
| Drawn by | SVB | Date | Jan., 2014 |
| | | | Sht. 258 of 388 |

Plotted By: svb Date: 12/31/2013 7:58:40 AM
 FILE: I:\2009\09521\Traffic Control\09521-TC Greenwich Stage 1.dgn