

Plotted By: svb Date: 12/31/2013 8:34:08 AM
 FILE: I:\2009\0952\Traffic Control\0952-TC Greenwich Stage 3 Sta 117.dgn

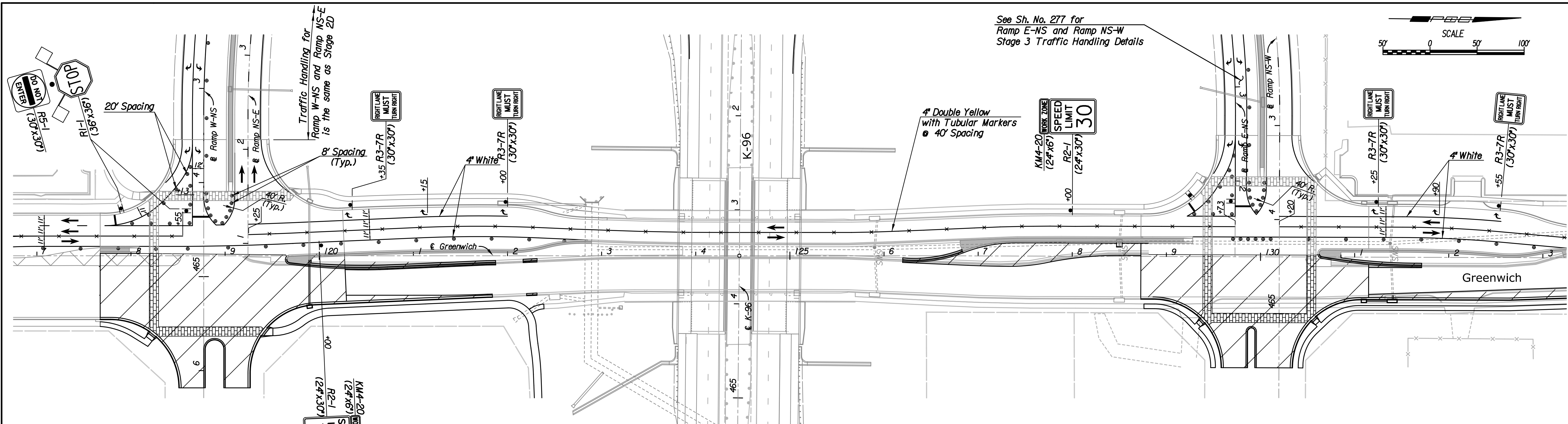

See Sh. No. 277 for
 Ramp E-NS and Ramp NS-W
 Stage 3 Traffic Handling Details

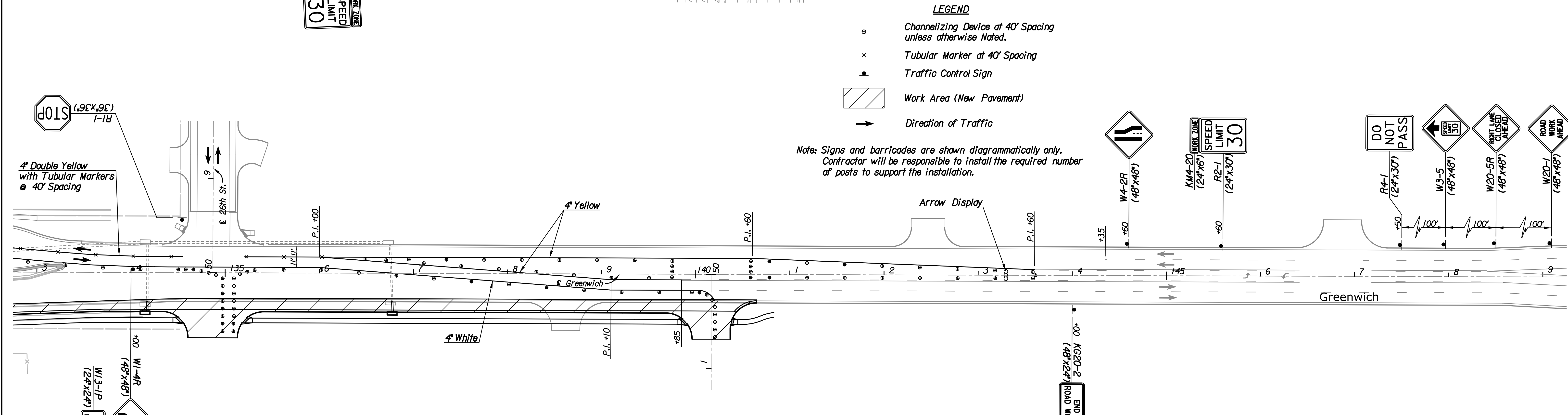
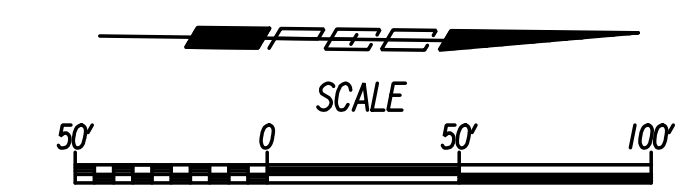

Note: Utilities are not shown on Traffic Control Plans. The Contractor is responsible for verification as to type and location of underground utilities as may be necessary to avoid damage thereto. The Contractor is responsible for repairing any damage to underground utilities.

- LEGEND**
- ⊙ Channelizing Device at 40' Spacing unless otherwise Noted.
 - × Tubular Marker at 40' Spacing
 - ▲ Traffic Control Sign
 - ▨ Work Area (New Pavement)
 - Direction of Traffic

Note: Signs and barricades are shown diagrammatically only. Contractor will be responsible to install the required number of posts to support the installation.

No.	Revision	By	Date
K-96 AND GREENWICH ROAD			
TRAFFIC CONTROL PLAN			
STAGE 3 - STA. 117+00 TO STA. 148+00			
GARY JANZEN, P.E.-CITY ENGINEER CITY OF WICHITA PROJECT NO. 472-85066			
PEC PROFESSIONAL ENGINEERING CONSULTANTS, P.A. 303 SOUTH TOPEKA WICHITA, KS 67202 316-262-2691 www.pec1.com			
Designed by	JPS	Job No.	09521
Drawn by	SVB	Date	Jan., 2014
			Sh. 279 of 388