

WATER DISTRIBUTION SYSTEM IMPROVEMENTS

TO SERVE GLEN MEADOWS 2ND ADDITION

CITY OF WICHITA PROJECT NO. 448-90450
OCA NO. 735498

CITY OF WICHITA, KANSAS

GARY JANZEN, P.E. - CITY ENGINEER

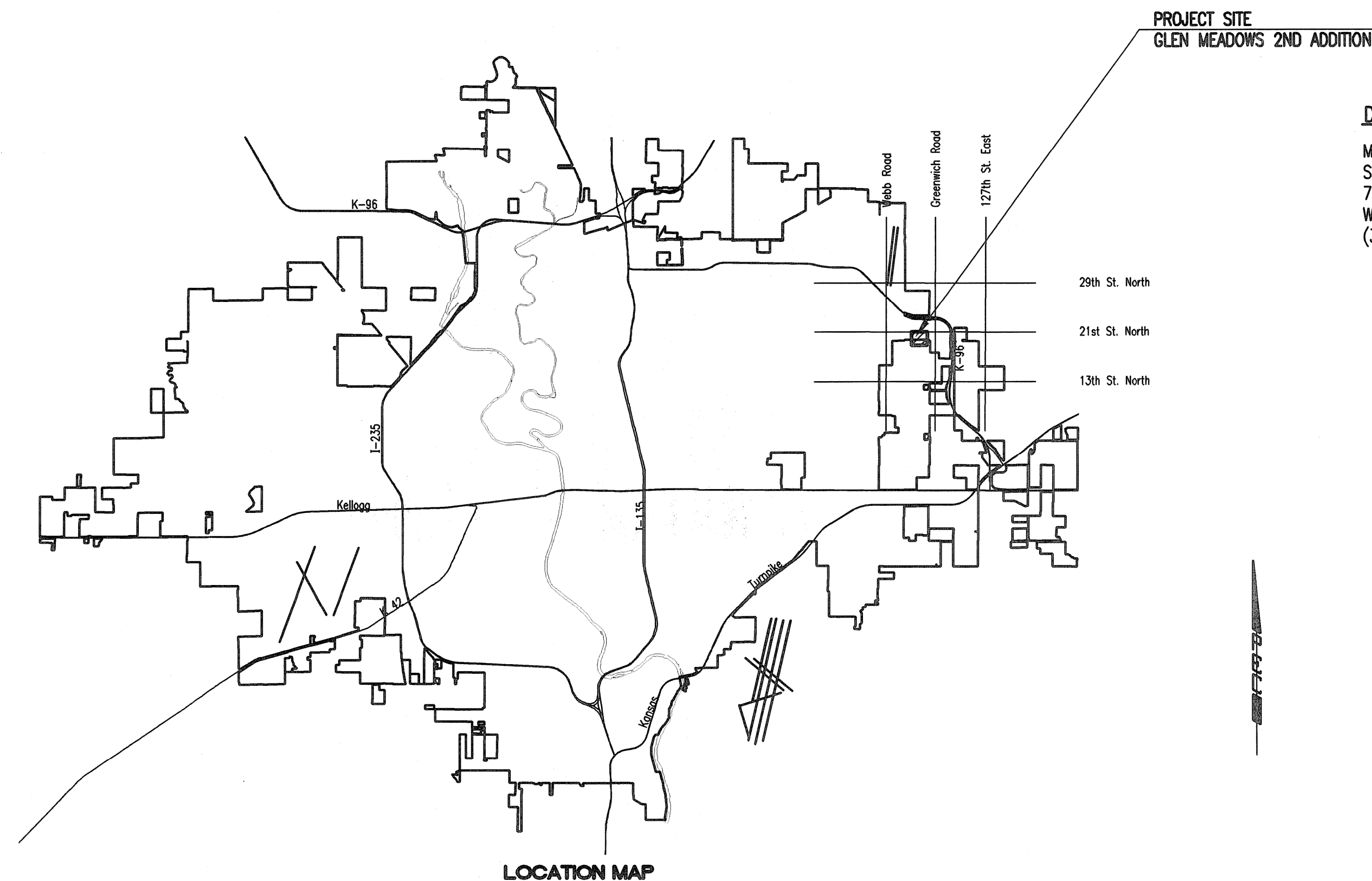

DEVELOPER CONTACT

MR. DAVID HAMBRICK
SLAWSON COMMERCIAL PROPERTIES
727 N. WACO, SUITE 400
WICHITA, KANSAS 67203
(316) 263-3201

INDEX OF SHEETS

SHEET NO. 1	TITLE SHEET
SHEET NO. 2	KEY MAP AND GENERAL NOTES
SHEET NO. 3	PLAT (GLEN MEADOWS 2ND ADDITION)
SHEET NO. 4	WATERLINE BUBBLE MAP
SHEET NO. 5	STANDARD WATER ASSEMBLY DETAILS
SHEET NO. 6	MISCELLANEOUS WATER DETAILS
SHEET NO. 7-9	PLAN/PROFILE
SHEET NO. 10-12	SOIL EROSION BMP'S

CONSTRUCTION SCHEDULE/COORDINATION

THE CONTRACTOR FOR THE FOLLOWING PROJECTS SHALL COORDINATE THEIR EFFORTS SUCH THAT ANY NECESSARY SIMULTANEOUS CONSTRUCTION (INCLUDING PRIVATE PAVING/GRADING IMPROVEMENTS) CAN PROCEED CONCURRENTLY WITHOUT CAUSING UNDUE DELAYS SO THAT CONSTRUCTION CAN BE COMPLETED WITHIN THE TIME FRAME AS NOTED.

THE CONTRACTOR SHALL COMPLETE THE FOLLOWING PUBLIC IMPROVEMENT PROJECTS BY APRIL 25, 2014 UNLESS OTHERWISE INDICATED IN THE PROJECT SPECIAL PROVISIONS.

468-84633 LATERAL 11, MAIN 16 of the FOUR MILE CREEK SEWER
448-90450 WATER DISTRIBUTION SYSTEM
468-84634 STORM WATER DRAIN #359

JANUARY 2014

PLANS PREPARED BY
PROFESSIONAL ENGINEERING CONSULTANTS, P.A.
ENGINEERS
WICHITA, KANSAS

