

BENCHMARK:
 BM #2 - Chiseled "□" on the Top of Curb at the West End of the Northwest Curb Return of 11th Street North and Estelle Avenue.
 Elevation = 1312.12 (NAVD 88)

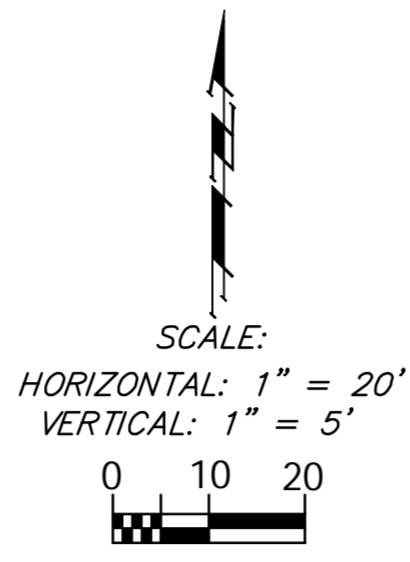
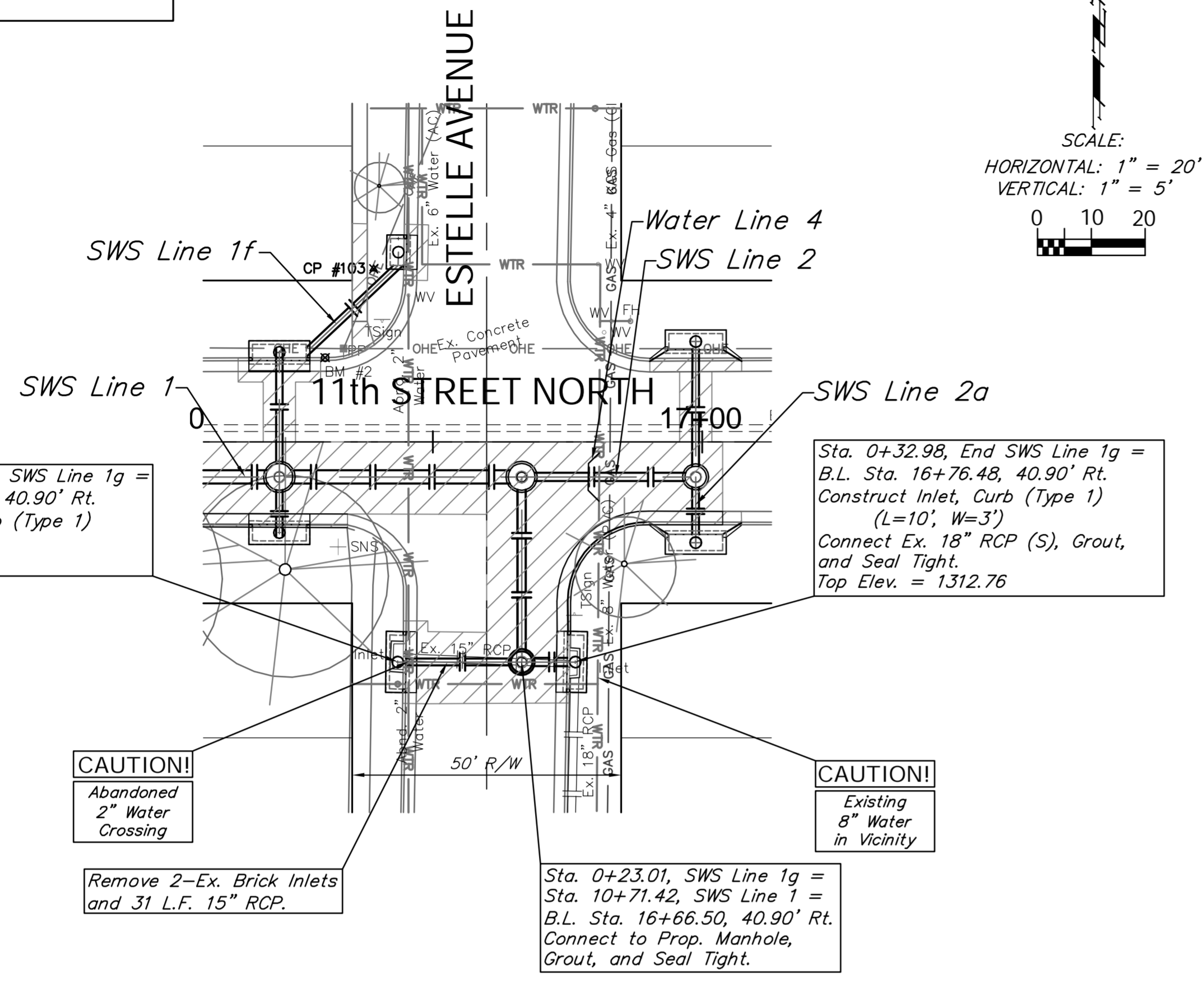

Sta. 0+00.00, Begin SWS Line 1g =
 B.L. Sta. 16+43.49, 40.90' Rt.
 Construct Inlet, Curb (Type 1)
 (L=10', W=3')
 Top Elev. = 1312.50

Sta. 0+32.98, End SWS Line 1g =
 B.L. Sta. 16+76.48, 40.90' Rt.
 Construct Inlet, Curb (Type 1)
 (L=10', W=3')
 Connect Ex. 18" RCP (S), Grout,
 and Seal Tight.
 Top Elev. = 1312.76

CAUTION!
 Abandoned
 2" Water
 Crossing

CAUTION!
 Existing
 8" Water
 in Vicinity

Remove 2-Ex. Brick Inlets
 and 31 L.F. 15" RCP.

Sta. 0+23.01, SWS Line 1g =
 Sta. 10+71.42, SWS Line 1 =
 B.L. Sta. 16+66.50, 40.90' Rt.
 Connect to Prop. Manhole,
 Grout, and Seal Tight.

SWS Line 1g

BENCHMARK:
 BM #2 - Chiseled "□" on the Top of Curb at the West End of the Northwest Curb Return of 11th Street North and Estelle Avenue.
 Elevation = 1312.12 (NAVD 88)

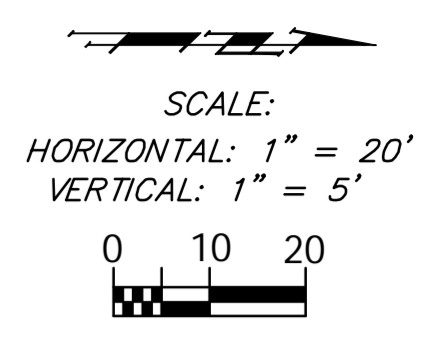
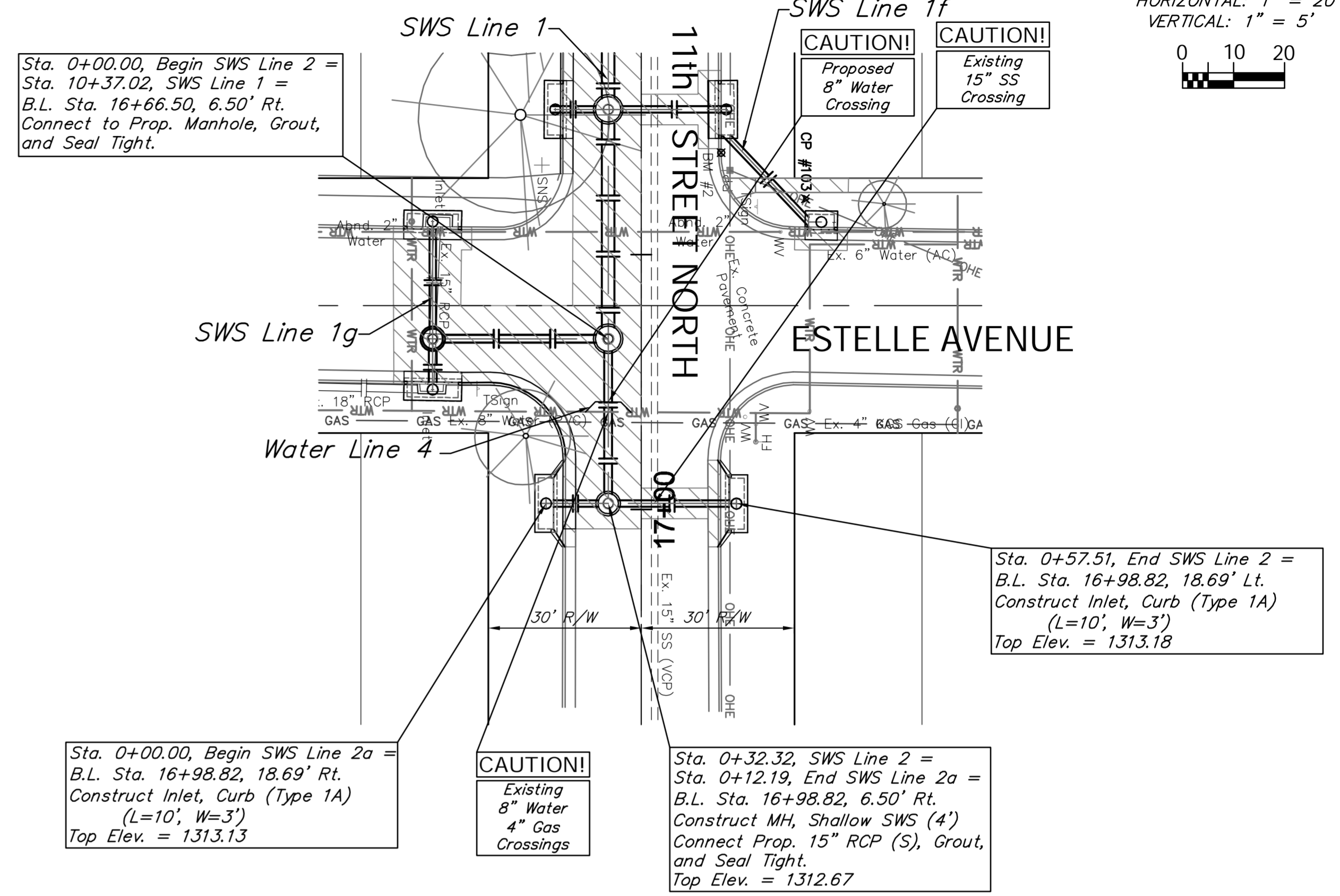

Sta. 0+00.00, Begin SWS Line 2 =
 Sta. 10+37.02, SWS Line 1 =
 B.L. Sta. 16+66.50, 6.50' Rt.
 Connect to Prop. Manhole, Grout,
 and Seal Tight.

Sta. 0+00.00, Begin SWS Line 2a =
 B.L. Sta. 16+98.82, 18.69' Rt.
 Construct Inlet, Curb (Type 1A)
 (L=10', W=3')
 Top Elev. = 1313.13

Sta. 0+32.32, SWS Line 2 =
 Sta. 0+12.19, End SWS Line 2a =
 B.L. Sta. 16+98.82, 6.50' Rt.
 Construct MH, Shallow SWS (4')
 Connect Prop. 15" RCP (S), Grout,
 and Seal Tight.
 Top Elev. = 1312.67

Sta. 0+57.51, End SWS Line 2 =
 B.L. Sta. 16+98.82, 18.69' Lt.
 Construct Inlet, Curb (Type 1A)
 (L=10', W=3')
 Top Elev. = 1313.18

CAUTION!
 Existing
 8" Water
 4" Gas
 Crossings

SWS Line 2 & Line 2a

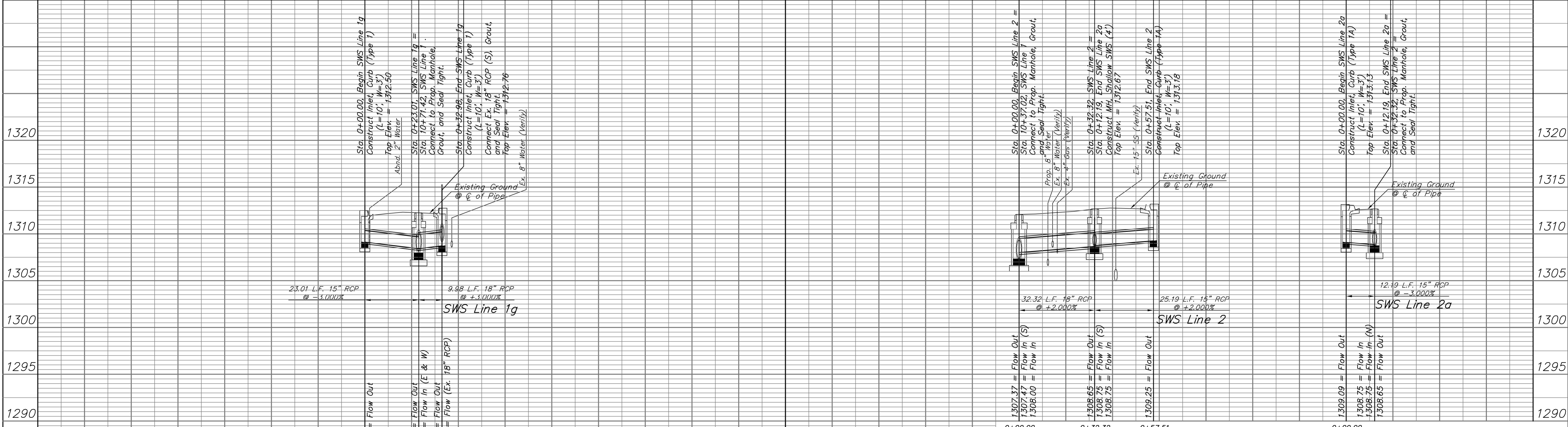

23.01 L.F. 15" RCP
 @ -3.000%

9.98 L.F. 18" RCP
 @ +3.000%

32.32 L.F. 18" RCP
 @ +2.000%

25.19 L.F. 15" RCP
 @ +2.000%

12.19 L.F. 15" RCP
 @ -3.000%