

**PHASE 1**  
 The Contractor can close the intersection of 11th and Grove to install the proposed SWS system and repave the intersection. Through traffic on Grove can be closed one block north and south of 11th and detoured one block east to Poplar. 11th Street North can also be closed to through traffic from one block west of Grove to one block east of Estelle and detoured north one block to 12th Street. North-south traffic crossing 11th Street on Poplar, Green, and Estelle shall remain open.

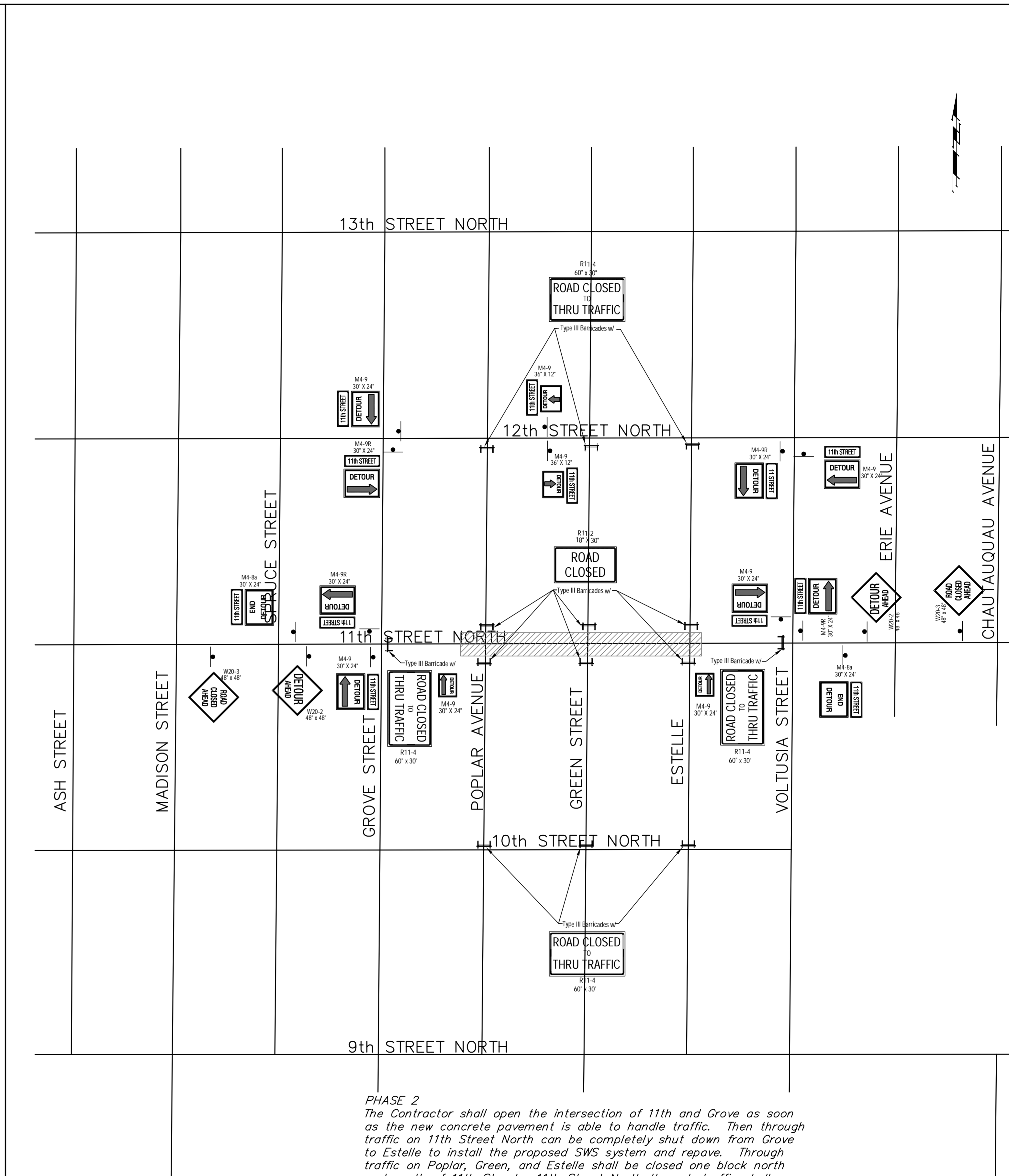

**PHASE 2**  
 The Contractor shall open the intersection of 11th and Grove as soon as the new concrete pavement is able to handle traffic. Then through traffic on 11th Street North can be completely shut down from Grove to Estelle to install the proposed SWS system and repave. Through traffic on Poplar, Green, and Estelle shall be closed one block north and south of 11th Street. 11th Street North through traffic shall continue on the detour on 12th Street.

Drawing File: E:\Projects\11th - Grove to Estelle 11-10-E681\Detour.dwg

Design: TPV  
 Drawn: TPV  
 Approved: TPV  
 Scale: None

Project No. 11-10E681 CAPITAL IMPROVEMENT PROJECT  
**11th STREET NORTH CONSTRUCTION**  
 SEQUENCING PLAN - Phase 1 & 2  
 11th STREET NORTH - GROVE TO ESTELLE DRAINAGE IMPROVEMENTS

**Baughman Company, P.A.**  
 315 Ellis St. Wichita, KS 67211 P 316-262-7271 F 316-262-0149  
 ENGINEERING | SURVEYING | PLANNING | LANDSCAPE ARCHITECTURE

April 2013  
 SHEET 19 OF 23