

EROSION CONTROL PLAN LEGEND
(Installation Details Found in the SWP2 Plan)

	- DROP INLET PROTECTION
	- CURB INLET PROTECTION
	- DITCH CHECKS
	- SILT FENCING
	- CUT-OFF TRENCH
	- BACK OF CURB PROTECTION
	- EROSION CONTROL MAT
	- TEMPORARY DITCH

NO SCALE

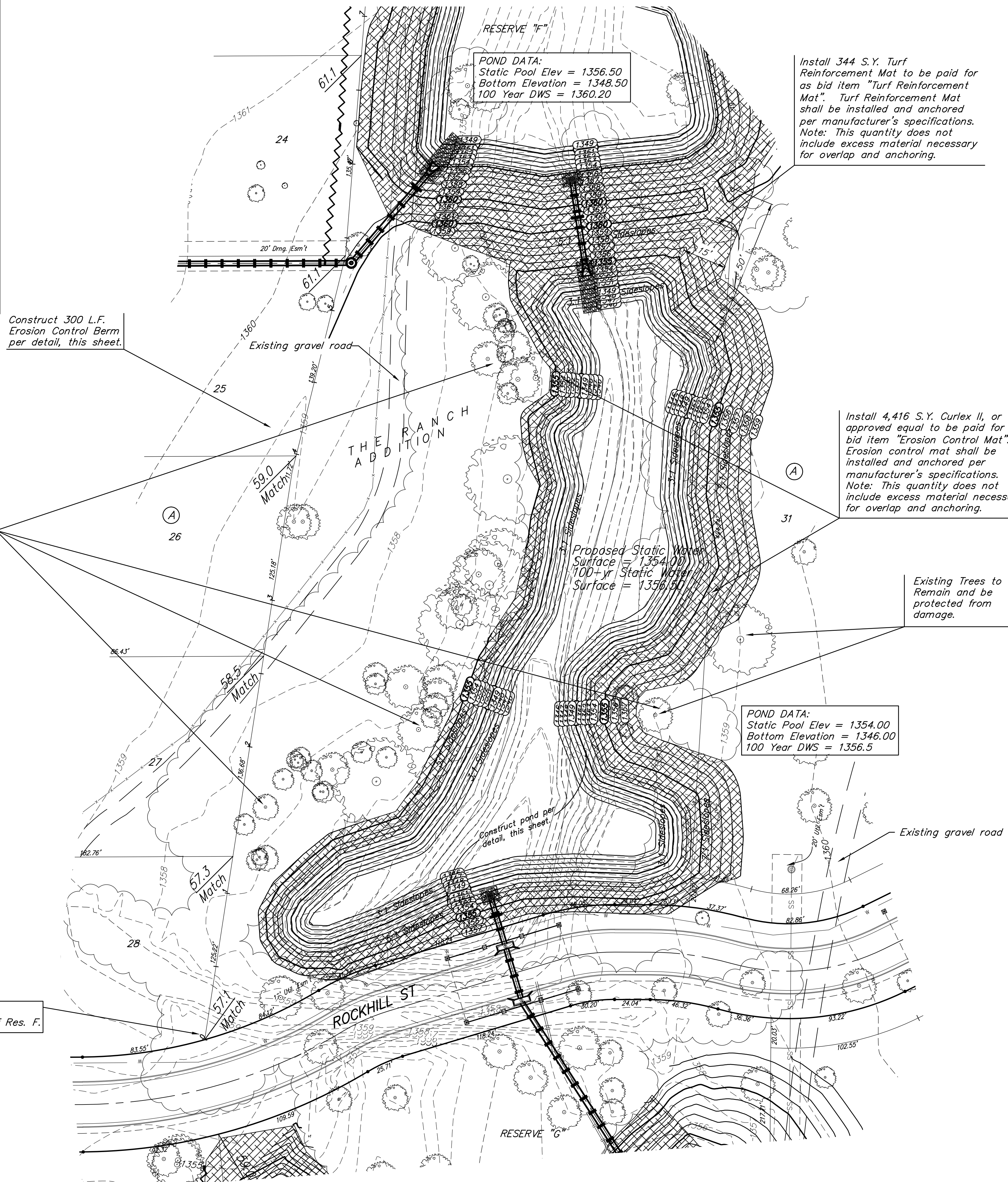

NOTES:

- Pond bottom and side slopes below static pool elevation shall be over-excavated 18" and a 12" clay liner shall be compacted to 95% std. density. The top 6" of the clay liner shall be modified with Wyoming Bentonite Clay at a rate of 4%. The plasticity index (P.I.) shall be at least 30. The compaction and P.I. shall be verified during construction. 6" of on-site material shall be distributed on top of the clay line below the static pool elevation. P.I. determination and compaction testing shall be arranged by the contractor at the request of the inspector. All costs for liner material, manipulation, compaction, testing, etc to be included in lump sum bid item, "Pond Sealing". All costs associated with Pond Construction including stripping top soil, excavation, shaping, compaction, hauling excess material, etc. shall be included in the bid item "Excavation".
- Excess earthwork, if any, shall be stockpiled at a location on-site as determined by the Engineer. Excess excavation may be used to build on-site berms at locations indicated by the Engineer.
- All areas disturbed by construction (except within street R/W) shall be seeded as indicated on Clearing Plan.
- Install Erosion Control Mat (Curlex II or approved equal) from 2' below the water surface to top bank. To be paid for as bid item "Erosion Control Mat".
- Contractor to strip top 4"-6" of soil within disturbed areas of Res. "F" & "G" and street reserves before mass grading and stockpile. Top soil stockpile to be redistributed over Reserve "F" & "G" above water elevation prior to seeding.

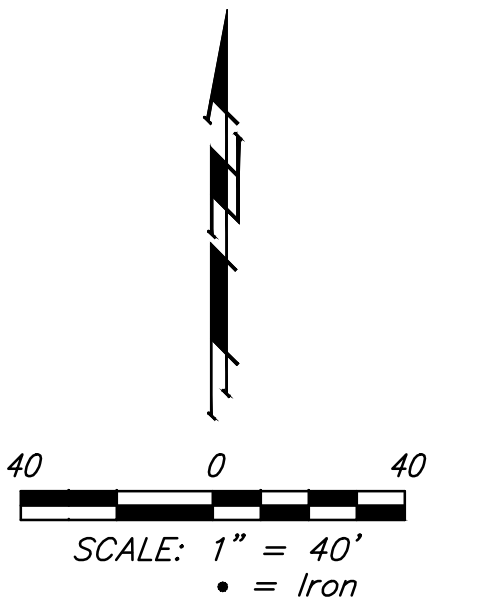

MIDDLE POND (Static = 1354.0)

STAGE	INFLOW	OUTFLOW	ELEVATION
2 yr	35 cfs	20 cfs	1354.6
10 yr	65 cfs	52 cfs	1355.1
100 yr	139 cfs	75 cfs	1356.5

MIDDLE POND

ELEVATION	AREA (sq ft)
1354	62300
1355	80000
1356	105900
1357	136100
1358	161500
1359	170000

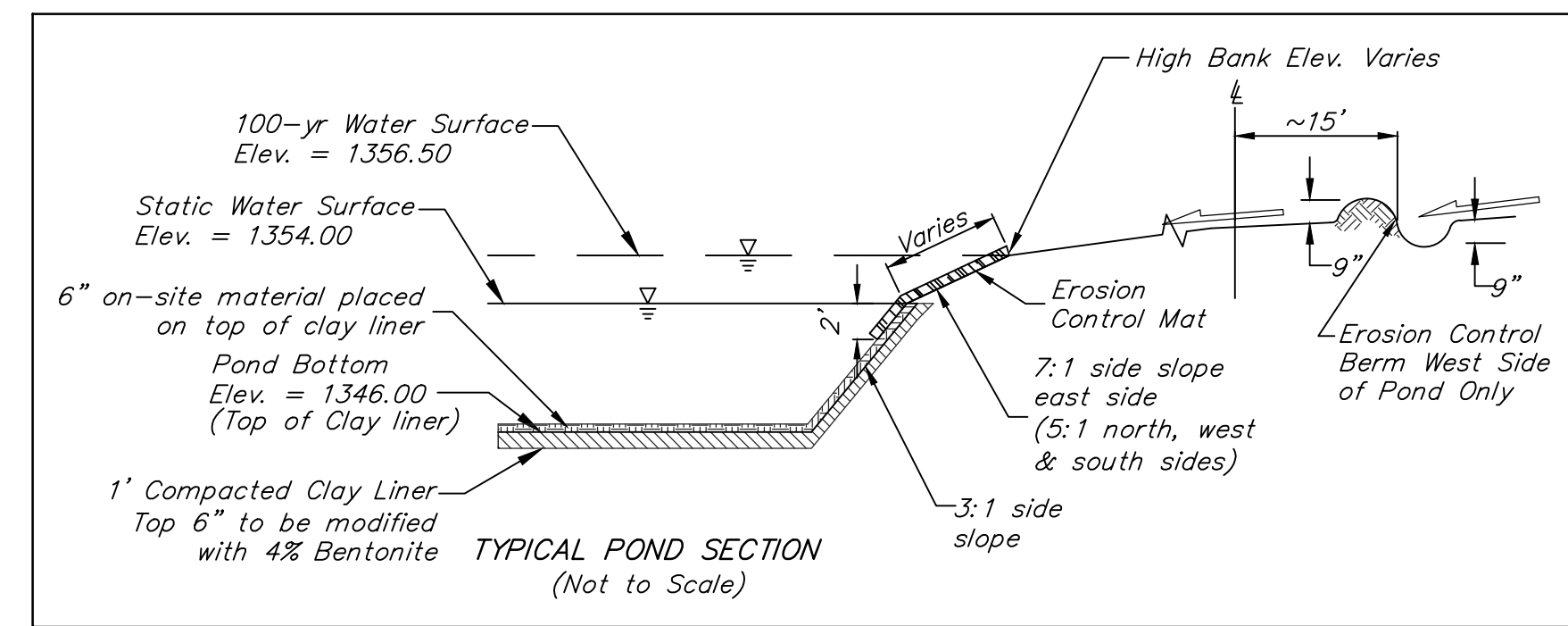

EARTH WORK TOTALS (Unadjusted, Pond "B" Only)

	C.Y. Excavation	C.Y. Fill
Pond Construction	12,860	1,410

Earthwork quantities do not include correction factors and are for reference only.

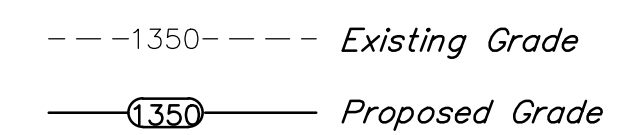

Baughman The Ranch Addition
POND PLAN "B"
STORM WATER DRAIN #391

Baughman Company, P.A. 315 Ellis St., Wichita, KS 67211 P 316-262-2771 F 316-262-0149
ENGINEERING | SURVEYING | PLANNING | LANDSCAPE ARCHITECTURE

PROJECT NUMBER: 468-84291
DESIGN: AEG
DRAWN: JAK/TMS

REVISIONS:

APPROVED: DATE: 01/14

SCALE: Noted
SHEET: 24 OF 40

E:\Projects\The Ranch_12080899\Engineering\SWD_1211E840\SWD PLANS.dwg 12-11-E840